



WINDOW TECHNOLOGY  
DOOR TECHNOLOGY  
AUTOMATIC ENTRANCE SYSTEMS  
BUILDING MANAGEMENT SYSTEMS



Door technology - Order catalog

GU Secury multi-point locks - manual locking systems

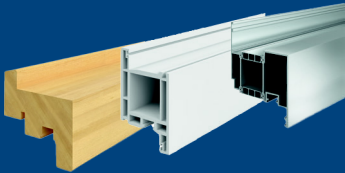

Edition 05/2026

Securing technology for you





## Contents

<b>GU Secury multi-point locks - manual locking systems .....</b>	<b>03.14.1</b>
<b>Table of Contents .....</b>	<b>03.13.3</b>
Contents 2	
<b>Secury Europa .....</b>	<b>03.13.4</b>
Mortise lock and additional lock dimensions	
<b>Secury Europa - S2 (Tripact) .....</b>	<b>03.13.5</b>
US cylinder	
<b>Secury Europa - S2 (Tripact) .....</b>	<b>03.13.6</b>
Euro-cylinder	
<b>Secury Europa - S2 w/btm shoot .....</b>	<b>03.13.7</b>
US cylinder	
<b>Secury Europa - S2 w/btm shoot .....</b>	<b>03.13.8</b>
Euro-cylinder	
<b>Secury Europa - S2 Radius end (1705mm) .....</b>	<b>03.13.9</b>
US cylinder	
<b>Secury Europa - S2 Radius end (1773mm) .....</b>	<b>03.13.10</b>
US cylinder	
<b>Secury Europa - SH2 (Rhino) .....</b>	<b>03.13.11</b>
US cylinder	
<b>Secury Europa - SH2 (Rhino) .....</b>	<b>03.13.12</b>
Euro-cylinder	
<b>Secury Europa - SH2 (2006mm length) .....</b>	<b>03.13.13</b>
US cylinder	
<b>Secury Europa - SH2 w/btm shoot .....</b>	<b>03.13.14</b>
US cylinder	
<b>Secury Europa - SH2 w/btm shoot .....</b>	<b>03.13.15</b>
Euro-cylinder	
<b>Secury Europa - Cremona .....</b>	<b>03.13.16</b>
US cylinder	
<b>Secury Europa - Cremona .....</b>	<b>03.13.17</b>
Euro-cylinder	
<b>Secury Europa - Cremona Inactive .....</b>	<b>03.13.18</b>
US cylinder	
<b>Secury Europa - Cremona Inactive .....</b>	<b>03.13.19</b>
Euro-cylinder	



## Contents

<b>GU Security multi-point locks - manual locking systems .....</b>	<b>03.14.1</b>
<b>Table of Contents .....</b>	<b>03.13.2</b>
Contents 1	
<b>Security Europa - R2 .....</b>	<b>03.13.20</b>
US cylinder	
<b>Security Europa - R2 .....</b>	<b>03.13.21</b>
Euro-cylinder	
<b>Security Europa - Inactive .....</b>	<b>03.13.22</b>
US cylinder	
<b>Security Europa - Inactive .....</b>	<b>03.13.23</b>
Euro-cylinder	
<b>Security Europa - 900mm Active .....</b>	<b>03.13.24</b>
US cylinder	
<b>Security Europa - 900mm Active .....</b>	<b>03.13.25</b>
Euro-cylinder	
<b>Security Europa - 900mm Inactive .....</b>	<b>03.13.26</b>
US cylinder	
<b>Security Europa - 900mm Inactive .....</b>	<b>03.13.27</b>
Euro-cylinder	
<b>Security Europa - Accessories .....</b>	<b>03.13.28</b>
Shoot Bolts	
<b>Security Europa - Accessories .....</b>	<b>03.13.29</b>
Extensions	
<b>Security Europa - Accessories .....</b>	<b>03.13.30</b>
Extensions - S2	
<b>Security Europa - Accessories .....</b>	<b>03.13.31</b>
Extensions - SH2 (Rhino)	



Europa case for US cyl.

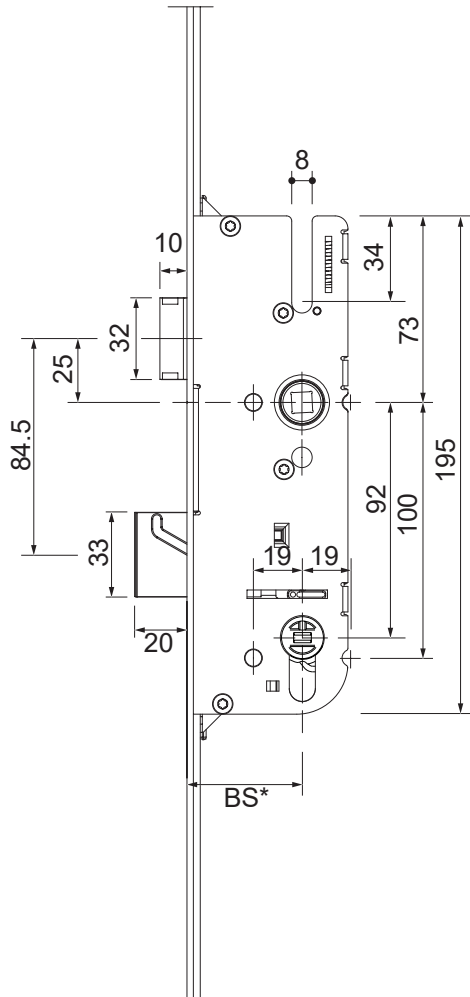

S2 (Tripect)

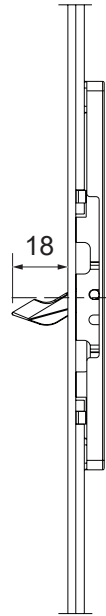

SH 2 (Rhino)

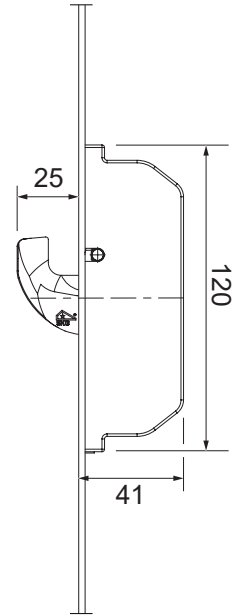

Roller cam



Shoot

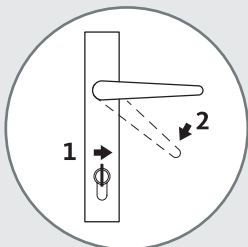
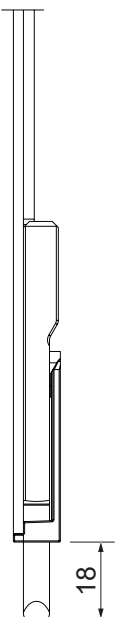

**Opening**  
 1. Release the door lock using key.  
 2. Depress lever to open the door.

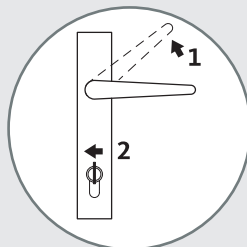

**Closing**  
 1. Lift the lever to extend lock points.  
 2. Lock door using the key.

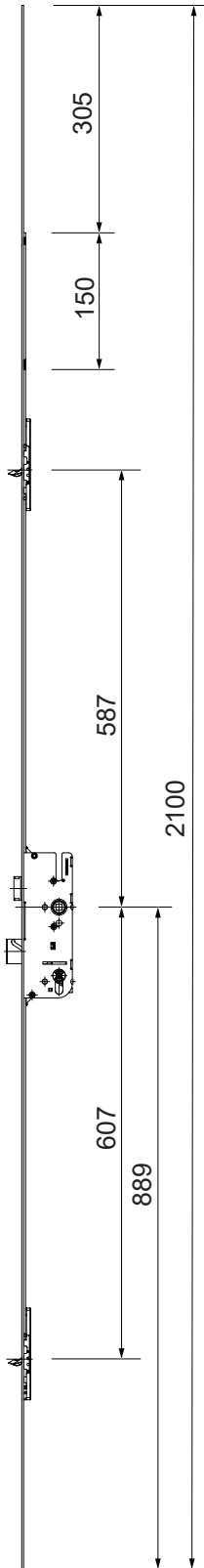
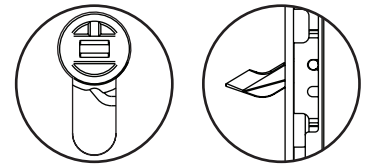

Silver FerGUard				
Backset	Faceplate	Spindle Hub	PU	Part Number
35	16	8	5	6-33290-02-0-1
40	16	8	5	6-UA290-40-0-1
45	16	8	5	6-UA290-45-0-1
50	16	8	5	6-33290-01-0-1
55	16	8	5	6-UA290-55-0-1
60	16	8	5	6-UA290-60-0-1

Black Finish				
Backset	Faceplate	Spindle Hub	PU	Part Number
35	16	8	5	6-33290-02-0-6
40	16	8	5	6-UA290-40-0-6
45	16	8	5	6-UA290-45-0-6
50	16	8	5	6-33290-01-0-6
55	16	8	5	6-UA290-55-0-6
60	16	8	5	6-UA290-60-0-6

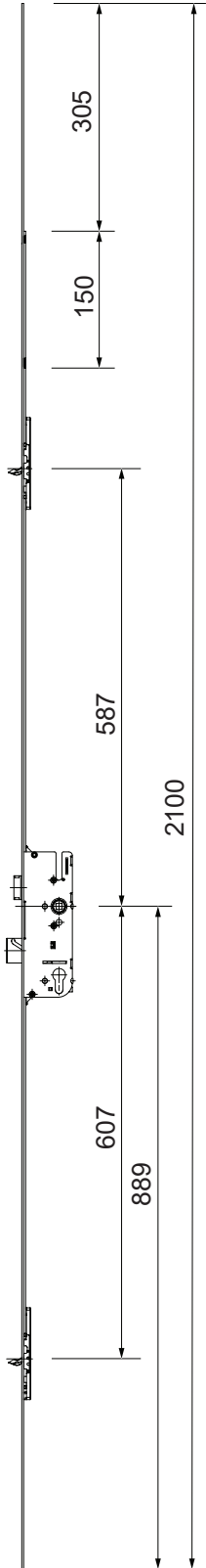
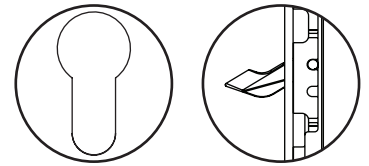

Silver FerGUard				
Backset	Faceplate	Spindle Hub	PU	Part Number
35	16	8	5	6-33364-01-0-1
40	16	8	5	6-UA290-40-1-1
45	16	8	5	6-UA290-45-1-1
50	16	8	5	6-33364-02-0-1
55	16	8	5	6-UA290-55-1-1
60	16	8	5	6-UA290-60-1-1

Black Finish				
Backset	Faceplate	Spindle Hub	PU	Part Number
35			5	6-UA290-35-1-6
40	16	8	5	6-UA290-40-1-6
45			5	
50	16	8	5	6-UA290-50-1-6
55	16	8	5	6-UA290-55-1-6
60	16	8	5	6-UA290-60-1-6

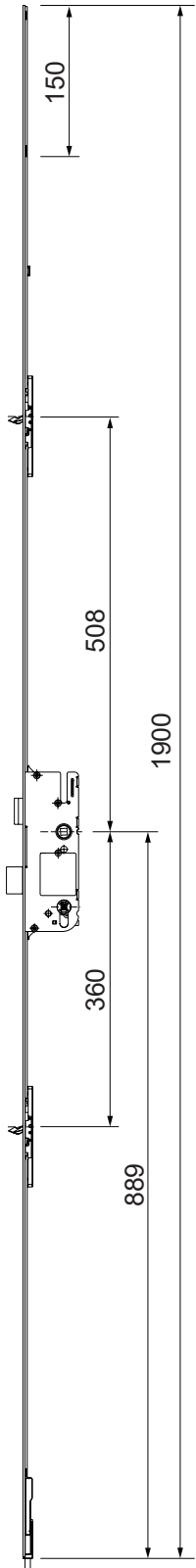
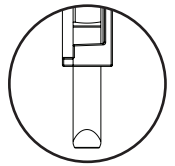
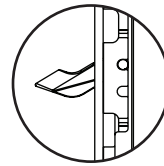
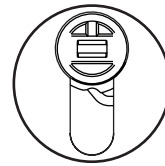

Backset	Faceplate	Spindle Hub	PU	Part Number
35	16	8	5	6-33238-01-0-1
40	16	8	5	6-UA238-40-0-1
45	16	8	5	6-UA238-45-0-1
50	16	8	5	6-33238-02-0-1
55	16	8	5	6-UA238-55-0-1
60			5	

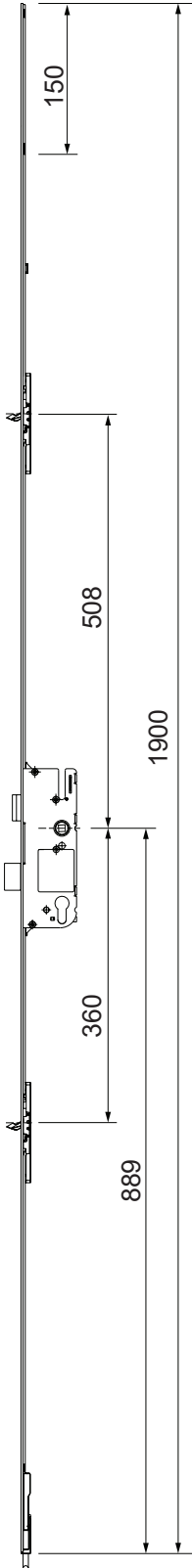
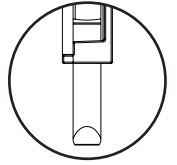
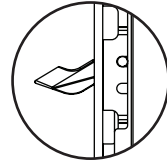
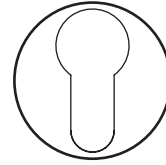

Backset	Faceplate	Spindle Hub	PU	Part Number
35	16	8	5	6-UA238-35-1-1
40			5	
45			5	
50	16	8	5	6-UA238-50-1-1
55	16	8	5	6-UA238-55-1-1
60			5	

# Secury Europa - S2 Radius end (1705mm)

US cylinder

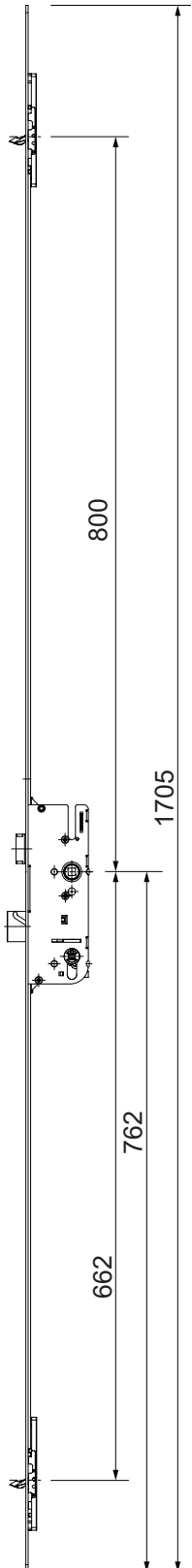
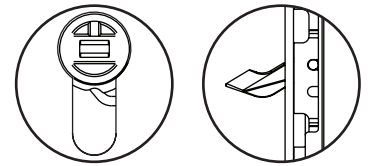

Backset	Faceplate	Spindle Hub	PU	Part Number
35			5	
40			5	
45			5	
50	16	8	5	6-33290-03-0-1
55			5	
60			5	

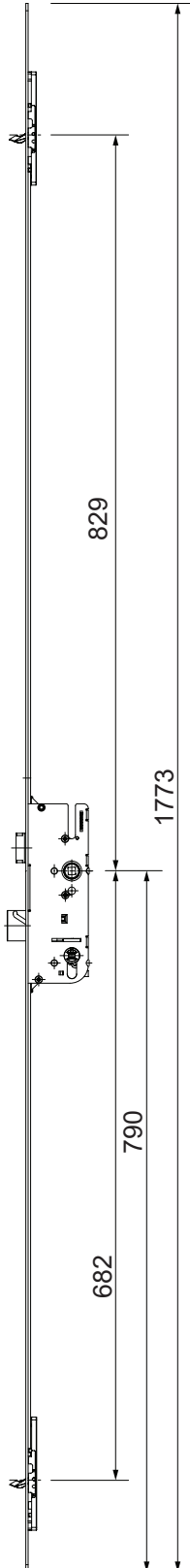
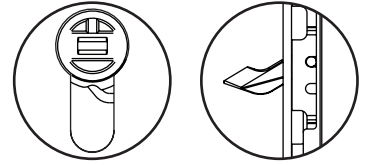

Backset	Faceplate	Spindle Hub	PU	Part Number
35	16	8	5	6-33292-02-0-1
40			5	
45	16	8	5	6-33292-01-0-1
50			5	
55			5	
60			5	

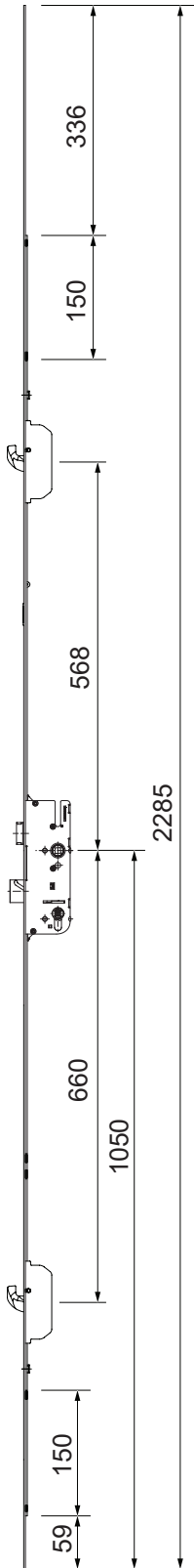
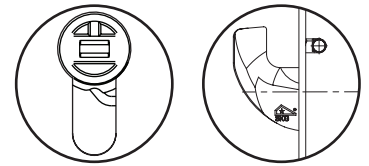

Backset	Faceplate	Spindle Hub	PU	Part Number
35	16	8	5	6-33400-01-0-1
40	16	8	5	6-UA400-40-0-1
45	16	8	5	6-UA400-45-0-1
50	16	8	5	6-UA400-50-0-1
55	16	8	5	6-UA400-55-0-1
60	16	8	5	6-UA400-60-0-1

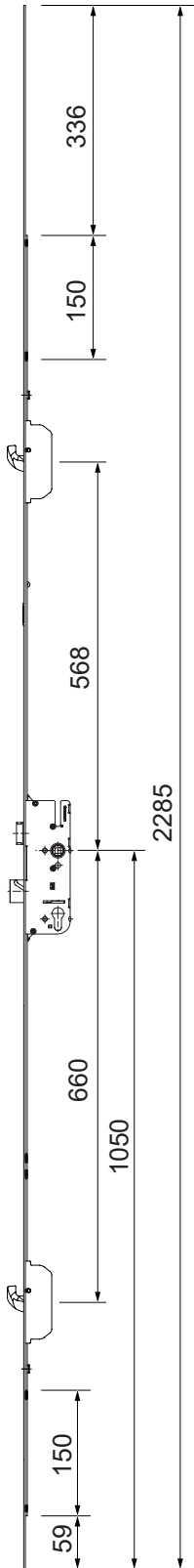
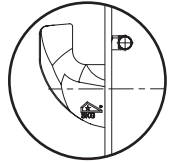
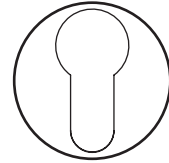

Backset	Faceplate	Spindle Hub	PU	Part Number
35	16	8	5	6-UA400-35-1-1
40			5	
45	16	8	5	6-UA400-45-1-1
50	16	8	5	6-UA400-50-1-1
55	16	8	5	6-UA400-55-1-1
60	16	8	5	6-UA400-60-1-1

# Secury Europa - SH2 (2006mm length)

US cylinder

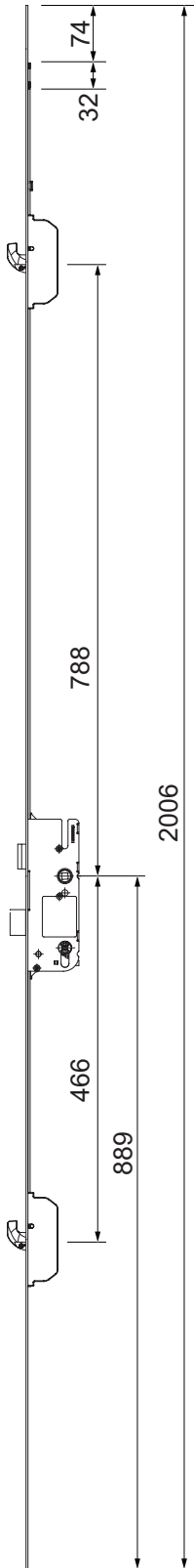
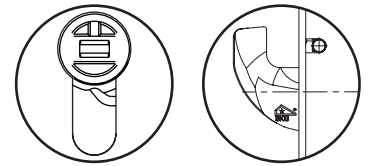

Backset	Faceplate	Spindle Hub	PU	Part Number
35	16	8	5	6-C4923-35-0-1
40	16	8	5	6-C4923-40-0-1
45	16	8	5	6-C4923-45-0-1
50	16	8	5	6-33440-01-0-1
55	16	8	5	6-C4923-55-0-1
60				

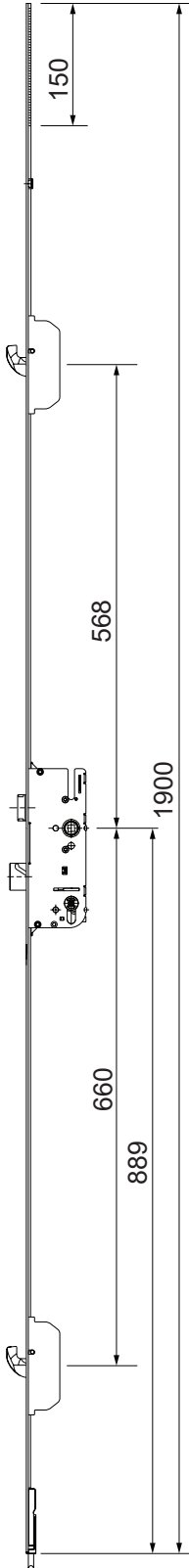
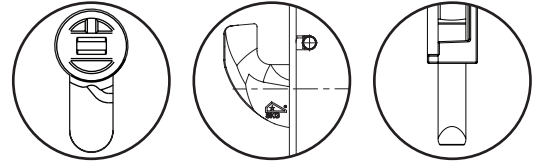

Stainless Steel				
Backset	Faceplate	Spindle Hub	PU	Part Number
35	16	8	5	6-33416-01-0-8
40	16	8	5	6-UA416-40-0-8
45	16	8	5	6-UA416-45-0-8
50	16	8	5	6-UA416-50-0-8
55	16	8	5	6-33416-02-0-8
60	16	8	5	6-UA416-60-0-8

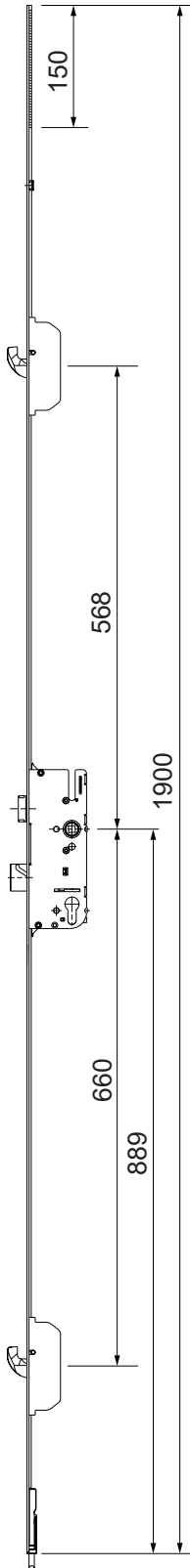
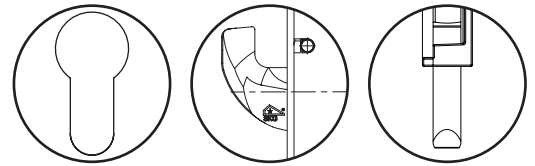

Stainless Steel				
Backset	Faceplate	Spindle Hub	PU	Part Number
35	16	8	5	6-UA416-35-1-8
40			5	
45			5	
50	16	8	5	6-UA416-50-1-8
55	16	8	5	6-UA416-55-1-8
60	16	8	5	6-UA416-60-1-8

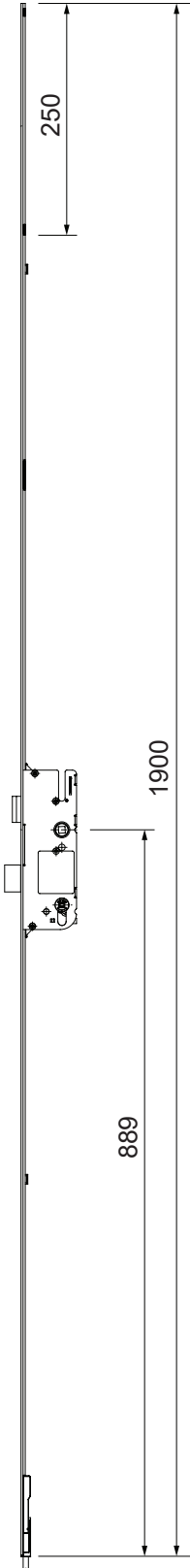
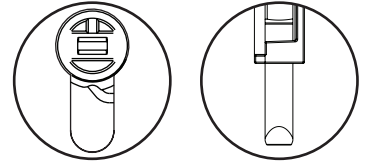

Silver FerGUard				
Backset	Faceplate	Spindle Hub	PU	Part Number
35	16	8	5	6-33244-01-0-1
40	16	8	5	6-UA244-40-0-1
45	16	8	5	6-UA244-45-0-1
50	16	8	5	6-33244-02-0-1
55	16	8	5	6-UA244-55-0-1
60	16	8	5	6-UA244-60-0-1

Black Finish				
Backset	Faceplate	Spindle Hub	PU	Part Number
35	16	8	5	6-33244-01-0-6
40	16	8	5	6-UA244-40-0-6
45	16	8	5	6-UA244-45-0-6
50	16	8	5	6-33244-02-0-6
55	16	8	5	6-UA244-55-0-6
60	16	8	5	6-UA244-60-0-6

Stainless Steel				
Backset	Faceplate	Spindle Hub	PU	Part Number
35	16	8	5	6-33244-01-0-8
40	16	8	5	6-UA244-40-0-8
45	16	8	5	6-UA244-45-0-8
50	16	8	5	6-33244-02-0-8
55	16	8	5	6-UA244-55-0-8
60	16	8	5	6-UA244-60-0-8

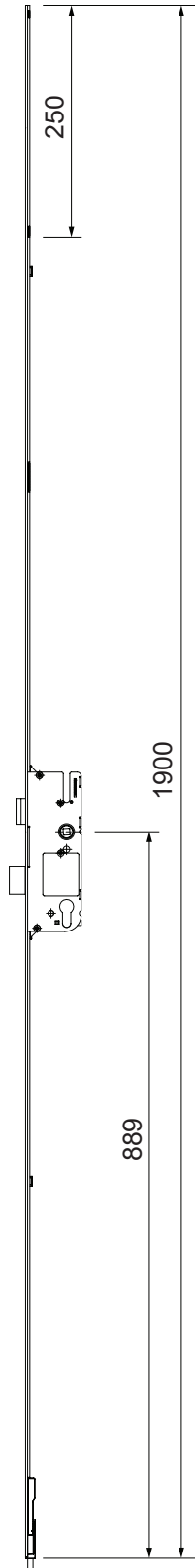
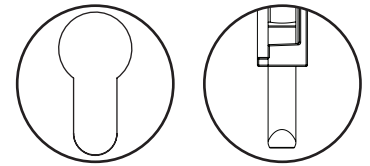

Silver FerGUard				
Backset	Faceplate	Spindle Hub	PU	Part Number
35	16	8	5	6-UA244-35-1-1
40	16	8	5	6-UA244-40-1-1
45	16	8	5	6-UA244-45-1-1
50	16	8	5	6-UA244-50-1-1
55	16	8	5	6-UA244-55-1-1
60	16	8	5	6-UA244-60-1-1

Black Finish				
Backset	Faceplate	Spindle Hub	PU	Part Number
35	16	8	5	6-UA244-35-1-6
40	16	8	5	6-UA244-40-1-6
45	16	8	5	6-UA244-45-1-6
50	16	8	5	6-UA244-50-1-6
55	16	8	5	6-UA244-55-1-6
60	16	8	5	6-UA244-60-1-6

Stainless Steel				
Backset	Faceplate	Spindle Hub	PU	Part Number
35	16	8	5	6-UA244-35-1-8
40			5	
45	16	8	5	6-UA244-45-1-8
50	16	8	5	6-UA244-50-1-8
55	16	8	5	6-UA244-55-1-8
60			5	

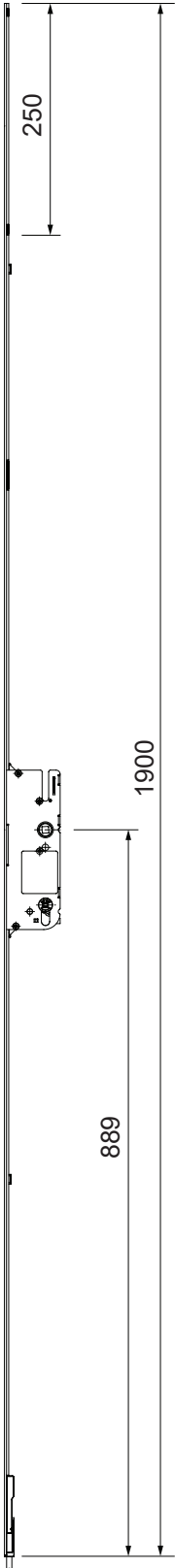
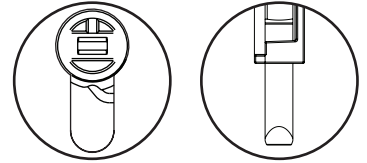

Silver FerGUard				
Backset	Faceplate	Spindle Hub	PU	Part Number
35	16	8	5	6-33270-01-0-1
40	16	8	5	6-UI270-40-0-1
45	16	8	5	6-UI270-45-0-1
50	16	8	5	6-33270-02-0-1
55	16	8	5	6-UI270-55-0-1
60	16	8	5	6-UI270-60-0-1

Stainless Steel				
Backset	Faceplate	Spindle Hub	PU	Part Number
35	16	8	5	6-UI270-35-0-8
40			5	
45	16	8	5	6-UI270-45-0-8
50	16	8	5	6-UI270-50-0-8
55	16	8	5	6-UI270-55-0-8
60	16	8	5	6-UI270-60-0-8

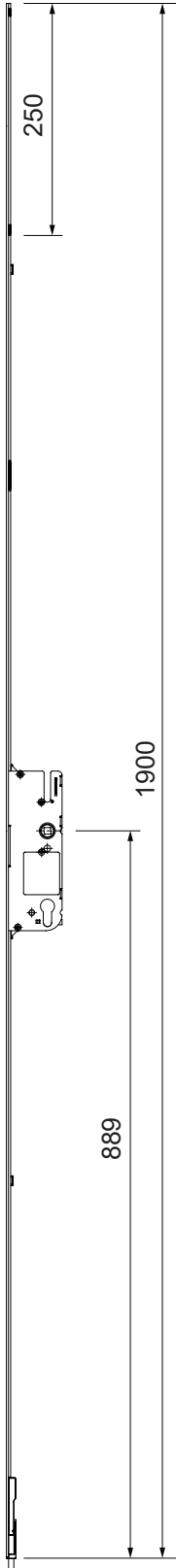
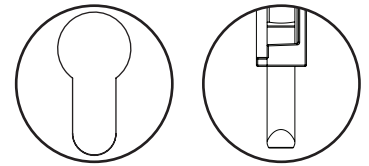

Silver FerGUard				
Backset	Faceplate	Spindle Hub	PU	Part Number
35	16	8	5	6-UI270-35-1-1
40	16	8	5	6-UI270-40-1-1
45	16	8	5	6-UI270-45-1-1
50	16	8	5	6-UI270-50-1-1
55	16	8	5	6-UI270-55-1-1
60			5	

Stainless Steel				
Backset	Faceplate	Spindle Hub	PU	Part Number
35			5	
40			5	
45			5	
50	16	8	5	6-UI270-50-1-8
55			5	
60			5	

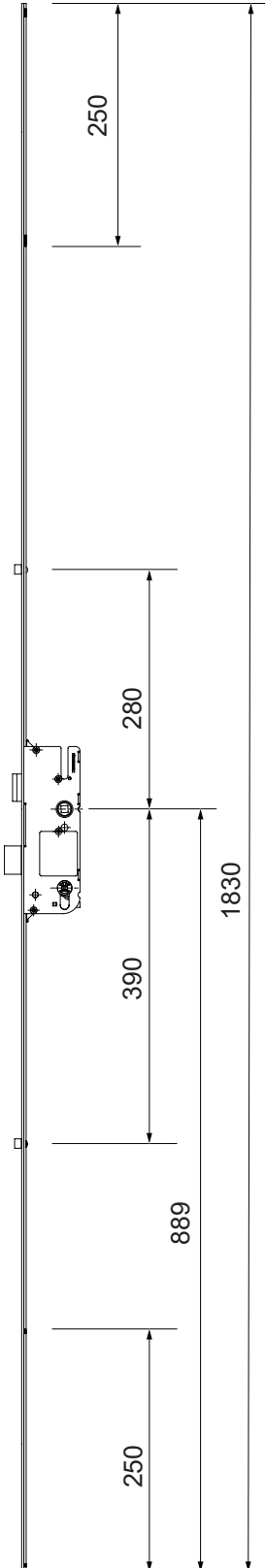
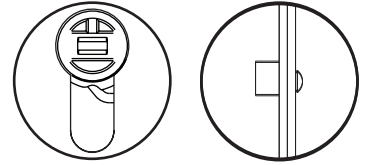

Backset	Faceplate	Spindle Hub	PU	Part Number
35	16	8	5	6-33632-01-0-1
40	16	8	5	6-UA632-40-0-1
45	16	8	5	6-UA632-45-0-1
50	16	8	5	6-UA632-50-0-1
55	16	8	5	6-UA632-55-0-1
60	16	8	5	6-UA632-60-0-1

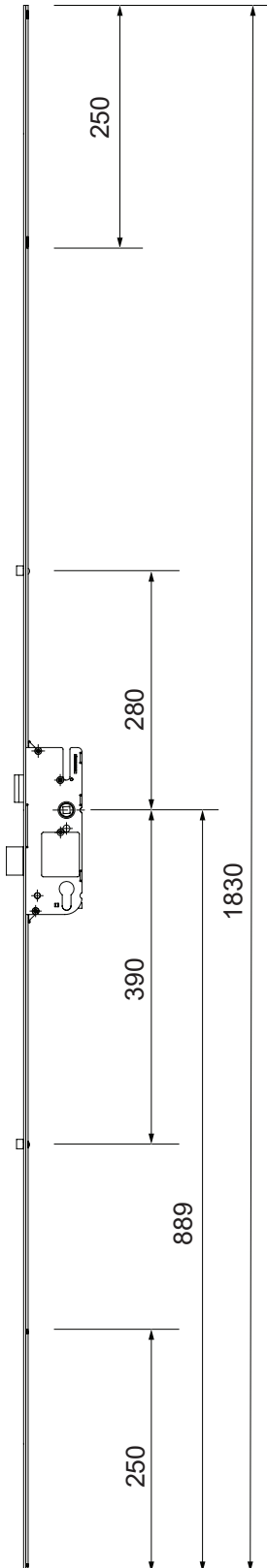
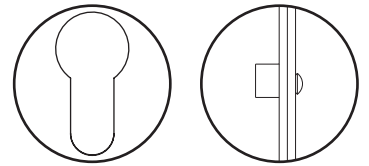

Backset	Faceplate	Spindle Hub	PU	Part Number
35	16	8	5	6-32686-01-0-1
40	16	8	5	6-UA686-40-1-1
45	16	8	5	6-UA686-45-1-1
50	16	8	5	6-UA686-50-1-1
55	16	8	5	6-UA686-55-1-1
60			5	

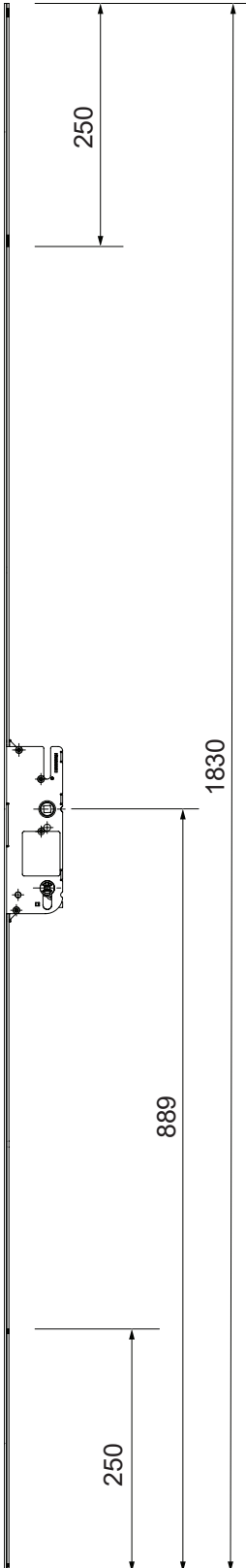
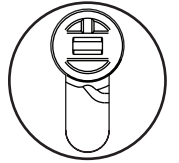

Backset	Faceplate	Spindle Hub	PU	Part Number
35	16	8	5	6-33638-01-0-1
40	16	8	5	6-U1638-40-0-1
45	16	8	5	6-U1638-45-0-1
50	16	8	5	6-U1638-50-0-1
55	16	8	5	6-U1638-55-0-1
60	16	8	5	6-U1638-60-0-1

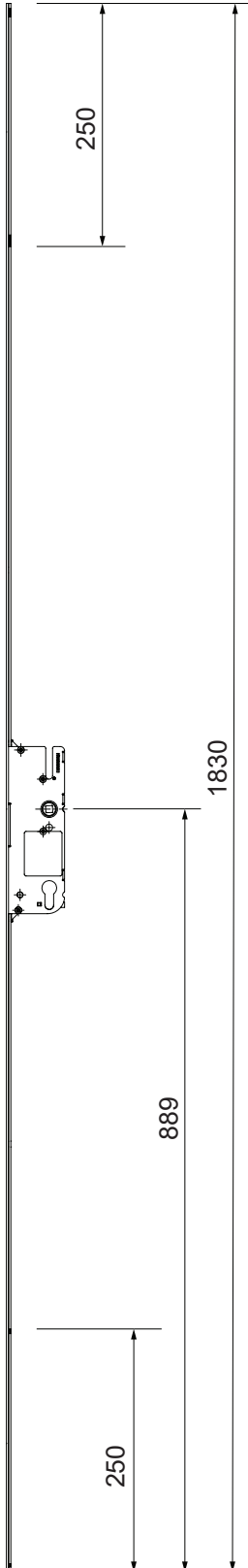
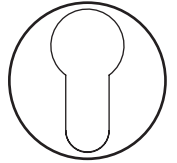

Silver FerGUard				
Backset	Faceplate	Spindle Hub	PU	Part Number
35	16	8	5	6-32570-01-0-1
40	16	8	5	6-UI570-40-1-1
45	16	8	5	6-UI570-45-1-1
50	16	8	5	6-UI570-50-1-1
55	16	8	5	6-UI570-55-1-1
60	16	8	5	6-UI570-60-1-1

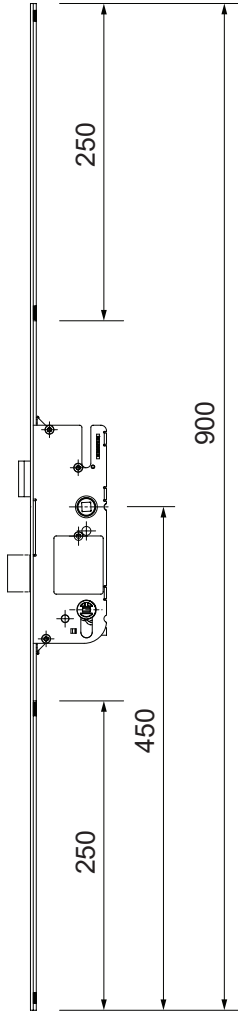
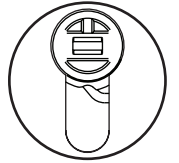

Stainless Steel				
Backset	Faceplate	Spindle Hub	PU	Part Number
35	16	8	5	6-C4903-35-0-8B
40	16	8	5	6-C4903-40-0-8B
45	16	8	5	6-C4903-45-0-8B
50	16	8	5	6-C4903-50-0-8B
55			5	
60			5	

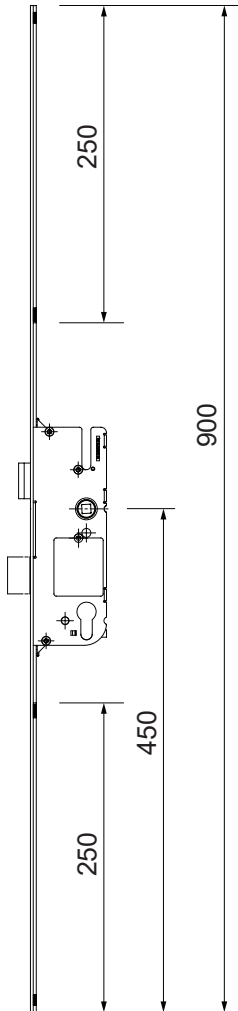
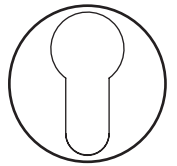

Stainless Steel				
Backset	Faceplate	Spindle Hub	PU	Part Number
35	16	8	5	6-C4901-35-0-8B
40	16	8	5	6-C4901-40-0-8B
45	16	8	5	6-C4901-45-0-8B
50	16	8	5	6-33480-01-0-8B
55	16	8	5	6-C4901-55-0-8B
60	16	8	5	6-C4901-60-0-8B

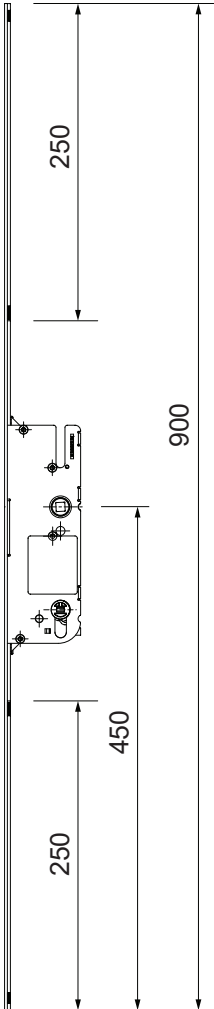

Stainless Steel				
Backset	Faceplate	Spindle Hub	PU	Part Number
35	16	8	5	6-C4902-35-0-8B
40			5	
45	16	8	5	6-C4902-45-0-8B
50	16	8	5	6-C4902-50-0-8B
55			5	
60			5	

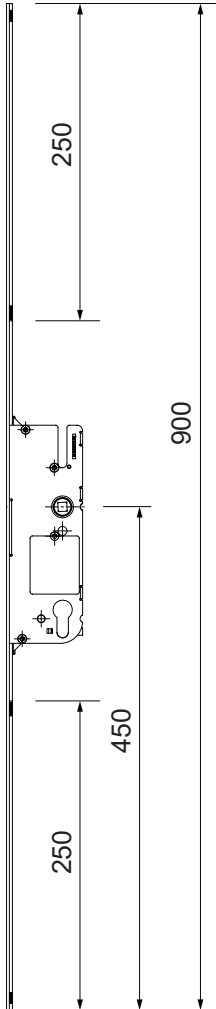
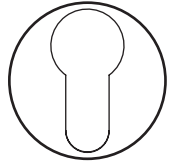

Stainless Steel				
Backset	Faceplate	Spindle Hub	PU	Part Number
35	16	8	5	6-C4900-35-0-8B
40	16	8	5	6-C4900-40-0-8B
45	16	8	5	6-C4900-45-0-8B
50	16	8	5	6-C4900-50-0-8B
55	16	8	5	6-C4900-55-0-8B
60	16	8	5	6-C4900-60-0-8B

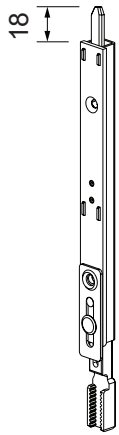

S1



S2

Top shoot / Reversing gear					
Item	Finish	Length	Faceplate	PU	Part Number
S1	FerGUard Silver	160	16	5	G-16798-00-0-1R
S1	Black, matte	160	16	5	G-16798-00-0-6N
S1	Stainless steel 430	160	16	5	G-16798-00-0-8
S2	FerGUard Silver	160	16	5	G-20416-00-0-1
S2	Stainless steel 430	160	16	5	G-20416-00-0-8
S2	Stainless steel 304	160	16	5	6-33085-00-0-8B



D1



D2

Bottom shoot / Direct drive					
Item	Finish	Length	Faceplate	PU	Part Number
D1	Stainless steel 430	160	16	5	G-20978-00-0-8
D2	Stainless steel 430	160	16	5	G-20415-00-0-8
D2	FerGUard Silver	160	16	5	G-20415-00-0-1

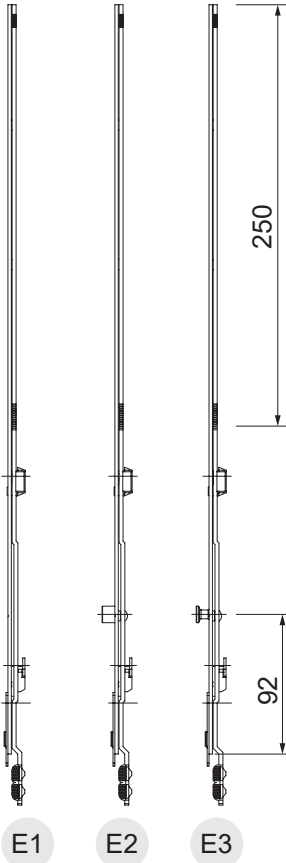

Extensions 500mm					
Item	Finish	Length	Faceplate	PU	Part Number
E1	FerGUard Silver	500	16	10	G-16790-05-0-1R
E1	Black, matte	500	16	10	G-16790-05-0-6N
E1	Stainless steel 430	500	16	10	G-16790-05-0-8
E1	Stainless steel 304	500	16	10	6-33973-01-0-8B
E2	FerGUard Silver	500	16	10	G-16790-06-0-1
E3	FerGUard Silver	500	16	10	6-32142-00-0-1
E3	Stainless steel 430	500	16	10	6-29858-01-0-8

Extensions 250mm					
Item	Finish	Length	Faceplate	PU	Part Number
E4	FerGUard Silver	250	16	10	8-00625-00-0-1
E4	Stainless steel 304	250	16	10	8-00625-00-0-9
E4	Stainless steel 304	250	16	10	6-33973-02-0-8B

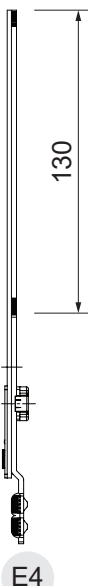

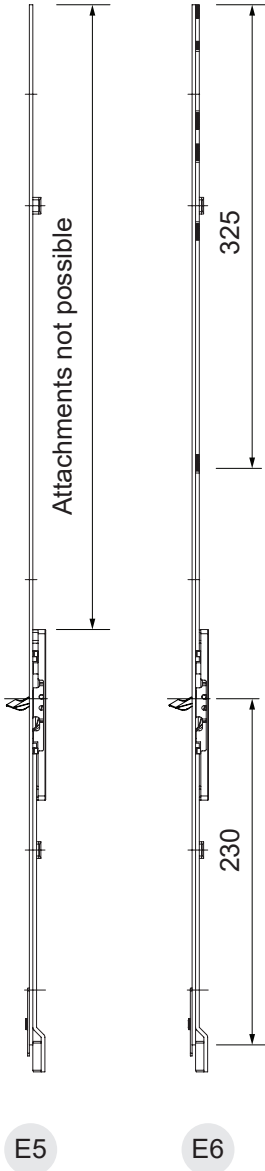

Extension S2 (Tripact)					
Item	Finish	Length	Faceplate	PU	Part Number
E5	FerGUard Silver	750	16	5	6-33279-05-0-1
E5	Stainless steel 304	750	16	5	6-33279-05-0-8B
E6	FerGUard Silver	750	16	5	6-33279-07-0-1
E6	Black, matte	750	16	5	6-33279-07-0-6

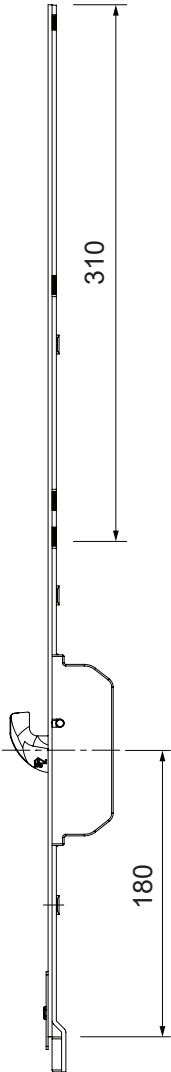

Extensions SH2 (Rhino)					
Item	Finish	Length	Faceplate	PU	Part Number
E7	FerGUard Silver	650	16	10	6-33930-02-0-1
E7	Stainless steel 430	650	16	10	6-33930-02-0-8

E7



WINDOW TECHNOLOGY  
DOOR TECHNOLOGY  
AUTOMATIC ENTRANCE SYSTEMS  
BUILDING MANAGEMENT SYSTEMS

Securing technology for you

