



WINDOW TECHNOLOGY
DOOR TECHNOLOGY
AUTOMATIC ENTRANCE SYSTEMS
BUILDING MANAGEMENT SYSTEMS



WINDOW TECHNOLOGY – ORDER CATALOG | SECTION 06.1



Tilt&Turn Hardware – UNI-JET D PVC



Securing technology for you





06.1

UNI-JET D PVC

DIRIGENT T&T Handle	06.1.5
LENTO T&T Handle	06.1.6
Tilt&Turn	06.1.7
Turn-Only Sash	06.1.12
Dummy-mullion Sash with ZH Lever-operated Gear	06.1.16
Drive-Gear Installation Dimensions	06.1.19
Jigs	06.1.20
Accessories	06.1.21

UNI-JET Hardware System

Product Information



Application

Applications for UNI-JET Tilt&Turn and Turn-Only hardware:

- One sash windows and balcony doors
- Double sash windows and balcony doors without mullion
- Lockable one sash balcony doors
- Lockable double sash balcony doors without mullion

UNI-JET locking systems with automatic locking cam

UNI-JET locking systems are concealed in the rebate and operated with a single handle. All components are designed for a 16.2mm wide and 2.5mm deep hardware groove.

Locking cams

The locking cams of drive gears, stays, centre locks and corner drives are adjustable with Torx 15 and supported with springs to compensate for clearances, the spring travel is 1.2mm. The Cleverle automatic cam compensates for clearances of between 8.5 and 15 mm in conjunction with the standard striker, simplifying installation and maintenance.

Snap-in and coupling connections

The drive gear and stay arm connections can be snapped into the centre locks. The connecting rods are coupled by means of double-sided teathed couplings, secured by means of overlapping gears. All croppable locking components are fixed in Turn-Only position (installation position), corner drives and centre locks feature 4 - leaf stainless steel springs.

The UNI-JET locking standard is "basic security"

The standard version of UNI-JET locking systems is "basic security". A Sec mushroom cam striker of steel is mounted horizontally at the bottom near the drive gear side in order to provide enhanced anti-jemmy security in this vulnerable area; this applies to all opening methods.

Abbreviations

HH	Handle height
VHH	Variable handle height
LC	Locking cam
PC	Profile cylinder
Sec	Security hardware
SRH	Sash rebate height
SRW	Sash rebate width
ST	Sash thickness
T&T	Tilt&Turn
T-F	Tilt-First

Hinge side versions

UNI-JET D

Tilt&Turn and Turn-Only hardware systems for windows with sash overlap

Rebate hinge fittings with drill-in hinge or rebate corner hinge and rebate double stay for windows and balcony doors with 12mm clearance up to 130kg sash weight.

Rebate corner hinge, Turn-Only hinge, centre closure and double stays designed for 9 and 13mm axis and 18, 20 or 22mm sash overlap. 3-way adjustable pivot rest, symmetric drill pattern for stay bearings and pivot rest.

Strikers, packers

The strikers and packers for different frame profiles must be selected according to table.

Drilling jigs, templates

Drilling jigs and templates required for hardware installation are specified in the installation drawings.

DIRIGENT turn handles

The attachment of the aluminum turn handles is concealed. The handle rosettes are provided with a sturdy detent mechanism and fixed lugs. Lockable handles and service handles complete the turn handle range.

Standard surface sealing of Tilt&Turn hardware: ferGUard silver

The hardware components are made of high quality steel, zinc die cast and aluminum alloys. All locking components of Tilt&Turn hardware come with ferGUard silver surface sealing.

Application Diagram UNI-JET D

Turn-Only / Tilt&Turn Sash – Drawing No. 0-45558



Infill weight

14.3 lb/ft ²	12.3 lb/ft ²	10.2 lb/ft ²	8.2 lb/ft ²	6.1 lb/ft ²	5.5 lb/ft ²
70 kg/m ²	60 kg/m ²	50 kg/m ²	40 kg/m ²	30 kg/m ²	27 kg/m ²

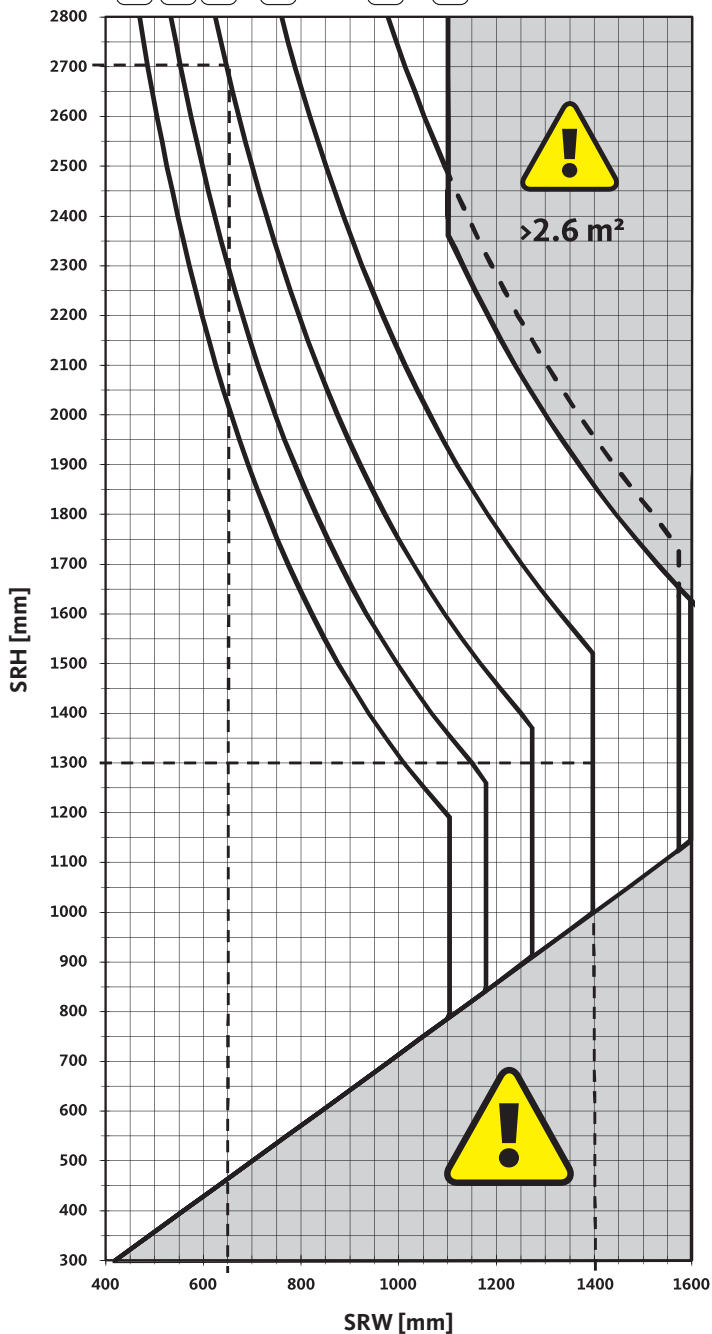

Application diagram

- Verifications regarding the attachment of load-bearing components to the window system by the window fabricator according to TBDK with the following forces:
 - 2710 N at the stay-bearing
 - 2890 N at the pivot-rest
- Glass reduction GR ≥ 28 mm
- Profile weight PW ≤ 3.25 kg/m

Attention

The maximum sash weight of 100 kg is only permitted in certain areas of the application diagram.

Only sash formats to the left of the respective glass weight graph are permissible.

■ Format not permitted in the grey area.

Reading examples

- Infill weight = 50 kg/m²
With SRW = 650 mm, the SRH max. = 2700 mm, which corresponds to a maximum sash weight of 88 kg.
- Infill weight = 40 kg/m²
With an SRW = 1400 mm, the max. SRH = 1300 mm, which corresponds to a maximum sash weight of 73 kg.

This application diagram is only valid in conjunction with the corresponding installation drawings 0-46603-DD.

For notes on intended use, see 0-46789.

Test and calculation basis

- Tilt&Turn test according to QM 328 or RAL GZ 607/3 Appendix 2:
 - 15,000 Tilt&Turn cycles
 - 10,000 Turn-Only cycles
- Test format:
 - SRW 1300 x SRH 1200 : 100 kg

DIRIGENT

Tilt&Turn Handle



DIRIGENT Handle

Description	PU	Part Number
Sash Thickness 60mm		
Handle with 7 x 33mm spindle	20	6-28072-33-0-*
M5 x 40mm screws (two required)	100	9-C5129-40-0-1
Sash Thickness 70mm		
Handle with 7 x 38mm spindle	20	6-28072-38-0-*
M5 x 50mm screws (two required)	100	9-C5129-50-0-1
PU = Packaging Unit, * = Color		
11 = Silver, 5 = Dark Brown, 6 = Black, 7 = White		



Additional information

- Made of zinc die cast and aluminum
- Available in different painted and powder coated finishes
- Installation screws are not included

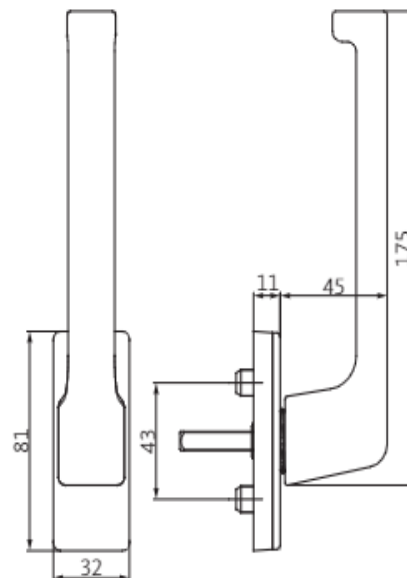

LENTO

Tilt&Turn Handle

**LENTO Handle**

Description	PU	Part Number
Handle with 7 x 40mm spindle	20	G-25676-40-0-*
* = Color		PU = Packaging Unit
C = Titanium, 7 = White, 6V = Flat Black		

**Additional information**

- Made of zinc die cast and aluminum
- Available in different painted and powder coated finishes
- Adjustable spindle from 10mm to 40mm
- Screws are included

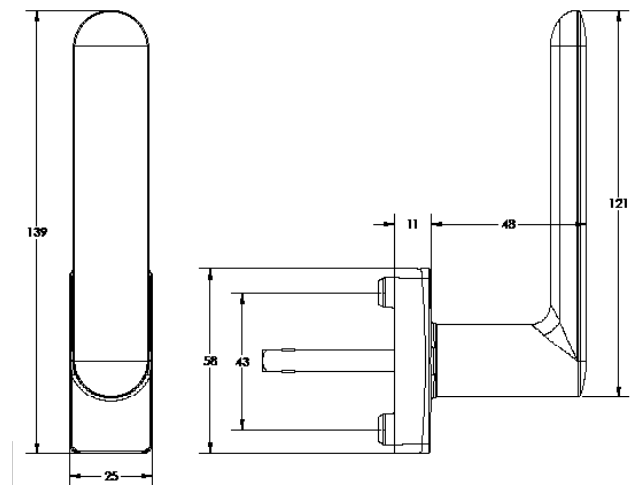

UNI-JET D Central Locking System

Tilt&Turn – Variable Handle Height

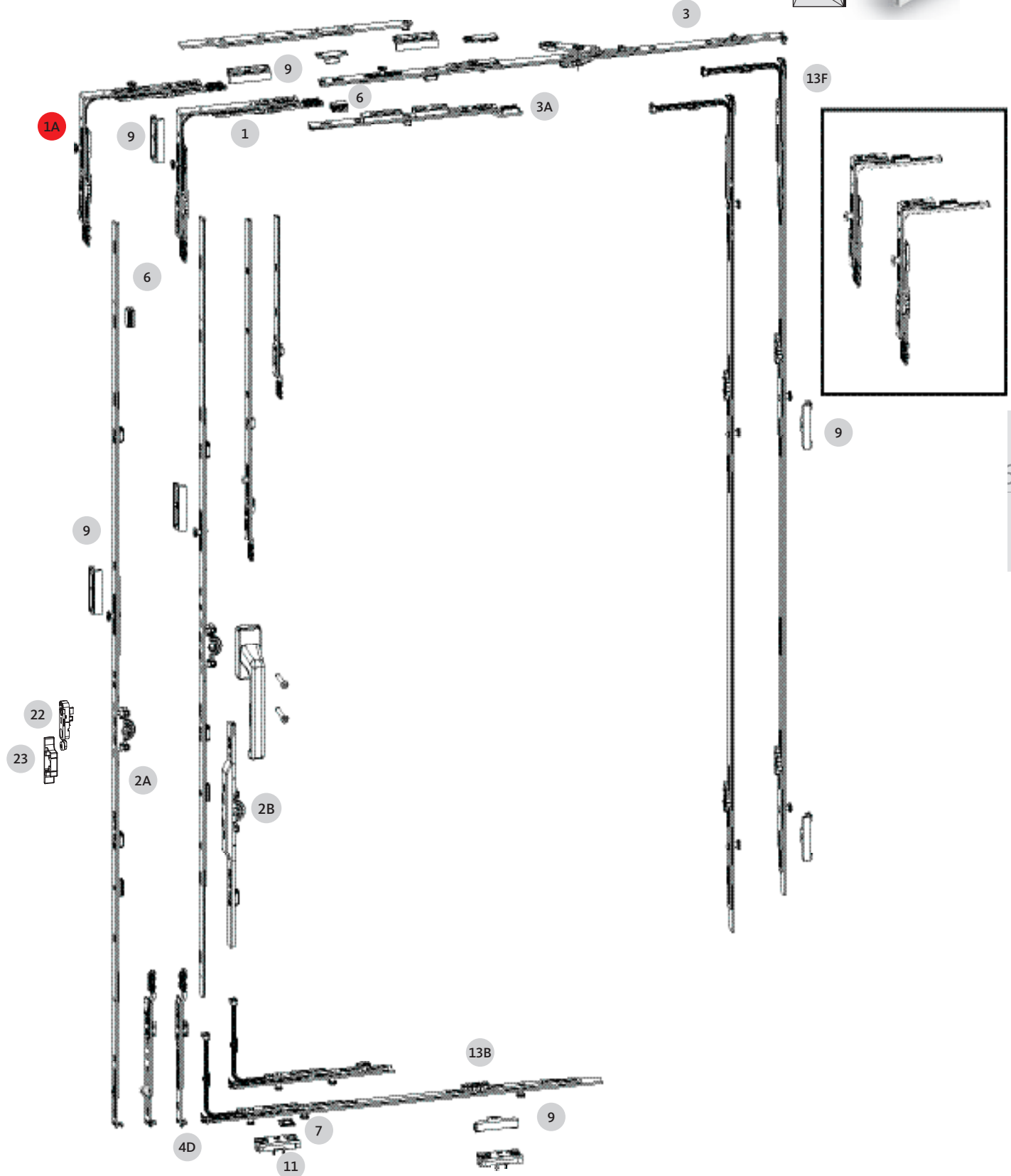

UNI-JET D Central Locking System

Tilt&Turn – Variable Handle Height



Standard Corner Transmission – Top

Item	SRW	SRH	LC	PU	Part Number
1	400-1600	391-2800	1	10	6-32021-00-0-1
	280-400	480-590	1	10	6-32224-00-0-1
	280-400	445-555	1	10	6-32238-00-0-1

Se Corner Transmission – Top (Optional)

Item	SRW	SRH	LC	PU	Part Number
1A	400-1600	391-2800	2	10	6-31753-00-0-1

T&T Gear 15 Backset – Variable Handle Height

Item	SRH	Length	G	LC	PU	Part Number
2A	350-450 [1]	363	155	-	10	G-22120-00-0-1
	480-590	270	240-295	-	10	G-22080-00-0-1
	591-750	430	295-375	-	10	G-22081-00-0-1
	751-1200	880	375-600	1	10	G-22082-00-0-1
	951-1450	1130	457-725	1	10	G-22083-00-0-1
	1201-1700	1380	600-850	2	10	G-22084-00-0-1
	1451-1950	1630	725-975	2	10	G-22085-00-0-1
	1951-2500	2130	975-1225	3	10	G-22086-00-0-1

[1] Optional fixed

T&T Gear 7.5 Backset – Variable Handle Height

Item	SRH	Length	G	LC	PU	Part Number
2B	325-439	390	155	-	10	G-22141-00-0-1 [2]
	385-475	270	250-295	-	10	G-22100-00-0-1 [2]
	591-750	430	295-375	-	10	G-22101-00-0-1
	751-1200	880	375-600	1	10	G-22102-00-0-1
	951-1450	1130	475-725	1	10	G-22103-00-0-1
	1201-1700	1380	600-850	2	10	G-22104-00-0-1
	1451-1950	1630	725-975	2	10	G-22105-00-0-1
	1951-2450	2130	975-1225	3	10	G-22106-00-0-1
	2451-2700	2130	1225	3	10	G-22106-00-0-1
	2701-2800	2130	1225	3	10	G-22106-00-0-1

[2] For SRH < 440, corner-drive S 6-32238-00-0-1 must be used (leg lengths 45/125)

[2] For SRH < 500, corner-drive S 6-32238-00-0-1 or SLK 6-32224-00-0-1 must be used

Additional Stay for Tilt&Turn [3] [4]

Item	SRW	Length	LC	PU	Part Number
3A	1301-1450	250	-	10	6-39731-00-0-1

[3] To be used with 6-31512-10-0-1

[4] Some profiles may require profile specific packers

Stay-guide

Item	SRW	Length	LC	PU	Part Number
3	280-400 [2]	350	-	10	6-31512-03-0-1
	401-500	350	-	10	6-31512-03-0-1
	501-750	590	-	10	6-31512-06-0-1
	751-1000	840	1	10	6-31512-08-0-1
	951-1200	1040	1	10	6-31512-10-0-1
	1201-1300	1290	1	10	6-31512-12-0-1

Standard Gear Connector 180° – Bottom

Item	SRH	Length	LC	PU	Part Number
4D	480-2800	160	-	10	6-32303-00-0-1

Se Gear Connector 180° – Bottom (Optional)

Item	SRH	Length	LC	PU	Part Number
4E	480-2800	160	1	10	6-33205-00-0-1

Centre-lock – Hinge Side

Item	SRH	Length	LC	PU	Part Number
13F	721-1100	530	1	10	6-32075-05-0-1
	1101-1350	740	1	10	6-32075-07-0-1
	1351-1700	1190	2	10	6-32075-12-0-1
	1701-2100	1450	2	10	6-32075-15-0-1
	2101-2500	1890	3	10	6-32075-19-0-1

Se Centre-lock – Hinge Side (Optional)

Item	SRH	Length	LC	PU	Part Number
13G	451-720	330	2	10	6-32008-03-0-1
	721-1100	530	2	10	6-32008-05-0-1
	721-1350	740	2	10	6-32008-07-0-1
	1351-1700	1190	3	10	6-32008-12-0-1
	1701-2100	1450	3	10	6-32008-15-0-1
	2101-2500	1890	4	10	6-32008-19-0-1

T&T Centre-lock – Bottom Horizontal

Item	SRW	Length	LC	PU	Part Number
13B	280-750	215	1	10	6-32012-00-0-1
13A	751-950	530	2	10	6-32076-05-0-1
	951-1200	740	2	10	6-32076-07-0-1
	1201-1600	1050	3	10	6-32076-10-0-1

UNI-JET D Central Locking System

Tilt&Turn – Variable Handle Height

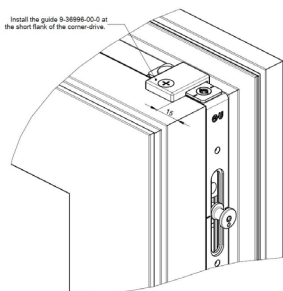

- [1] SRH 280–390 only possible in conjunction with corner-drive S 6-32238 or corner-drive SLK 6-32224 and anti-slam device 9-38688-33. Installation according to drawing 0-45986.
- [2] SRW 280–400 only possible in conjunction with corner-drive S 6-32238 or corner-drive SLK 6-32224. Installation according to drawing 0-45986.
- [3] An additional stay must be used for the following application ranges
Installation according to drawing 0-46684.
– SRW 1301–1600
Important: for SRW 1201-1450 additional stay in conjunction with stay-guide 6-31512-10.
- [4] With PVC windows it is necessary to use 2 profile-specific packers for each additional stay.
- [5] When cropping the faceplate by less than 150 mm or when the notches are still visible after cropping, rod guide 8-00805 should be positioned at least 65 mm from the faceplate end.
- [6] With SRH > 2350 or > 2450, extension 500, respectively 250 must be used.
VHH gear
SRH 2451–2700: use extension 250 uncropped and crop the drive-gear at the top (0 up to 250 mm) according to SRH.
SRH 2701–2800: use extension 500 cropped to dim. 350 and crop the drivegear at the top (0 up to 100 mm) according to SRH.

UNI-JET D – Tilt&Turn

Max. Sash Weight 100 kg

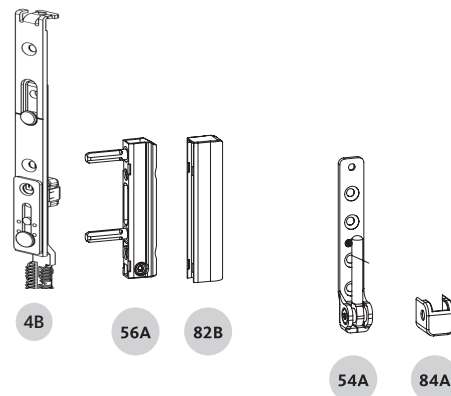
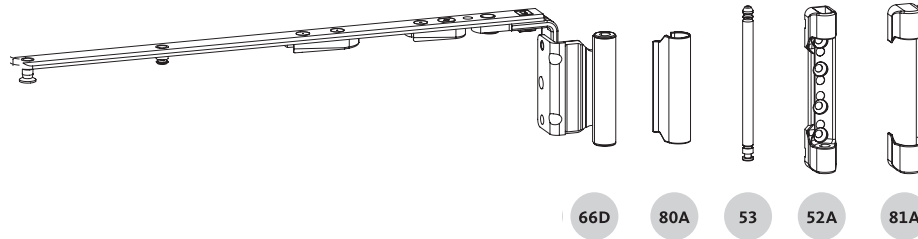

UNI-JET D – Tilt&Turn

Max. Sash Weight 100 kg



Tilt&Turn Stay-arm, Axis 13 – Sash overlap 20

Item	SRW	PU	Part Number
66D	400-500	10	6-40245-20-L/R-1
	501-750	10	6-40246-20-L/R-1
	751-1200	10	6-40247-20-L/R-1
	1201-1600	10	6-40248-20-L/R-1

Bag of Hinges and Covers

Item	PU	Part Number
Set of hinges and covers cap in poly-bag: 1 x 6-36026-06-0-1 1 x 9-48898-00-0-1 1 x 6-36180-01-0-1 1 x 6-36882-22-0-* 1 x 9-47795-01-0-* 1 x 9-47334-01-0-* 1 x 9-47783-01-0-* 1 x 9-42683-00-0-*		K-C5091-00-0-*

* = Available finishes: 5 = Dark Brown, 7 = White

** = Can be order as 1

Bag of Covers

Item	PU	Part Number
Set of covers cap in poly-bag: 1 x 9-47795-01-0-* 1 x 9-47334-01-0-* 1 x 9-47783-01-0-* 1 x 9-42683-00-0-*	100**	K-18675-00-0-*

* = Available finishes: 1 = Silver, 5 = Dark Brown, 7 = White, 6 = Black

** = Can be order as 1

Cover Cap for Stay-hinge

Item	PU	Part Number
80A	100	9-47795-01-0-*

* = Available finishes: 5 = Dark Brown, 7 = White, 6 = Black

Drill-in Hinge – Sash

Item	PU	Part Number
56A	100	6-36180-01-0-1

Cover Cap for Drill-in Hinge

Item	PU	Part Number
82B	100	9-47783-01-0-*

* = Available finishes: 5 = Dark Brown, 7 = White, 6 = Black

Pivot-rest – Frame

Item	PU	Part Number
54A	100	6-36882-22-0-*

* = Available finishes: 5 = Dark Brown, 7 = White, 1 = Silver, 6 = Black

Cover Cap for Pivot-rest

Item	PU	Part Number
84A	100	9-42683-00-0-*

* = Available finishes: 5 = Dark Brown, 7 = White, 6 = Black

Stay-bearing pin

Item	PU	Part Number
53	100	9-48898-00-0-1

Stay-bearing – Frame

Item	PU	Part Number
52A	100	6-36026-06-0-1

Cover Cap for Stay-bearing

Item	PU	Part Number
81A	100	9-47334-01-0-*

* = Available finishes: 5 = Dark Brown, 7 = White, 6 = Black

UNI-JET D Central Locking System

Turn-Only Sash – Variable Handle Height



UNI-JET D Central Locking System

Turn-Only Sash – Variable Handle Height



Gear Connector 90° – Top

Item	SRH	Length	LC	PU	Part Number
4A	280-2800	160	1	10	6-32104-00-0-1
4B	280-2800	160	-	10	6-32624-00-0-1*

*Connector without locking can be used in case of French windows only.

T&T Gear 15 Backset – Variable Handle Height

Item	SRH	Length	G	LC	PU	Part Number
2A	350-450 [1]	363	155	-	10	G-22120-00-0-1
	480-590	270	240-295	-	10	G-22080-00-0-1
	591-750	430	295-375	-	10	G-22081-00-0-1
	751-1200	880	375-600	1	10	G-22082-00-0-1
	951-1450	1130	457-725	1	10	G-22083-00-0-1
	1201-1700	1380	600-850	2	10	G-22084-00-0-1
	1451-1950	1630	725-975	2	10	G-22085-00-0-1
	1951-2500	2130	975-1225	3	10	G-22086-00-0-1
[1] Optional fixed						

Standard Gear Connector 180° – Bottom

Item	SRH	Length	LC	PU	Part Number
4D	480-2800	160	-	10	6-32303-00-0-1

Security Gear Connector 180° – Bottom (Optional)

Item	SRH	Length	LC	PU	Part Number
4E	480-2800	160	1	10	6-33205-00-0-1

Center-lock for Turn-Only Sash – Horizontal Top and Bottom

Item	SRW	Length	LC	PU	Part Number
13D	280-750	215	1	10	6-32010-00-0-1
13H	751-950	530	1	10	6-32075-05-0-1
	951-1200	740	1	10	6-32075-07-0-1
	1201-1600	1050	2	10	6-32075-10-0-1

Rod Guide

Item		PU	Part Number
6	Quantity as required [1]	100	8-00805-00-0-0

Run-up Block

Item		PU	Part Number
7		100	9-41796-00-0-1

Standard Striker

Item		PU	Part Number
9	Thermoplast - La Marquise	100	9-34907-03-0-1
	Rehau - 4500	100	9-35770-00-0-1
	Rehau - Geneo	100	9-44525-01-0-1
	Veka - Euroview 70	100	9-42972-00-0-1
	Vision Palladina 880 series	100	9-38128-00-0-1

Security Striker (Optional)

Item		PU	Part Number
11	Thermoplast - La Marquise	100	6-27831-05-0-1
	P.H. Tech - Twist	100	6-27831-06-0-1
	Rehau - 4500	100	6-31067-07-0-1
	Rehau - Geneo	100	6-30495-05-0-1
	Veka	100	6-31067-05-0-1
	Vision Palladina 880 series	100	9-41825-00-0-1

[1] When cropping the faceplate by less than 150 mm or when the notches are still visible after cropping, rod guide 8-00805 should be positioned at least 65 mm from the faceplate end.

UNI-JET D – Turn-Only Sash

Max. Sash Weight 100 kg

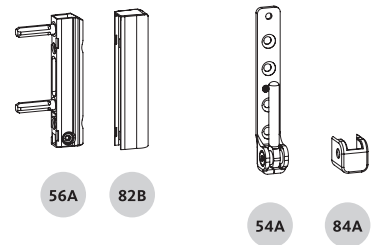
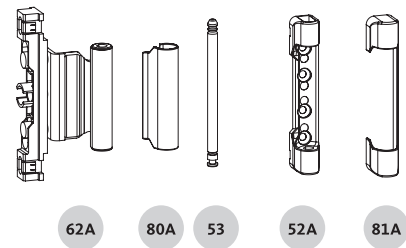
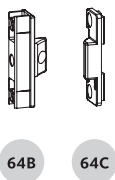
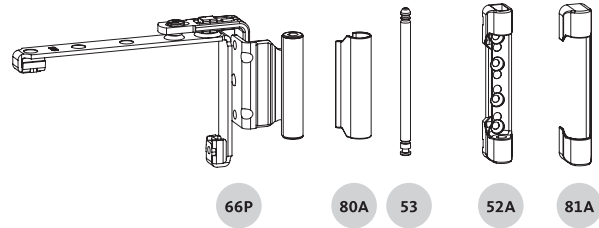

UNI-JET D – Turn-Only Sash

Max. Sash Weight 100 kg



Turn-Only Hinge, Axis 13 – Sash overlap 20

Item	PU	Part Number
66P	50	6-39148-20-0-1

Cover Cap for Stay-hinge

Item	PU	Part Number
80A	100	9-47795-01-0-*

* = Available finishes: 5 = Dark Brown, 7 = White, 6 = Black

Stay-bearing pin

Item	PU	Part Number
53	100	9-48898-00-0-1

Stay-bearing – Frame

Item	PU	Part Number
52A	100	6-36026-06-0-1

Cover Cap for Stay-bearing

Item	PU	Part Number
81A	100	9-47334-01-0-*

* = Available finishes: 5 = Dark Brown, 7 = White, 6 = Black

Drill-in Hinge – Sash

Item	PU	Part Number
56A	100	6-36180-01-0-1

Cover Cap for Drill-in Hinge

Item	PU	Part Number
82B	100	9-47783-01-0-*

* = Available finishes: 5 = Dark Brown, 7 = White, 6 = Black

Pivot-rest – Frame

Item	PU	Part Number
54A	100	6-36882-22-0-1

Cover Cap for Pivot-rest

Item	PU	Part Number
84A	100	9-42683-00-0-*

* = Available finishes: 5 = Dark Brown, 7 = White, 6 = Black

Turn-Only Centre Rebate-Hinge, Axis 13 – Sash overlap 20

Item	PU	Part Number
62A	100	6-36842-20-0-1

Centre-closer, concealed

Item	PU	Part Number
64B	100	6-34229-00-0-1
64C		
	Thermoplast - La Marquise	100 9-40866-00-0-1
	P.H. Tech - Twist	100 9-40866-00-0-1
	Rehau - 4500	100 9-40565-07-0-1
	Rehau - Geneo	100 9-44549-00-0-1
	Veka - Euroview 70	100 9-40866-00-0-1
	Vision	100 9-40564-00-0-1

UNI-JET D Central Locking System

Dummy-mullion Sash with ZH Lever-operated Gear – Variable Handle Height



UNI-JET D Central Locking System

Dummy-mullion Sash with ZH Lever-operated Gear – Variable Handle Height



Standard Gear Connector 180° – Top

Item	SRH	Length	LC	PU	Part Number
4D	480-2800	160	-	10	6-32303-00-0-1
4E	480-2800	160	-	10	G-22911-00-0-1

ZH Lever-operated Gear – Variable Handle Height

Item	SRH	Length	G	S	PU	Part Number
24A	781-950	630	356-536	1	10	G-22170-00-0-1
	951-1450	1130	310-560	1	10	G-22171-00-0-1
	1451-1950	1630	310-560	2	10	G-22172-00-0-1
	1951-2450	2130	310-560	3	10	G-22173-00-0-1
	2451-2800 [3]	2130	310-560	3	10	G-22173-00-0-1
5C	2451-2700 [3]	250	-	-	10	8-00625-00-0-1
5E	2701-2800 [2] [3]	500	-	-	10	G-21040-00-0-1

Standard Gear Connector 180° – Bottom

Item	SRH	Length	LC	PU	Part Number
4D	780-2800	160	-	10	6-32303-00-0-1
4E	480-2800	160	-	10	G-22910-00-0-1

Center-lock – Horizontal Top and Bottom

Item	SRW	Length	LC	PU	Part Number
13D	280-750	215	1	10	6-32010-00-0-1
13Q	751-950	530	2	10	6-32008-05-0-1
	951-1200	740	2	10	6-32008-07-0-1
	1201-1600	1050	3	10	6-32008-10-0-1

Rod Guide

Item		PU	Part Number
6	Quantity as required [1]	100	8-00805-00-0-0

Run-up Block

Item		PU	Part Number
7		100	9-41796-00-0-1

[1] When cropping the faceplate by less than 150 mm or when the notches are still visible after cropping, rod guide 8-00805 should be positioned at least 65 mm from the faceplate end.

[2] With SRH > 2600, resp. > 2700, the screw-on standard striker 9-30256-00-0-1 must be screwed to the faceplate of extension G-21040-00-0-1.

[3] With SRH > 2350 or > 2450, extension 500, respectively 250 must be used.

VHH gear

SRH 2450–2700: use extension 250 uncropped and crop the drive-gear at the top (0 up to 250 mm) according to SRH.

SRH 2701–2800: use extension 500 cropped to dim. 350 and crop the drivegear at the top (0 up to 100 mm) according to SRH.

UNI-JET D Central Locking System

Profile Specific Accessories



Rod Guide

Item		PU	Part Number
6	Quantity as required [5]	100	8-00805-00-0-0

Run-up Block

Item		PU	Part Number
7		100	9-41796-00-0-1

Standard Striker

Item		PU	Part Number
9	Thermoplast - La Marquise	100	9-34907-03-0-1
	P.H. Tech - Twist	100	6-27831-06-0-1
	Rehau - 4500	100	9-35770-00-0-1
	Rehau - Geneo	100	9-44525-01-0-1
	Veka - Euroview 70	100	9-42972-00-0-1
	Salamander (BluEvolution)	100	9-38218-00-0-1
	Vision Palladino 880 series	100	9-42972-00-0-1

T&T Striker (Security Striker Optional)

Item		PU	Part Number
11	Thermoplast - La Marquise	100	6-27831-05-0-1
	P.H. Tech - Twist	100	6-27831-06-0-1
	Rehau - 4500	100	6-31067-07-0-1
	Rehau - Geneo	100	6-30495-05-0-1
	Veka	100	6-31067-05-0-1
	Vision Palladino 880 series Mushroom Keeper	100	9-41825-00-0-1
	Salamander (BluEvolution)	100	6-31067-15-0-1

Failsafe (mishandling device)

Item		PU	Part Number
22A	Axis 13	100	6-31657-13-L/R-1
	Only required for locking gears G-22082/3/4/5/6		

Sash Lifter & Run-up Stop

Item		PU	Part Number
22	Sash lifter with mishandling device	100	6-29987-00-0-1
23	Run-up stop	100	acc. to profile list matrix
	Only required for locking gears G-22082/3/4/5/6		

Drive-Gear Installation Dimensions



Drive-gear installation dimensions

1:2

Drilling jig for turn handle 6-22459
 Additionally for FHH gear: stop 9-27406

Handle height HH

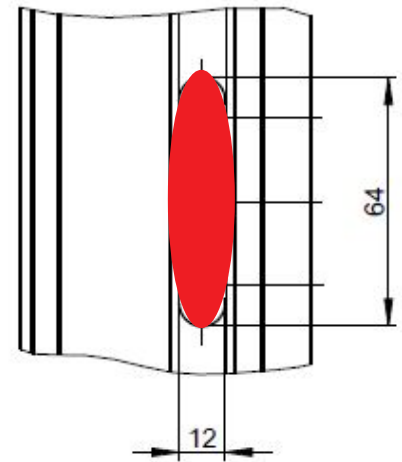
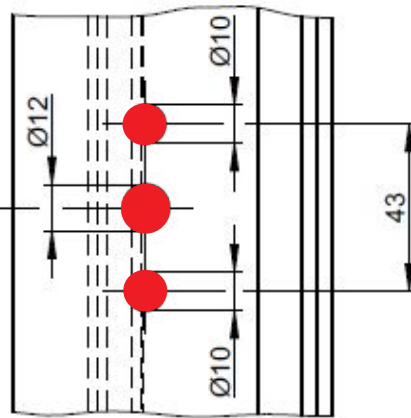

Gear 7.5

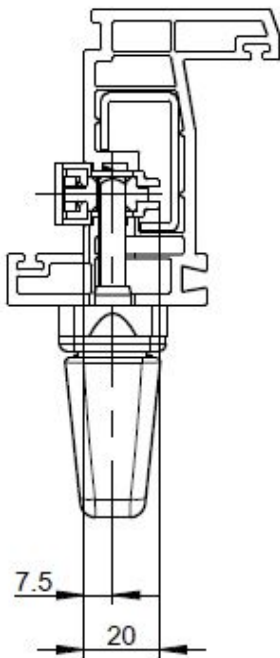

Gear 15

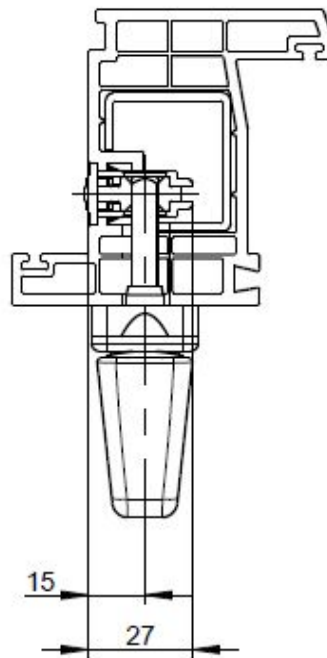

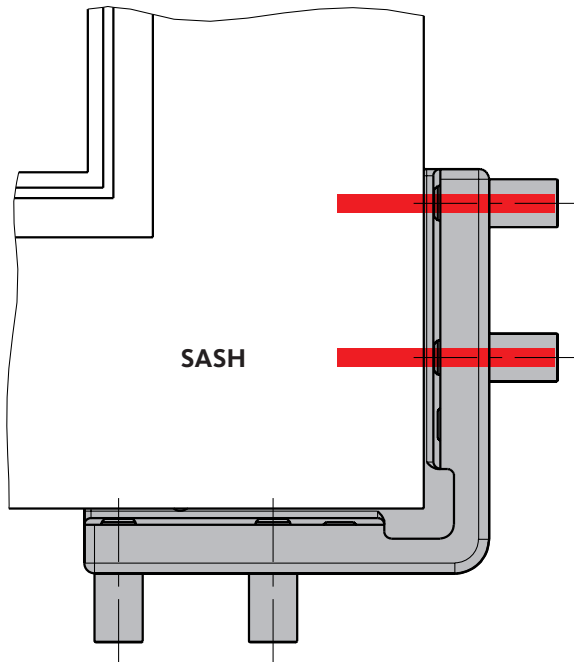

Drilling Jig for Drill-in Hinge

Description	PU	Part Number
Axis 13	1	6-38619-13-0-0
PU = Packaging Unit		

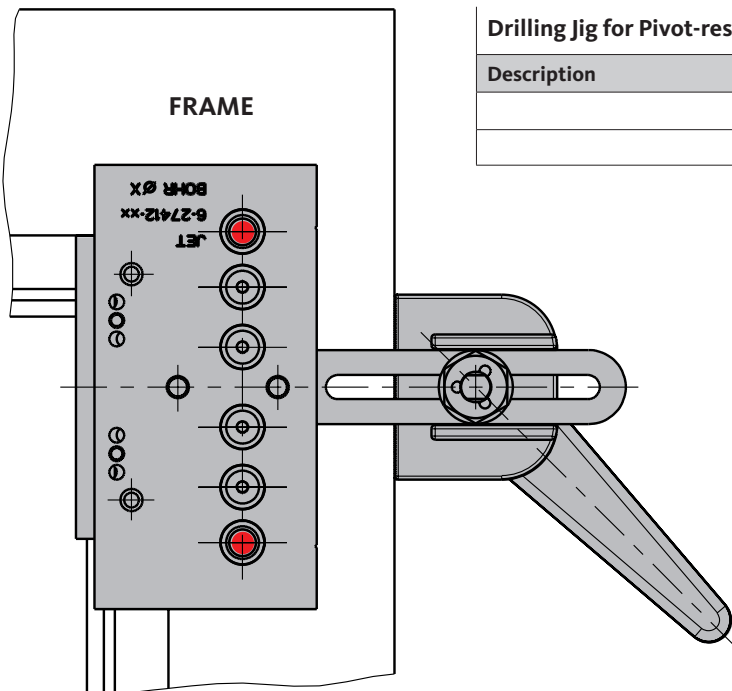

Drilling Jig for Pivot-rest and Stay-bearing

Description	PU	Part Number
	1	6-27412-54-0-0
PU = Packaging Unit		



Multi Functional Adjusting Tool

Description	PU	Part Number
Includes ratchet and bits	1	6-37291-00-0-1
* = Color		PU = Packaging Unit



Construction Pull Handle for Stay-Bearing Pin

Description	PU	Part Number
Handle with 7mm square spindle and pull tap for stay-bearing pin	1	6-38513-02-0-9
* = Color		PU = Packaging Unit

Additional information

- See glazing accessories and tools catalog

"See glazing accessories and tools catalog"



Torx 15 T-Key

Description	Color	PU	Part Number
Torx key	Steel	1	H-00346-15-0-0
* = Color		PU = Packaging Unit	

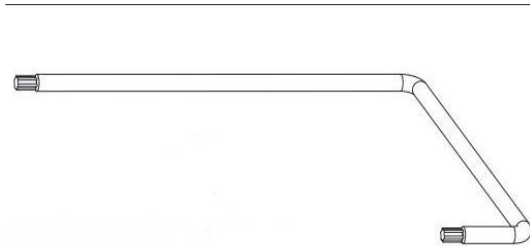

Torx 15 Adjusting Key

Description	PU	Part Number
U-shaped 110 x 100 x 25mm	1	9-43631-00-0-6
Torx / 4mm Allen key bit	1	9-43631-01-0-6
* = Color		PU = Packaging Unit

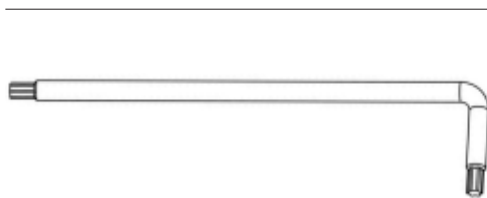

Torx Allen Key for Unijet Cam Adjustment

Description	PU	Part Number
L-shaped 100 x 24mm	1	H-00809-15-0-0
* = Color		PU = Packaging Unit



D1 Screws for Hardware Installation

Description	Dimension mm	Color	PU	Part Number
D1 screws	4.2 x 20	Zinc	1000	E-12562-20-0-1
D1 screws	4.2 x 22	Zinc	1000	E-12562-22-0-1
D1 screws	4.2 x 25	Zinc	1000	E-12562-25-0-1
D1 screws	4.2 x 30	Zinc	1000	E-12562-30-0-1
D1 screws	4.2 x 35	Zinc	1000	E-12562-35-0-1
D1 screws	4.2 x 40	Zinc	1000	E-12562-40-0-1

* = Color PU = Packaging Unit

Product characteristics

- Classic hardware screw, incorporating the latest technology, with double-pitch thread
- Also ideal for thin-walled profiles
- High overtorquing and extraction values in PVC
- Roller-sorted quality for automatic screwing
- Steel, case hardened

Applications

- Fastening of Tilt&Turn hardware in normal and thin-walled PVC profiles and also in steel or GFRP inserts
- Fastening of closing parts, hinges and bearings

Processing

- Screwing with speeds of approx. 1,500 to 2,000 rpm
- Can be screwed into steel; pre-drilling required (see technical data and requirements)
- Can be screwed into GFRP without pre-drilling

Technical data and requirements

Head diameter	7.3 mm
Drive	Philips PH 2
Thread type	Double-pitch thread
Sheet metal thickness	Pre-drill diameter
1.5 mm	3.0 mm
2.0 mm	3.2 mm
2.5 mm	3.5 mm

Installation diagram

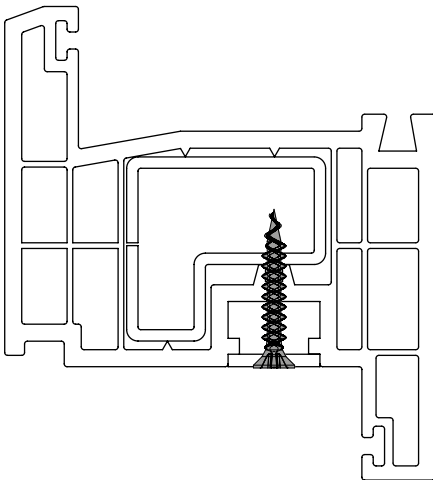



B1 Screws for Hardware Installation

Description	Dimension mm	Color	PU	Part Number
B1 screws	3.9 x 13	Zinc	1000	E-12563-13-0-1
B1 screws	3.9 x 16	Zinc	1000	E-12563-16-0-1
B1 screws	3.9 x 19	Zinc	1000	E-12563-19-0-1
B1 screws	3.9 x 25	Zinc	1000	E-12563-25-0-1
B1 screws	3.9 x 32	Zinc	1000	E-12563-32-0-1
* = Color			PU = Packaging Unit	

Product characteristics

- Roller-sorted quality for automatic screwing
- Steel, tempered

Applications

- Fastening of steel reinforcement up to 3.0 mm in PVC windows in which the reinforcement is close together
- Fastening of hardware components

Processing

- Screwing with speeds of approx. 1,500 to 2,000 rpm

Installation diagram

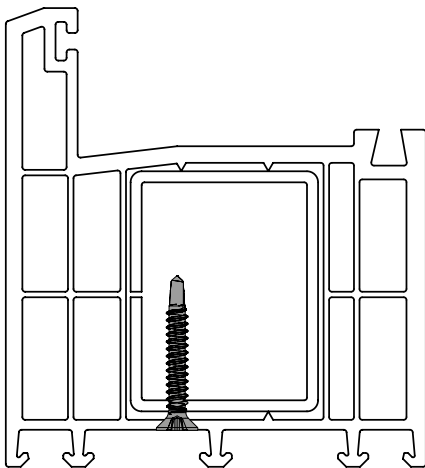

Technical data and requirements

Head diameter	7.5 mm
Drive	Philips PH 2
Thread type	ST thread



WINDOW TECHNOLOGY
DOOR TECHNOLOGY
AUTOMATIC ENTRANCE SYSTEMS
BUILDING MANAGEMENT SYSTEMS

HEAD OFFICE

Ferco Architectural Hardware Inc.
2000, Berlier St.
Laval, QC H7L 4S4
Tel.: 450 973-1437
1 800 355-8810
Fax: 450 973-7661
ferco@ferco.ca

ONTARIO / WESTERN PROVINCES

Tel.: 905 282-9588
1 800 668-5310
Fax: 905 282-9915

UNITED STATES

Tel.: 1 800 927-1097
Fax: 1 888 454-0161

www.ferco.ca

Edition 03.2022 | Printed in Canada



Securing technology for you

