

Parallel slide and tilt fittings G.U-966 are manufactured with utmost care and tested for correct functioning before delivery. Possible malfunction usually results from incorrect transportation or installation.

Claims of malfunction resulting from the non-observance of the present instructions are not accepted.

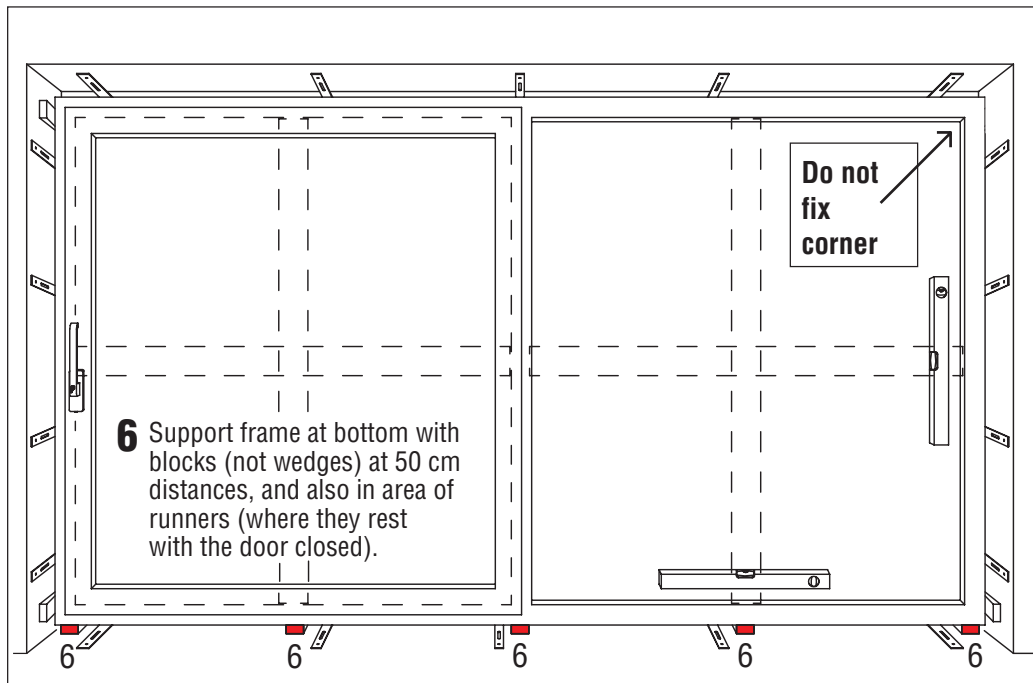
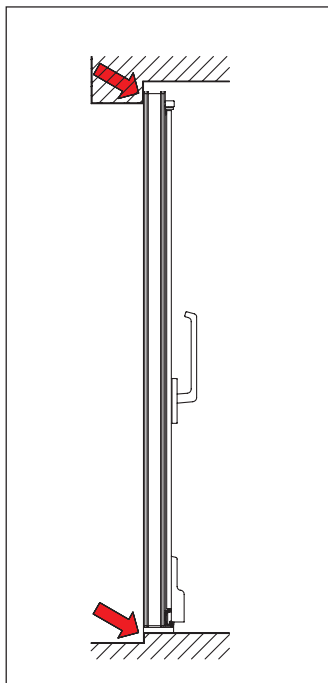

1 Place unit in door aperture in closed condition (= handle in upright position).

2 Adjust frame with water level in horizontal and vertical direction. Fix with timber wedge on sides.

4 Fix frame at top (in case there are no shutters) and on sides at 4 to 5 points, and at bottom at 2 to 3 points. Fixing variants: Through-fixing (screws) / wall ties / window clamps.

5 Seal frame towards brickwork with textile cord, foam cords or PUR foam. Attention: Do not bend frame profile.

3 Open door and check it for correct running; if necessary, adjust by displacing the timber wedges.

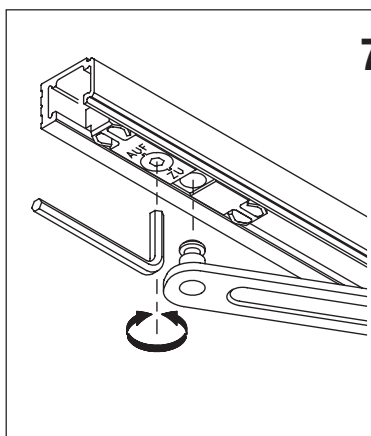

7 Inserting the sliding sash:
Place sash on running rail in tilt position (= turn handle in horizontal position); insert stay arm pin in glider and fix with 4 mm Allen key. Pull on stay arm with force to ensure that it is safely fixed.

Removing the sliding sash:
Put sash in tilt position (handle in horizontal position). Disconnect stay arm with 4 mm Allen key.

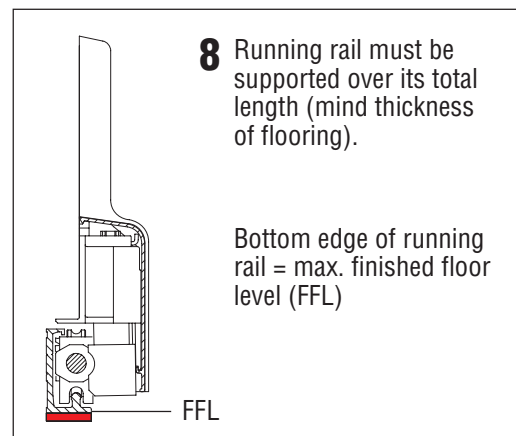

8 Running rail must be supported over its total length (mind thickness of flooring).

Bottom edge of running rail = max. finished floor level (FFL)

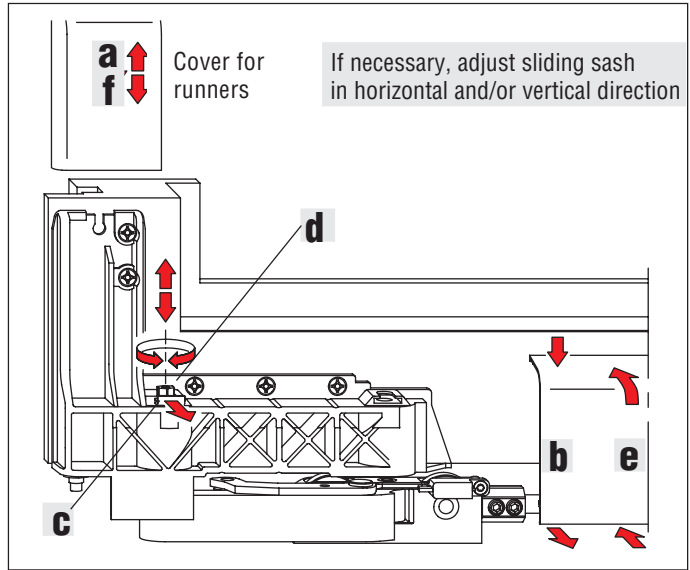
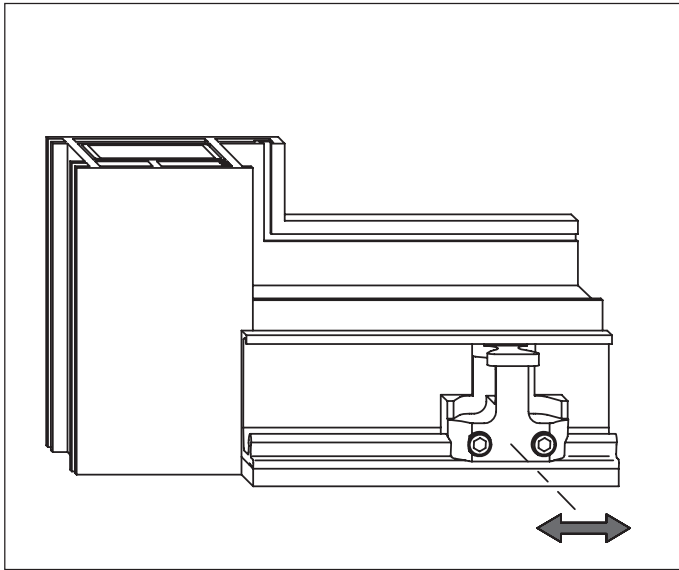

9 The rebate clearance between frame and sliding sash must be equal on bottom right and left side.

If necessary, loosen control piece (4 mm Allen key); shift and retighten it firmly.

10 Adjusting the gasket pressure: Turn locking pin by 180° at the max. (+/- 1 mm) with 4 mm Allen key.

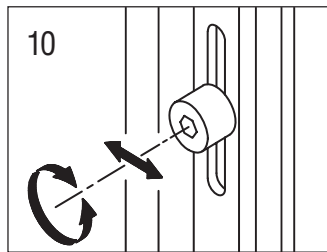

11 The rebate clearance must always be equal at the top and on the sides.

d Vertical runner adjustment (rebate clearance):
 – screw to the right = lift (+ 4 mm)
 – screw to the left = lower (- 1 mm)
 Push back safety slider c, set screw is secured again.

a Remove end caps from both runners.

b Remove cover rail: push down in the middle of each runner and pull off towards the front.

c Pull out safety slider to the front. The set screw is now released for adjustments.

e Mount cover rail: Position at the bottom and push against sash

f Slide covers back on runners.

Handle operation G.U-966 mZ, oZ:

12 **Tilt position:** Turn handle from vertical to horizontal position: the sash slides out from closed position.

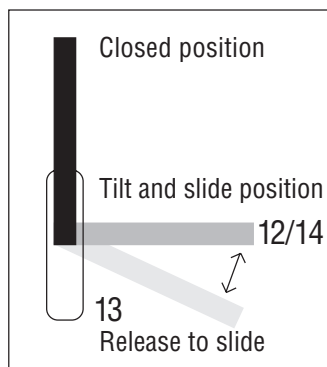

13 **Releasing the sliding sash:** A soft pressure on the handle

966 mZ ... downwards releases the sash for sliding

966 oZ ... upwards releases the sash for sliding (oZ = bottom illustration)

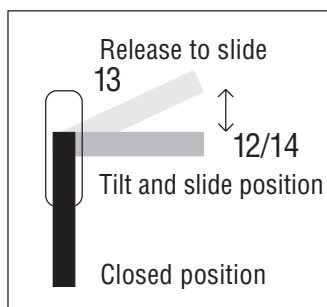

14 **Sliding position:** With sliding sash, the handle must be in horizontal position; do not push upwards or downwards.

Maintenance and care of sliding sash fittings:

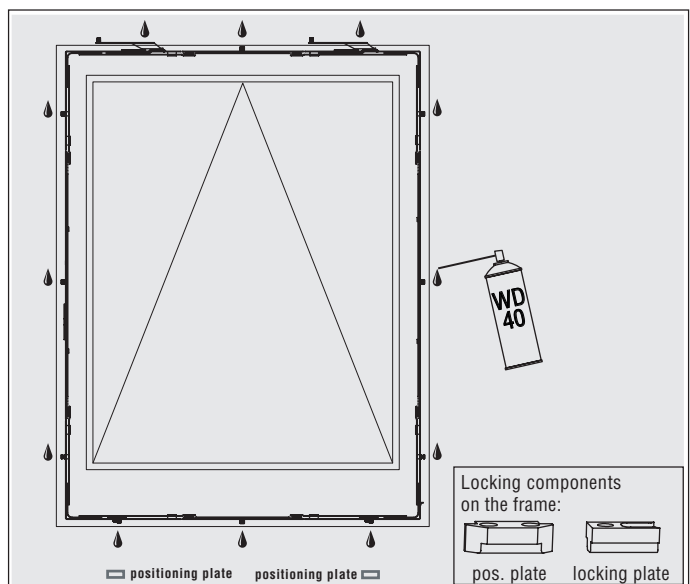

15 In order to maintain the gliding ability of all movable locking points, lubricate them with acid- and resin-free lubricants (corrosion protection). Grease all locking and positioning plates.

Advice: To provide for correct hardware functioning over a long period of time, it is necessary that the user should carry out the maintenance jobs on the sliding sash at least once a year.