

EN

Turn-Only windows central locking system

Installation instructions

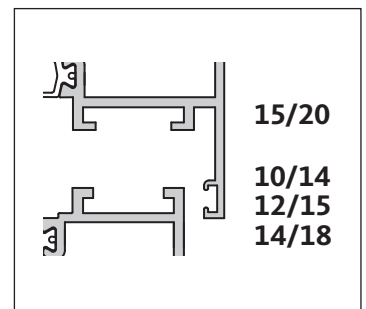
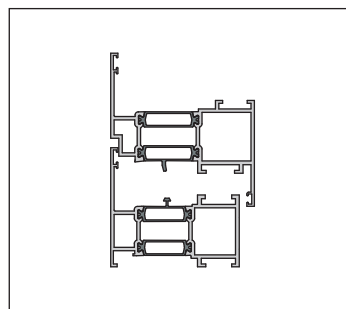
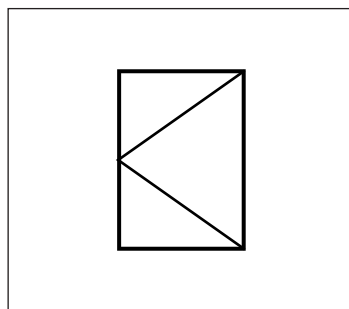

Inhaltsverzeichnis

1. Supplementary documents	Seite	2
2. Symbols and abbreviations.....	Seite	2
3. Notes	Seite	2
4. Installation dimensions	Seite	3
5. Hardware overview – standard version	Seite	4
6. Hardware combination – standard version	Seite	5
7. Hardware overview – shoot-bolt version (only frame groove 14/18).....	Seite	6
8. Hardware overview – Shoot-bolt version (only frame groove 14/18).....	Seite	7
9. Machining of profile.....	Seite	8
10. Dimensions of connecting rods – standard version	Seite	9
11. Dimensions of connecting rods – shoot-bolt version (only frame groove 14/18)	Seite	10
12. Installation on sash.....	Seite	11
13. Installation on frame – standard version.....	Seite	18
14. Installation on frame – shoot-bolt version (only frame groove 14/18).....	Seite	19
15. Adjustments.....	Seite	20
16. Disassembly and disposal	Seite	20

ALU-JET 10

Turn-Only windows central locking system

1. Supplementary documents





- Installation instructions, face-fixed hinge-side ALU-JET 610 0-48087
- Installation instructions, concealed hinge-side ALU-JET CC610 0-47136

2. Symbols and abbreviations

Abbreviations

TU-ON	Turn-Only
SB	Shoot-bolt
SW	Sash width
SH	Sash height
IG	Insertable gear
LH	Left handed
M.D.	Mishandling device
HH	Handle height
HP	Hole pattern for geared turn handle
CL	Centre-lock
OH	Overlap height

Symbols

-  Size x Hexagon key size x
-  PHx Phillips screwdriver size x
-  Grease all locking points, sliding and bearing points with an acid-free lubricant which is not prone to gumming.

3. Notes

ATTENTION

Observe the product information in the GU order catalogue and the installation instructions of the hinge-side used and corresponding application diagrams.

ATTENTION

Please consider the system manufacturer's product information, especially information on profile design and machining, max. sash dimensions, max. sash weights and material qualities (e.g. linear profile expansion)!

NOTE

The specified fixing type is a recommendation based on our experience. Observe the TBDK, VHBE and VHBH directives of the German Quality Assurance Association for Locks and Hardware (D-42551 Velbert, Germany).

! WARNING

The responsibility for the secure fastening of hardware components lies with the window and balcony-door fabricator!

ALU-JET 10

Turn-Only windows central locking system



4. Installation dimensions

Required if the profile is machined for IG using punches.

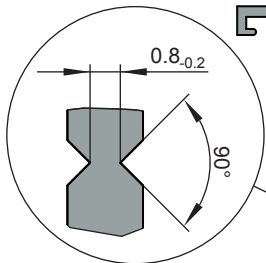

Deepened Euro-groove 15/20

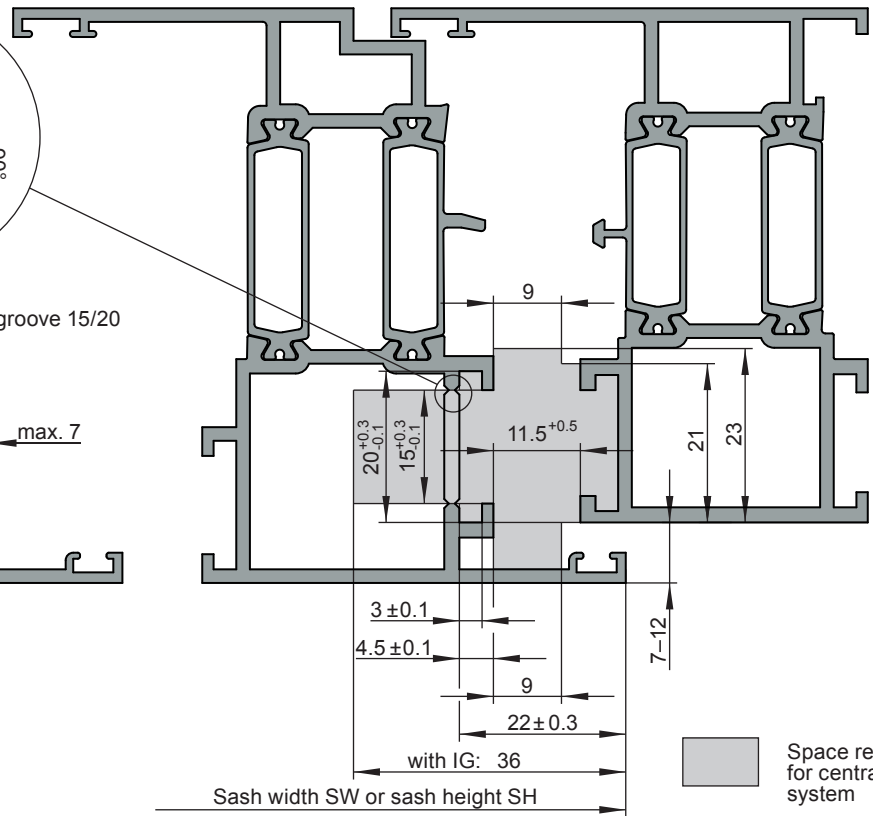
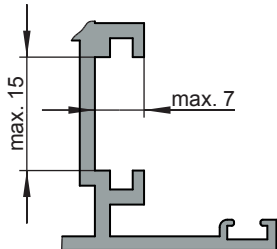

Space required for central locking system

Frame groove 10/14

(only standard version)

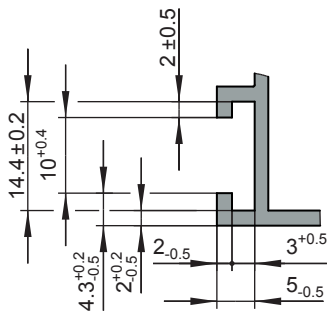

Frame groove 12/15

(only standard version)

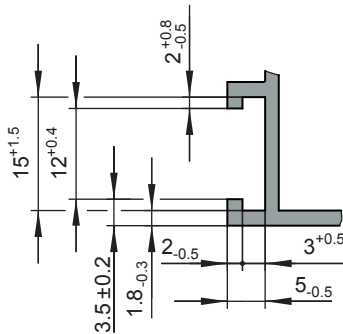

Frame groove 14/18

(standard or shoot-bolt version)

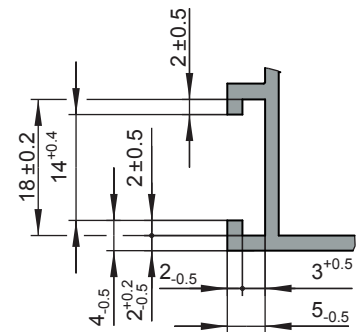

Application range of central locking system

Sash width SW 200–1700 mm
Sash height SH 310–2800 mm

Connecting rod P-01975 or equivalent

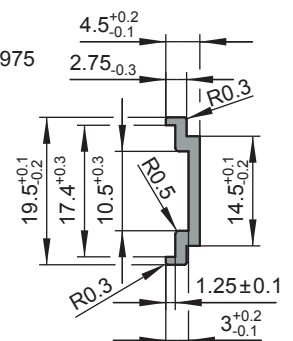

ALU-JET 10

Turn-Only windows central locking system

5. Hardware overview – standard version



SW 200–1200

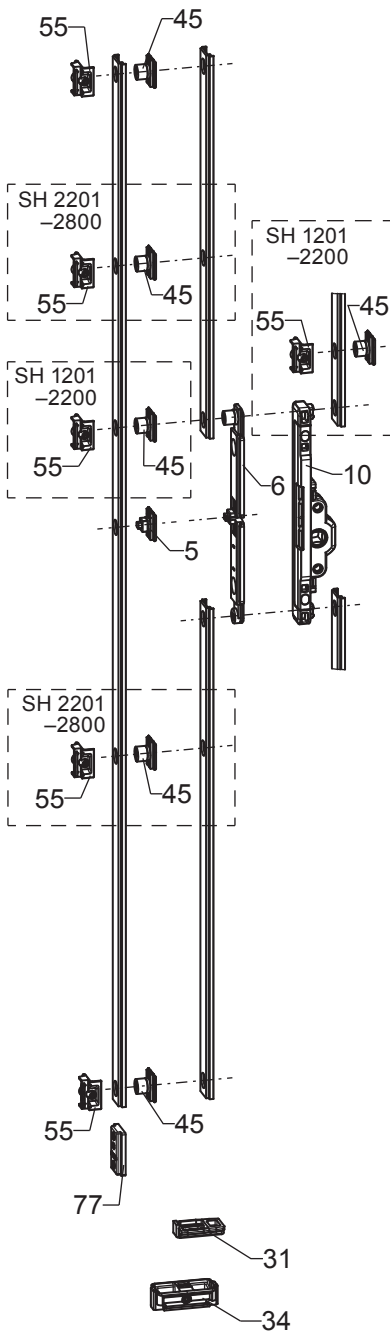

SW 1201–1700

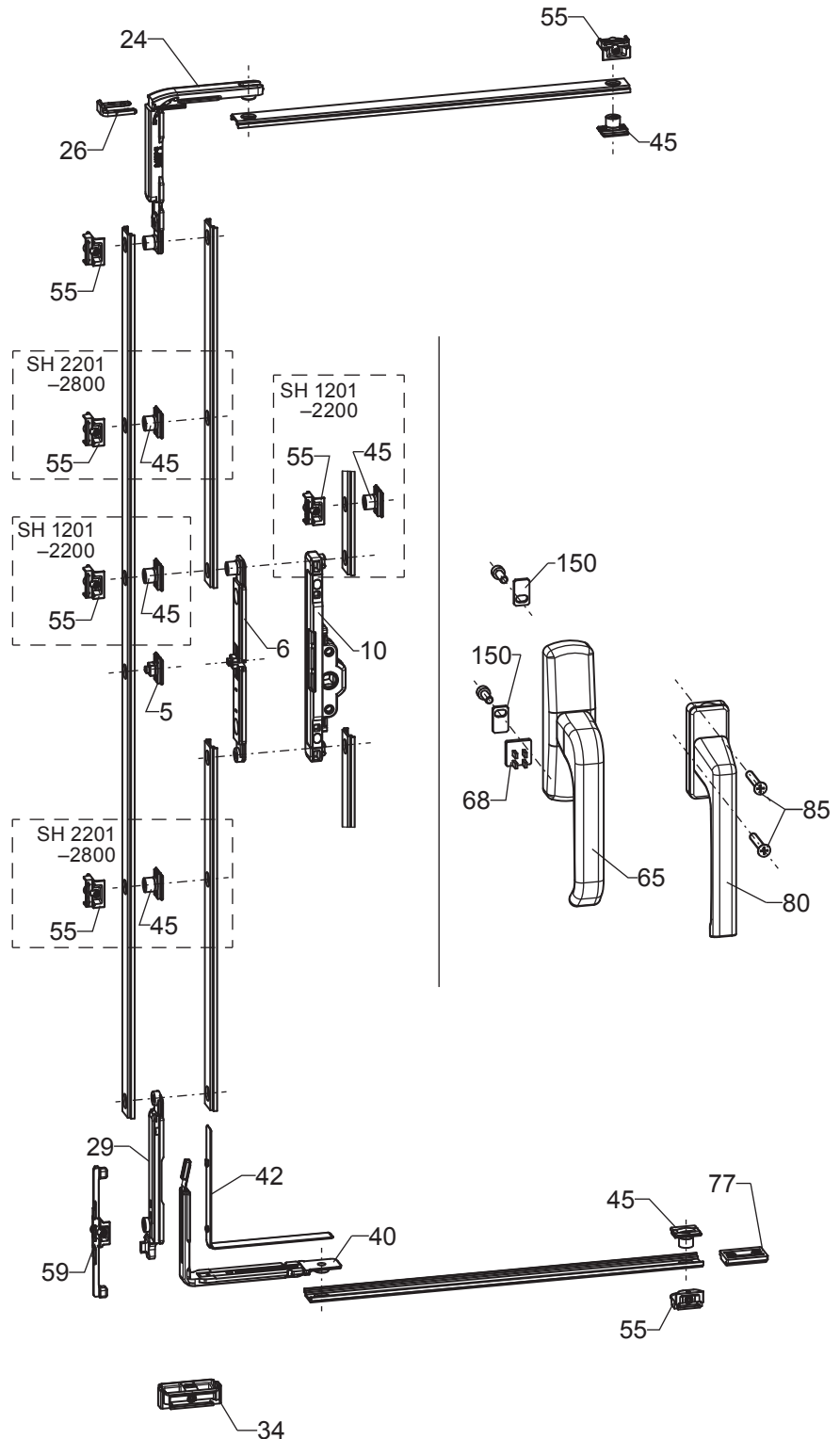

The number of additional locking points (locking cams, item 45 + strikers, item 55) depends on the profiles used (observe the specifications of the system manufacturer) and must be adapted to the requirements of the relevant installation situation.

ALU-JET 10

Turn-Only windows central locking system

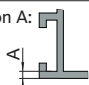

6. Hardware combination – standard version

Item	Description	Order no.	Qty. in K- set	Quantity					
				SW 200-1200			SW 1201-1700		
				SH 410-1200	SH 1201-2200	SH 2201-2800	SH 860-1200	SH 1201-2200	SH 2201-2800
5	Connector	6-37090-00-0	1	1	1	1	1	1	1
Corner-drive without M.D.		K-19774-00-0		-	-	-	1	1	1
24	Corner-drive without M.D.	6-37264-00-0	1	-	-	-	1	1	1
26	Clamping bracket	9-48157-00-0	1	-	-	-	1	1	1
29	T&T tilter	6-37258-00-0		-	-	-	1	1	1
31	Run-up block, sash	9-40404-00-0		1	1	1	-	-	-
34	T&T tilt-pivot	6-37441-00-0		1	1	1	1	1	1
40	Corner drive CL	6-37266-00-0		-	-	-	1	1	1
42	Packer for corner-drive CL (only with deepened groove, for application see page 13)	9-48466-00-0		-	-	-	1	1	1
45	Locking cam	with connector item 5 or IG item 10	6-37111-00-0	2	3	4	2	3	4
		with connector item 6		2	2	4	2	2	4
55	Striker	for A=2.0 *	6-37261-01-0	2	3	4	3	4	5
		for A=1.5 *							
59	T&T striker	for A=2.0 *	6-37272-01-0	-	-	-	1	1	1
		for A=1.5 *							
65	SPACIO geared turn handle with screws	HP 96/104	G-46551-96-0	1	1	1	1	1	1
		HP 84/98							
Alternative to item 5:									
6	Connector for divided connecting rod	6-37257-00-0		1	1	1	1	1	1
Alternative to item 5 and item 65:									
10	Insertable gear w/o M.D.	6-39385-00-0		1	1	1	1	1	1
80	DIRIGENT-F turn handle	6-28072-25-0		1	1	1	1	1	1
85	Countersunk screw M5x30	9-13255-30-0		2	2	2	2	2	2
Accessories:									
68	90° turn-restrictor for SPACIO geared turn handle	9-34612-00-0		1	1	1	1	1	1
77	90° turn restrictor for insertable gear	G-12943-00-0							
150	Packer plate for geared turn handle **	9-50091-00-0		2	2	2	2	2	2
* Dimension A: 				** For reinforcement of the sash overlap. Recommended for larger, heavier sashes.					

ALU-JET 10

Turn-Only windows central locking system

7. Hardware overview – shoot-bolt version (only frame groove 14/18)



SPACIO geared turn handle

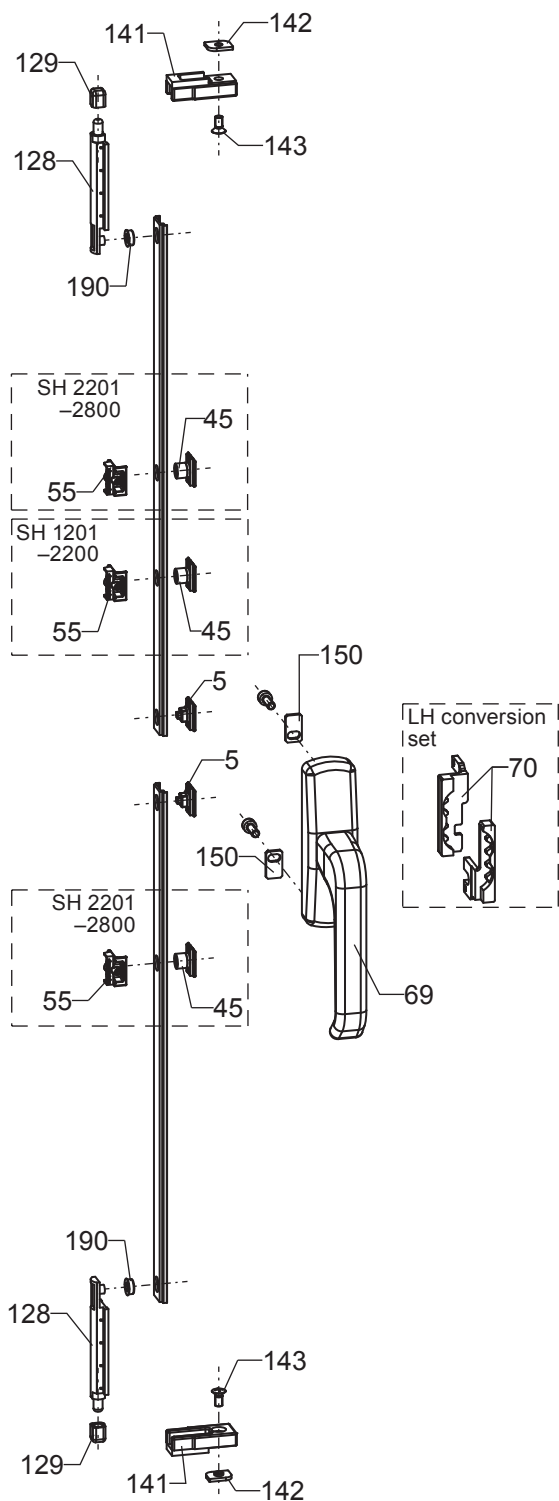

ADAGIO-A geared turn handle

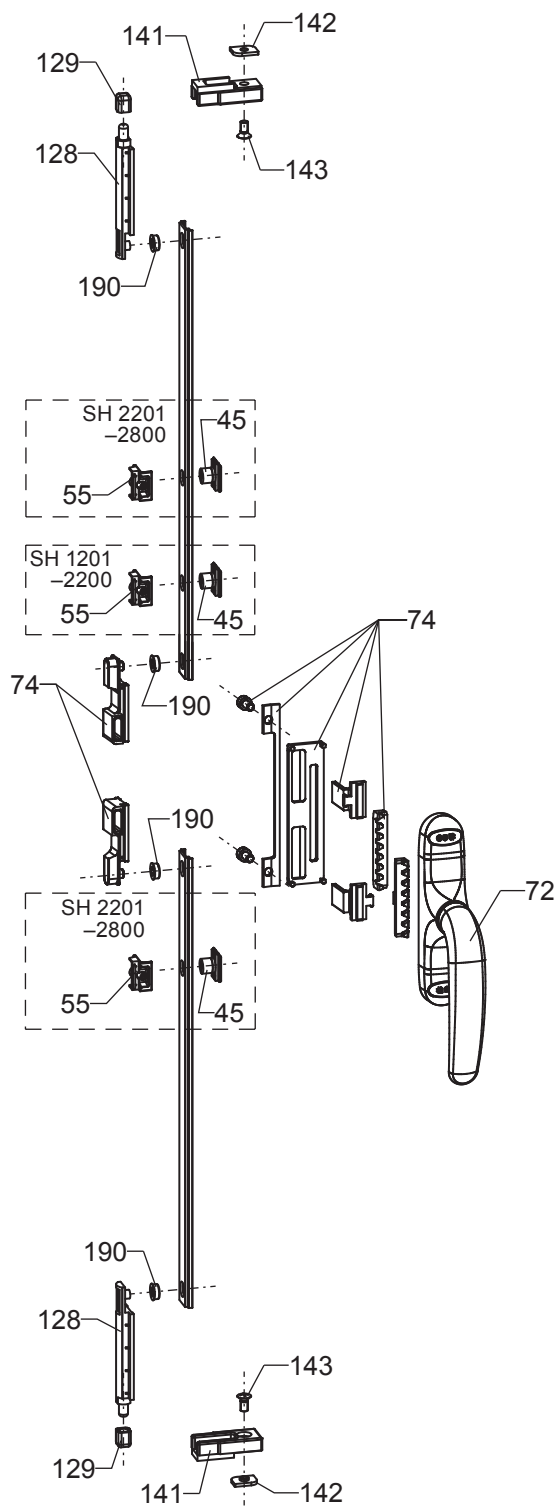

The number of additional locking points (locking cams, item 45 + strikers, item 55) depends on the profiles used (observe the specifications of the system manufacturer) and must be adapted to the requirements of the relevant installation situation.

ALU-JET 10

Turn-Only windows central locking system

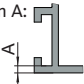

8. Hardware overview – Shoot-bolt version (only frame groove 14/18)

Item	Description	Order no.	Qty. in K-set	Quantity		
				SH *** 310-1200	SH 1201-2200	SH 2201-2800
				SW 200-1200		
SPACIO geared turn handle						
5	Connector	6-37090-00-0		2	2	2
69	SPACIO geared turn handle with 2 connectors with screws	HP 96/104	G-46552-96-R	1	1	1
		HP 98	G-46552-00-R			
70	SPACIO geared turn handle	G-46550-00-L		1	1	1
Alternatively: ADAGIO-A geared turn handle						
72	ADAGIO-A geared turn handle	HP 104	6-31723-00-0	1	1	1
74	Additional parts set for ADAGIO-A for 2 connectors		K-15815-00-0	1	1	1
190	Adapter ring Ø6 to Ø10		9-48454-00-0	2	2	2
45	Locking cam		6-37111-00-0	-	1	2
55	Striker	for A=2.0 *	6-37261-01-0	-	1	2
		for A=1.5 *	6-37261-02-0			
TU-ON + DM-DCG shoot-bolt set			K-15817-00-0	2	2	2
128	Connecting-rod shoot-bolt		6-31727-00-0	1	2	2
129	CR shoot-bolt eccentric cap		9-41515-00-0	1	2	2
TU-ON + shoot-bolt striker set 14/18			K-15819-00-0	2	2	2
141	CR shoot-bolt striker 14/18		9-41516-00-0	1	2	2
142	Clamping piece 14/18		9-41517-00-0	1	2	2
143	Raised countersunk-head screw M5x10		9-13369-10-R	1	2	2
190	Adapter ring Ø6 to Ø10		9-48454-00-0	2	2	2
Accessories:						
150	Packer plate for geared turn handle **		9-50091-00-0	2	2	2
* Dimension A:  ** For reinforcement of the sash overlap. Recommended for larger, heavier sashes, only with item 69 (SPACIO geared turn handle with 2 connectors) *** With ADAGIO-A geared turn handle: SH 370-1200						

ALU-JET 10

Turn-Only windows central locking system

9. Machining of profile

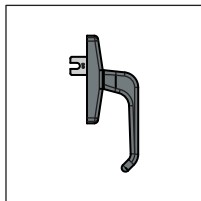

HP 104
HP 98
HP 96
HP 84

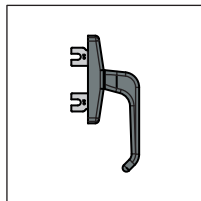

HP 104
HP 98
HP 96

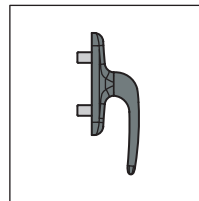

HP 104

HP 104

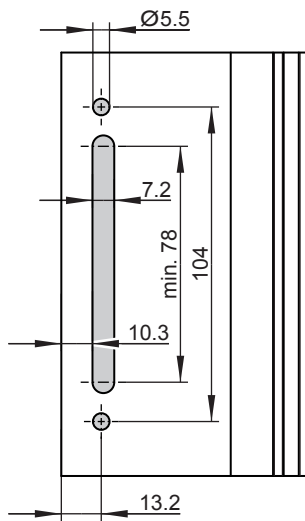

HP 98

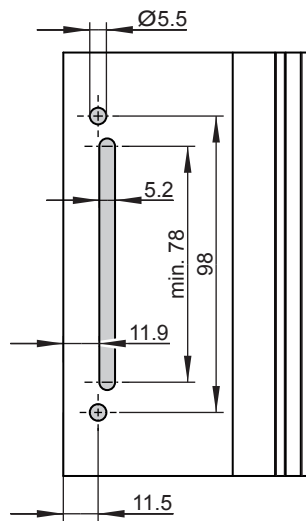

HP 96

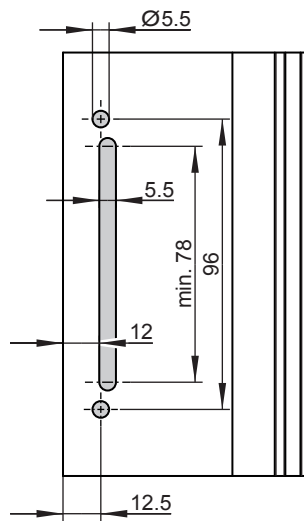

HP 84

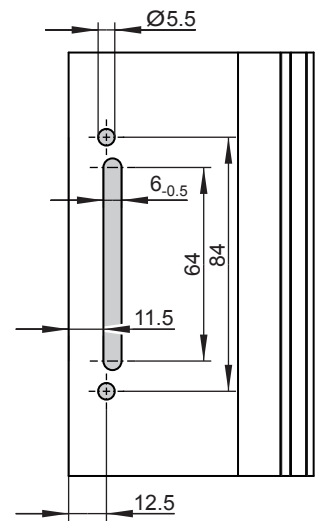

Punching tool for HP 104:
6-31957-00-0

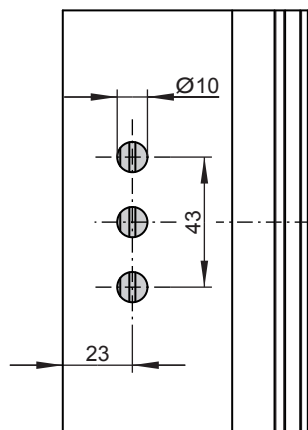
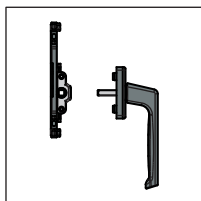

Punching tool:

e.g. Reiplinger, Type GLS
www.reiplinger.com

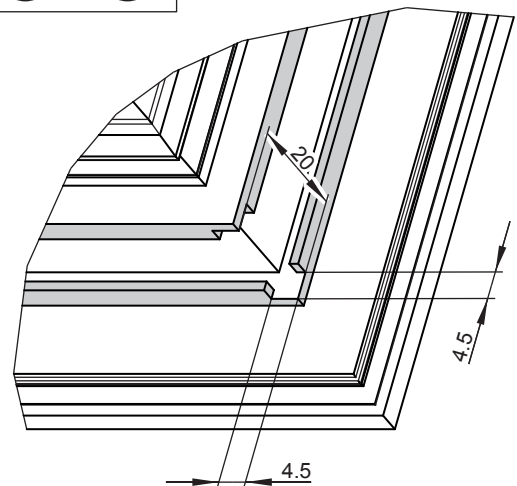
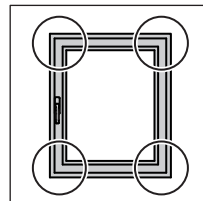
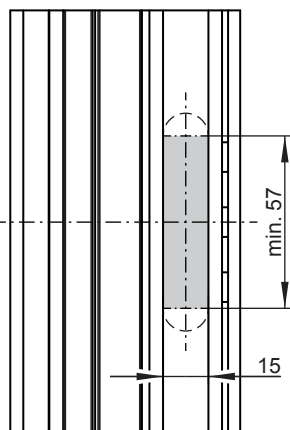

Punching tool: 6-31957-00-0

ALU-JET 10

Turn-Only windows central locking system



10. Dimensions of connecting rods – standard version

SW 200–1200

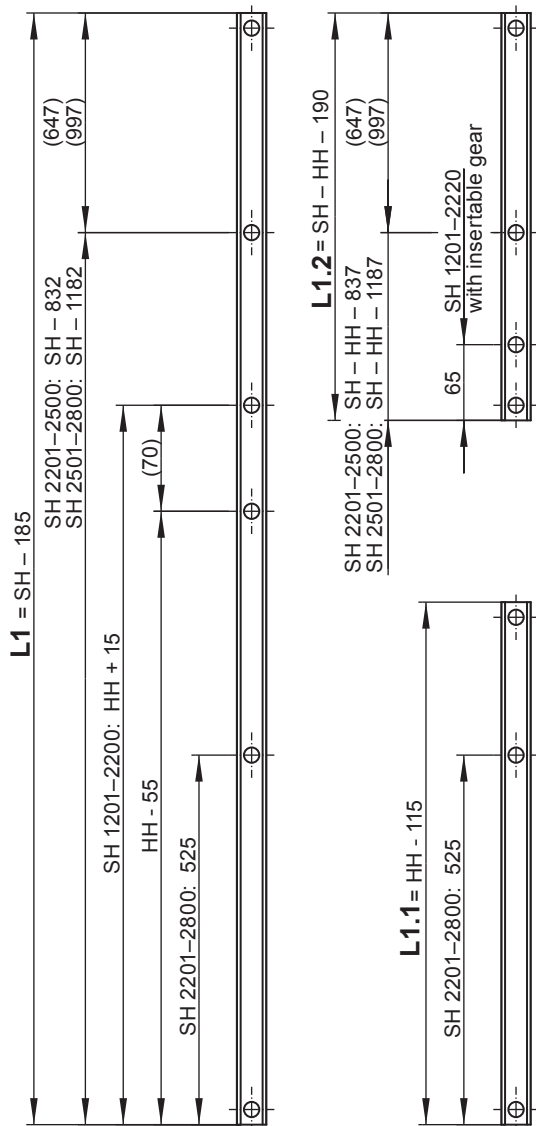

SW 1201–1700

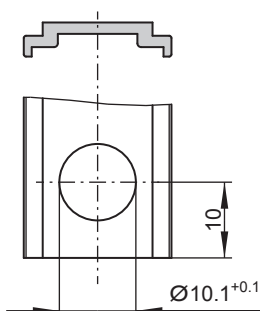
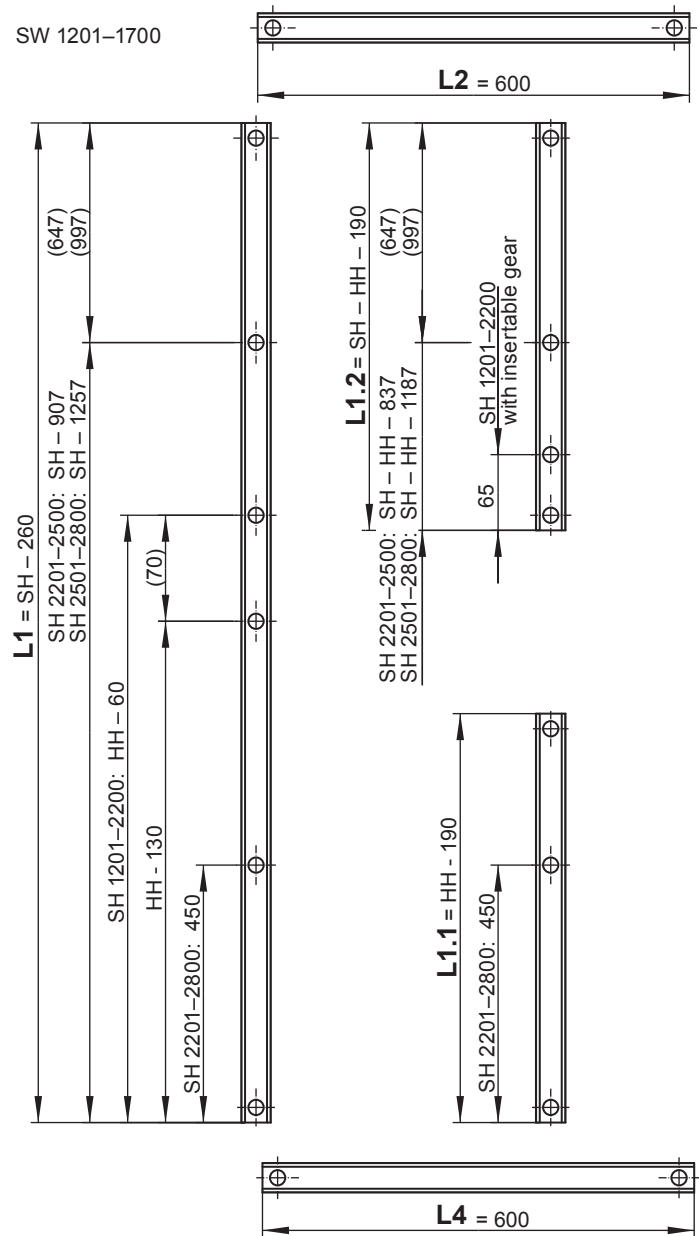

SH	HH min.	
	SW 200-1200	SW 1201-1700
410-1550	175	230
1551-2000	SH - 1320	SH - 1320
2001-2800	690	690

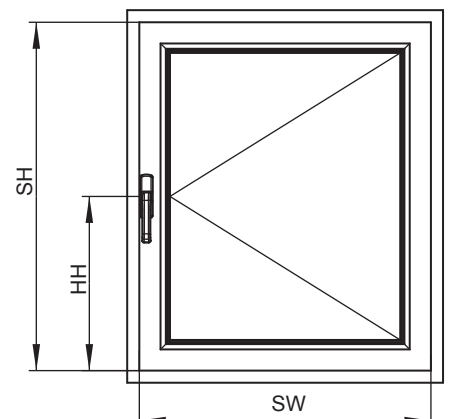

Punching tool: 6-39858-00-0
 Stop rail: 6-39859-00-0

ALU-JET 10

Turn-Only windows central locking system

11. Dimensions of connecting rods – shoot-bolt version (only frame groove 14/18)



SPACIO geared turn handle

ADAGIO-A geared turn handle

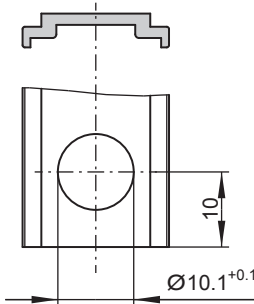
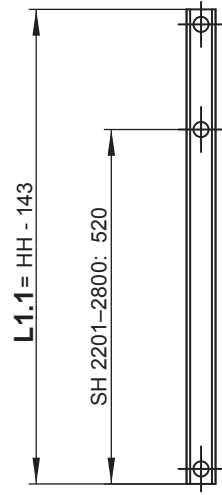
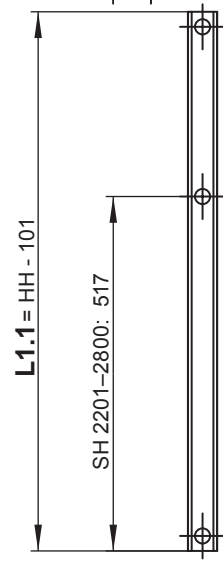
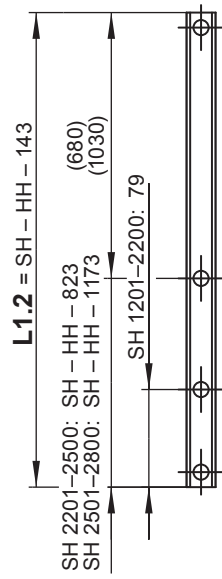
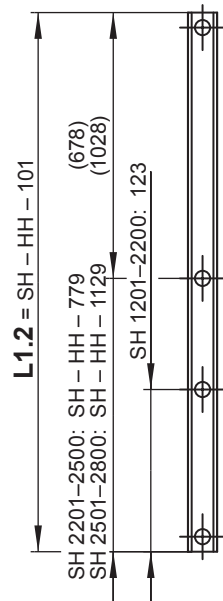

SH	HH min.	
	SPACIO	ADAGIO-A
310-1400	155	-
370-1400	-	185
1401-1900	SH - 1240	SH - 1210
1901-2800	670	700

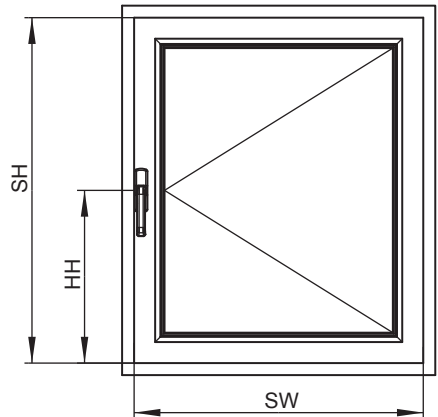

Punching tool: 6-39858-00-0
 Stop rail: 6-39859-00-0

ALU-JET 10

Turn-Only windows central locking system



12. Installation on sash

12.1 Overview – standard version

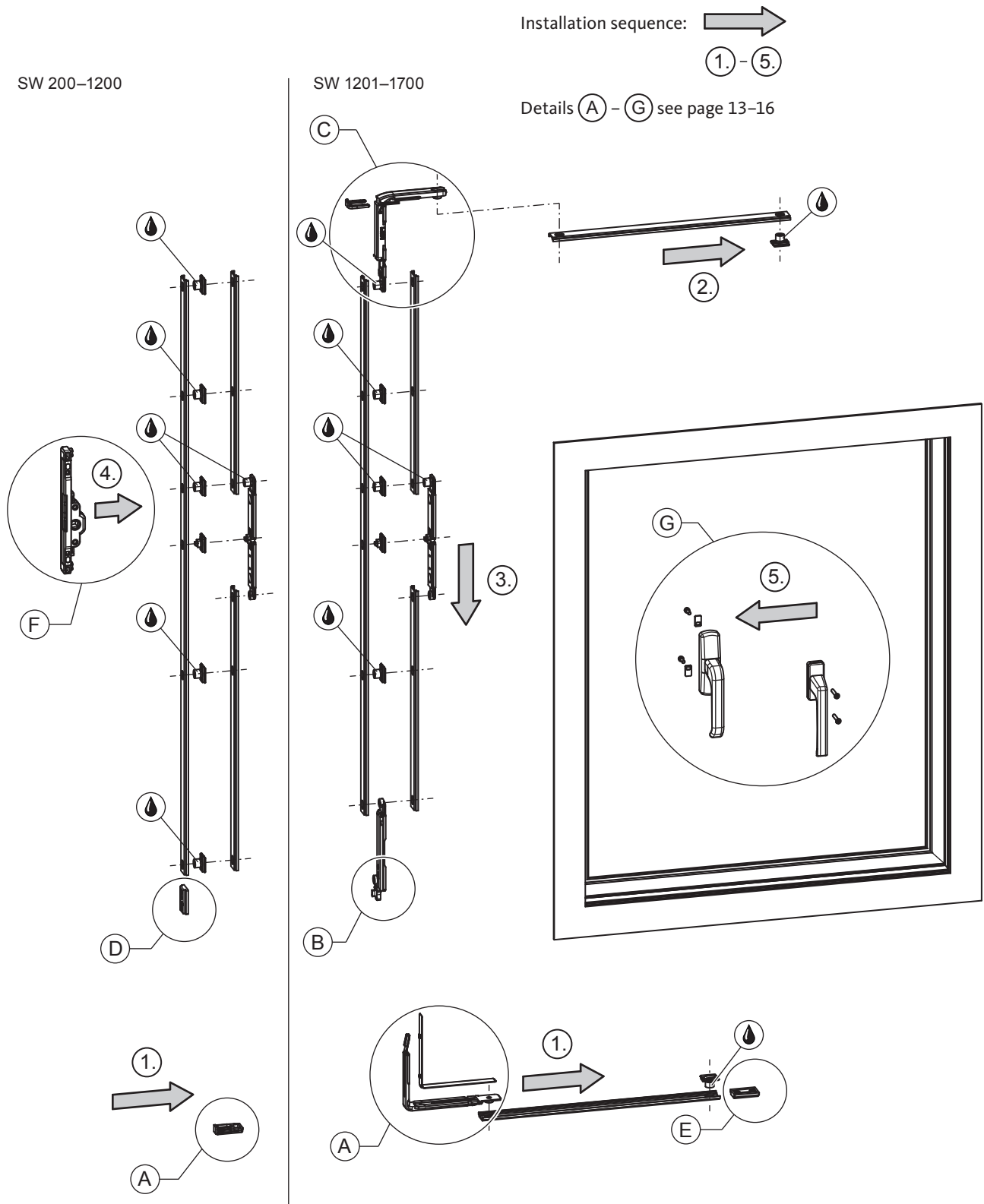

ALU-JET 10

Turn-Only windows central locking system



12.2 Overview – shoot-bolt version (only frame groove 14/18)

Installation sequence:

①.-②.

Detail (H) see page 17

SPACIO geared turn handle

ADAGIO-A geared turn handle

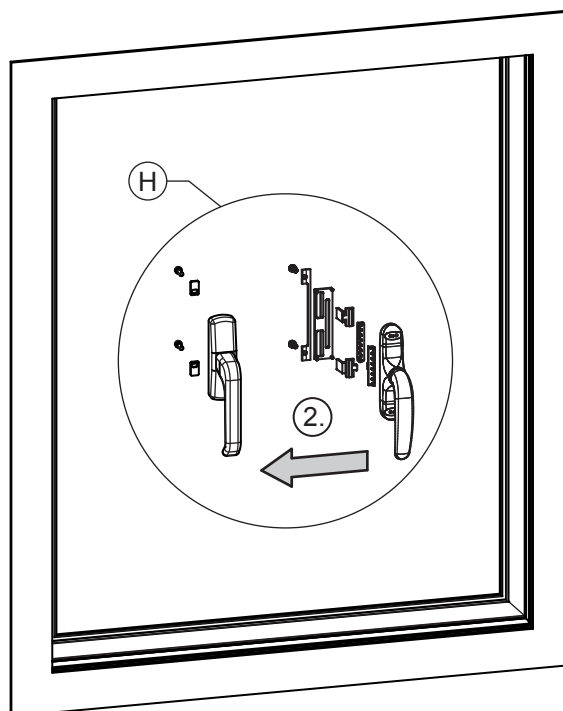
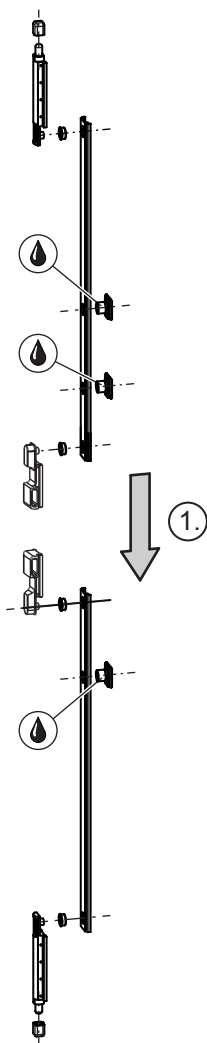
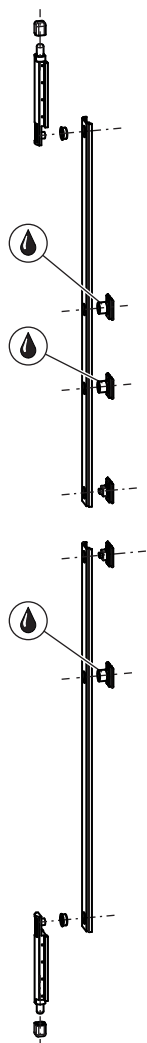

ALU-JET 10

Turn-Only windows central locking system



12.3 Details

(A) SW 200–1200

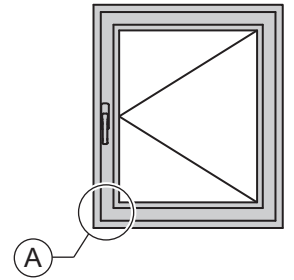
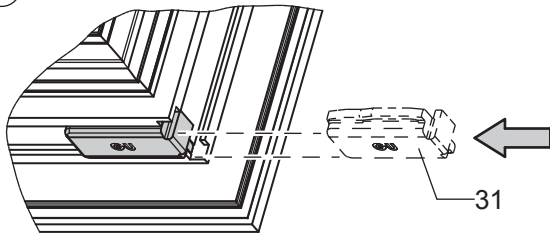

(A) SW 1201–1700

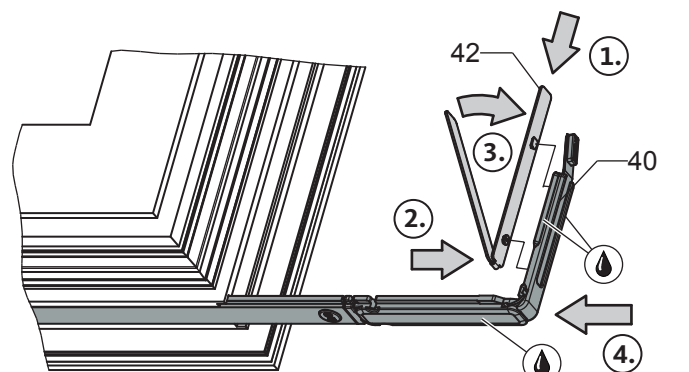
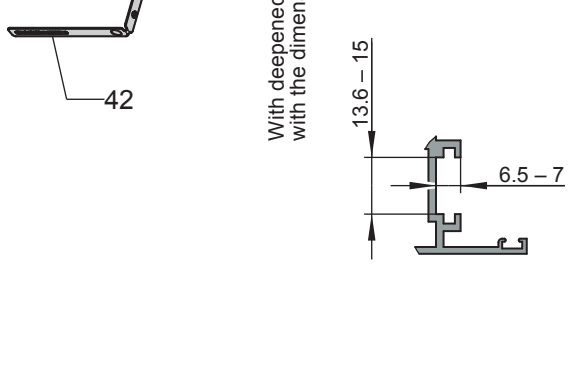
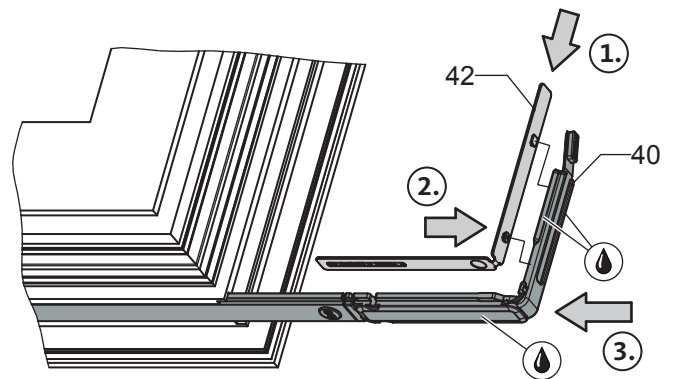
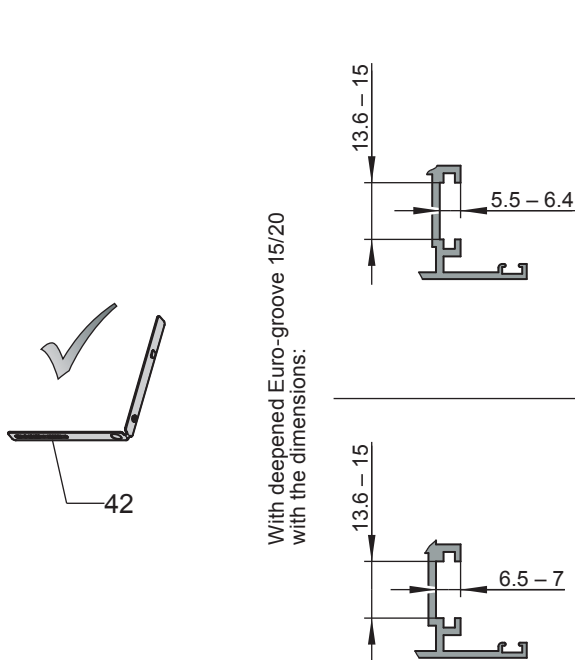
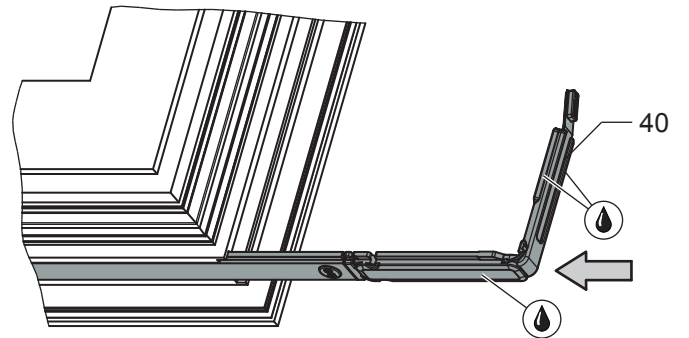
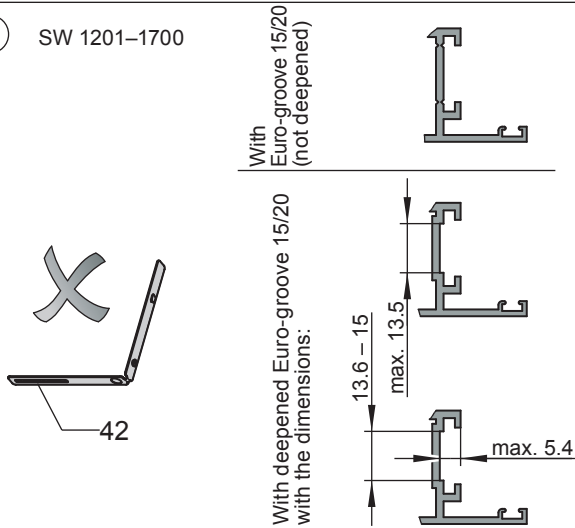

ALU-JET 10

Turn-Only windows central locking system



(B) SW 1201-1700

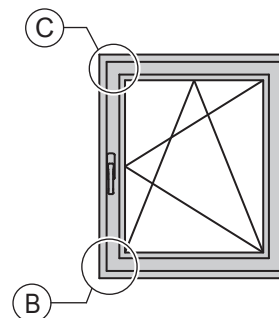
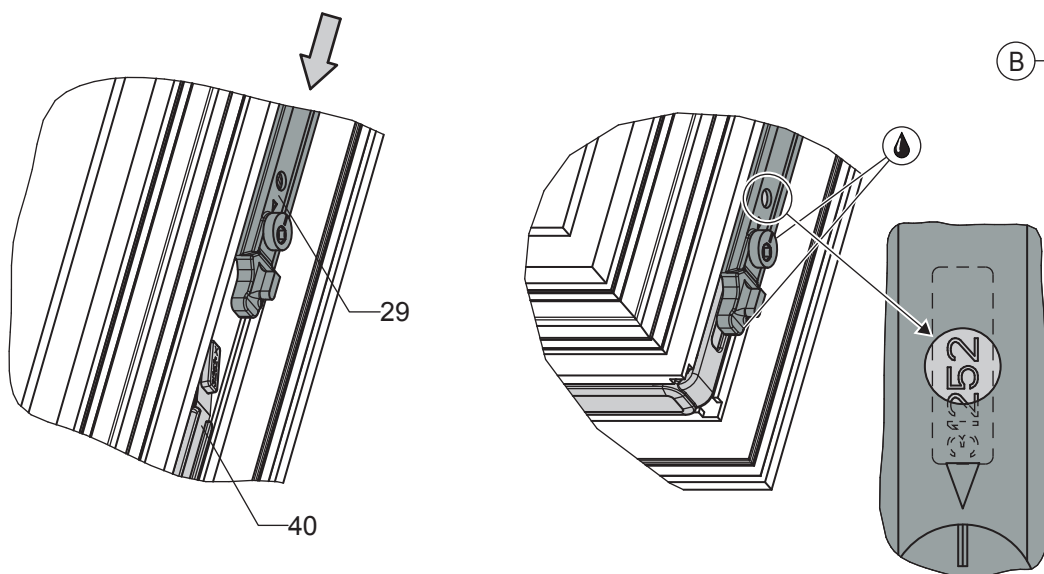

(C) SW 1201-1700

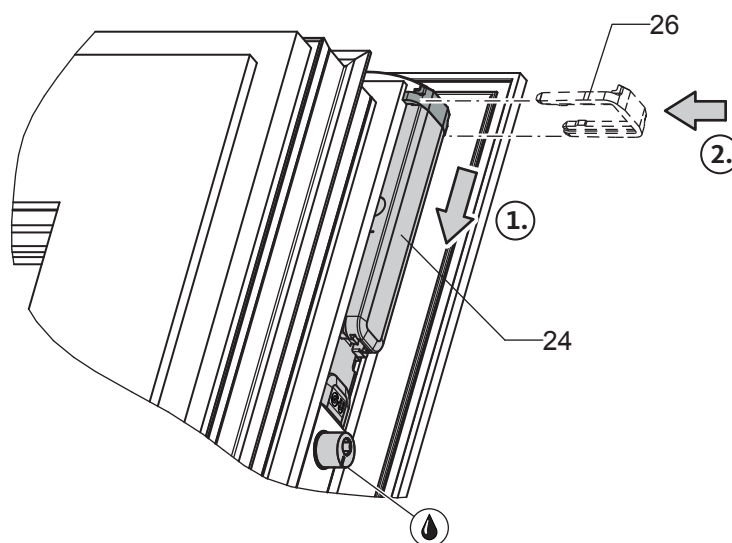

ALU-JET 10

Turn-Only windows central locking system

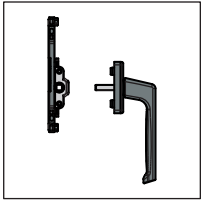

(D) SW 200–1200

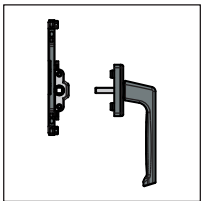
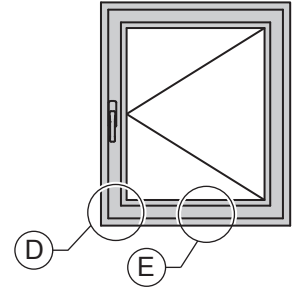
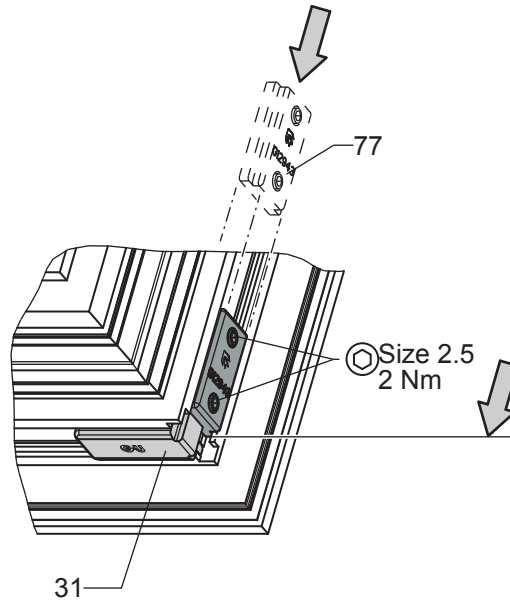

(E) SW 1201–1700

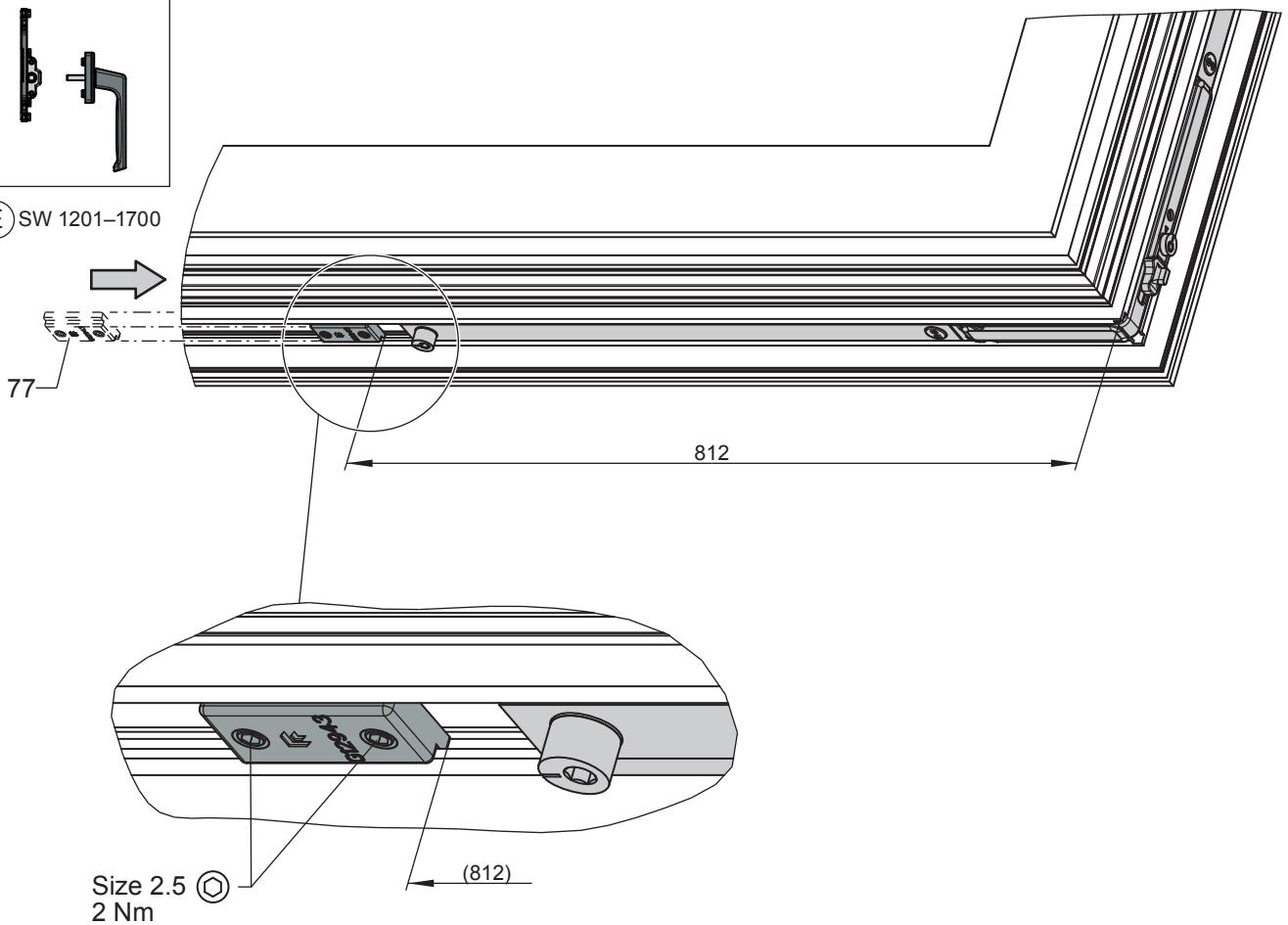

Rotate the handle from closed position to Turn-Only position and make sure that it clicks into place. Adjust the position of the 90° turn restrictor, if necessary (item 77).

ALU-JET 10

Turn-Only windows central locking system

GU

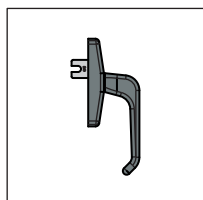

(G)

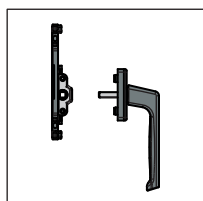
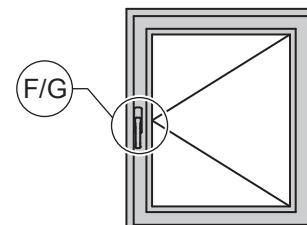
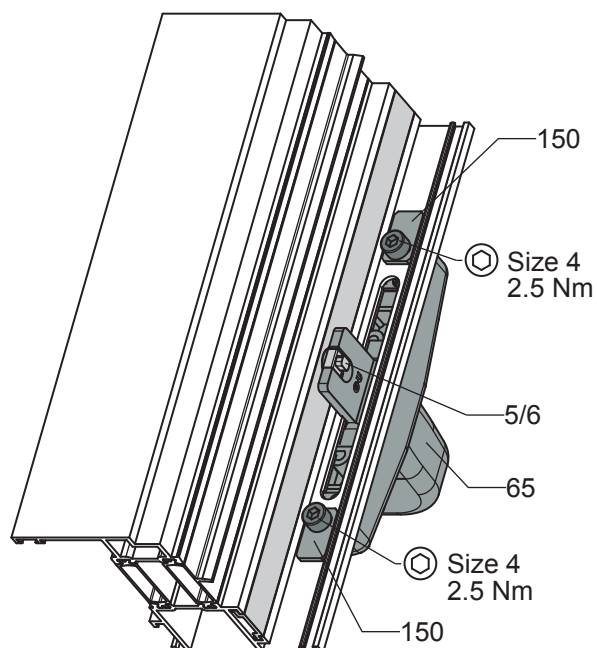

(F)

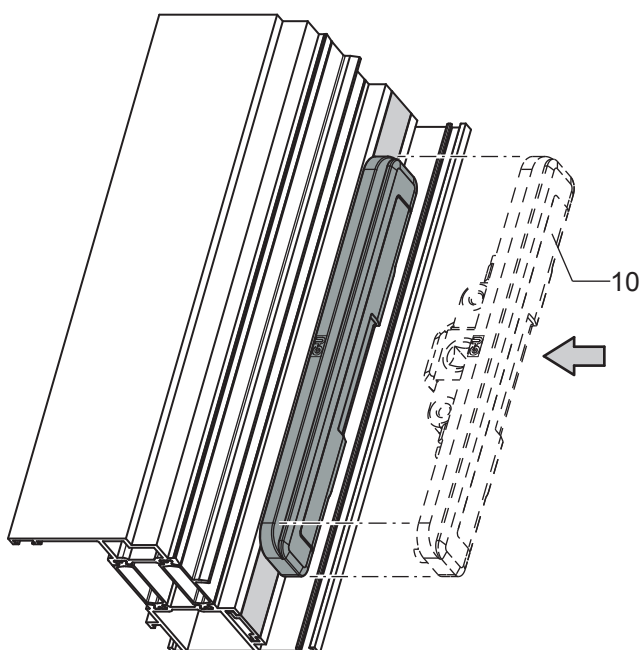

(G)

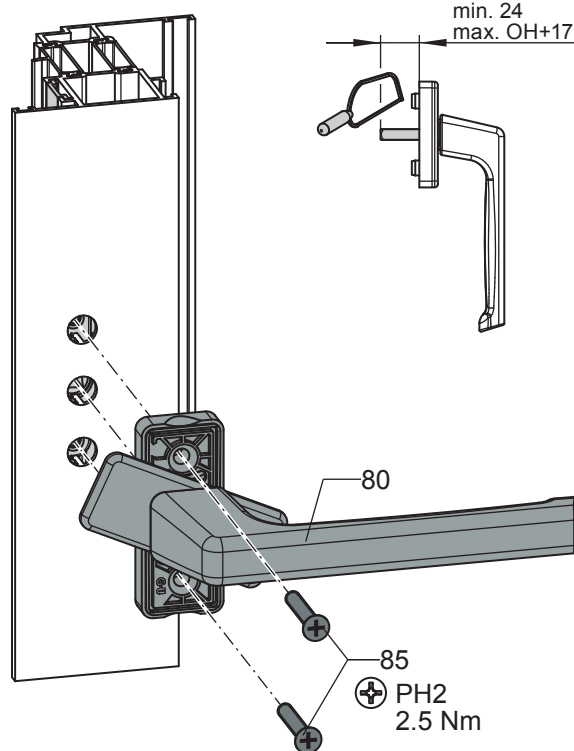

ALU-JET 10

Turn-Only windows central locking system

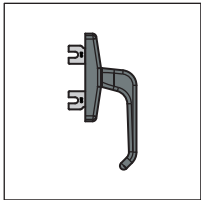

(H)

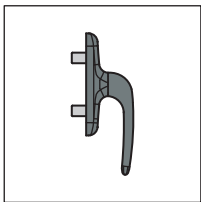
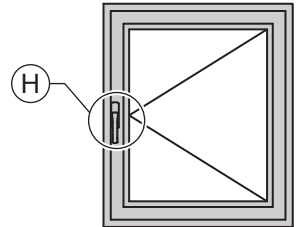
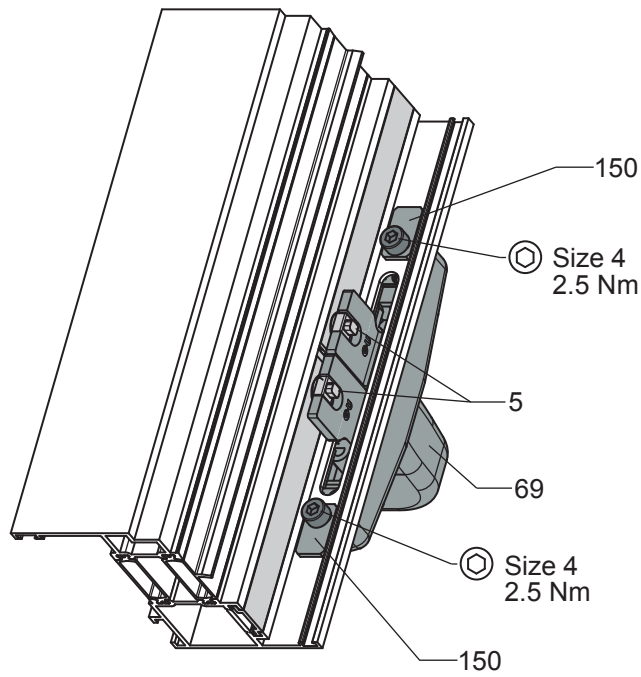

(H)

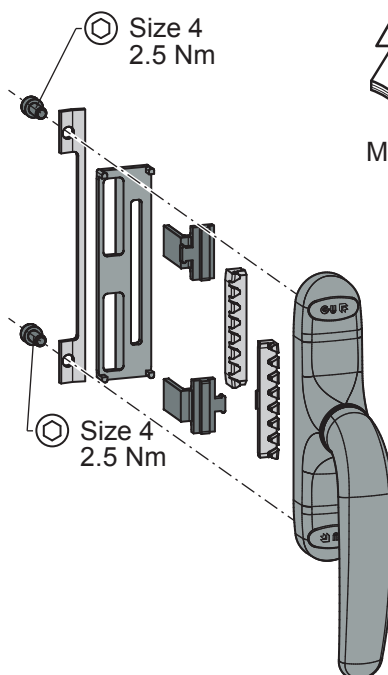

M-00079

ALU-JET 10

Turn-Only windows central locking system

13. Installation on frame – standard version



All locking screws:

⊙ Size 2.5
2 Nm

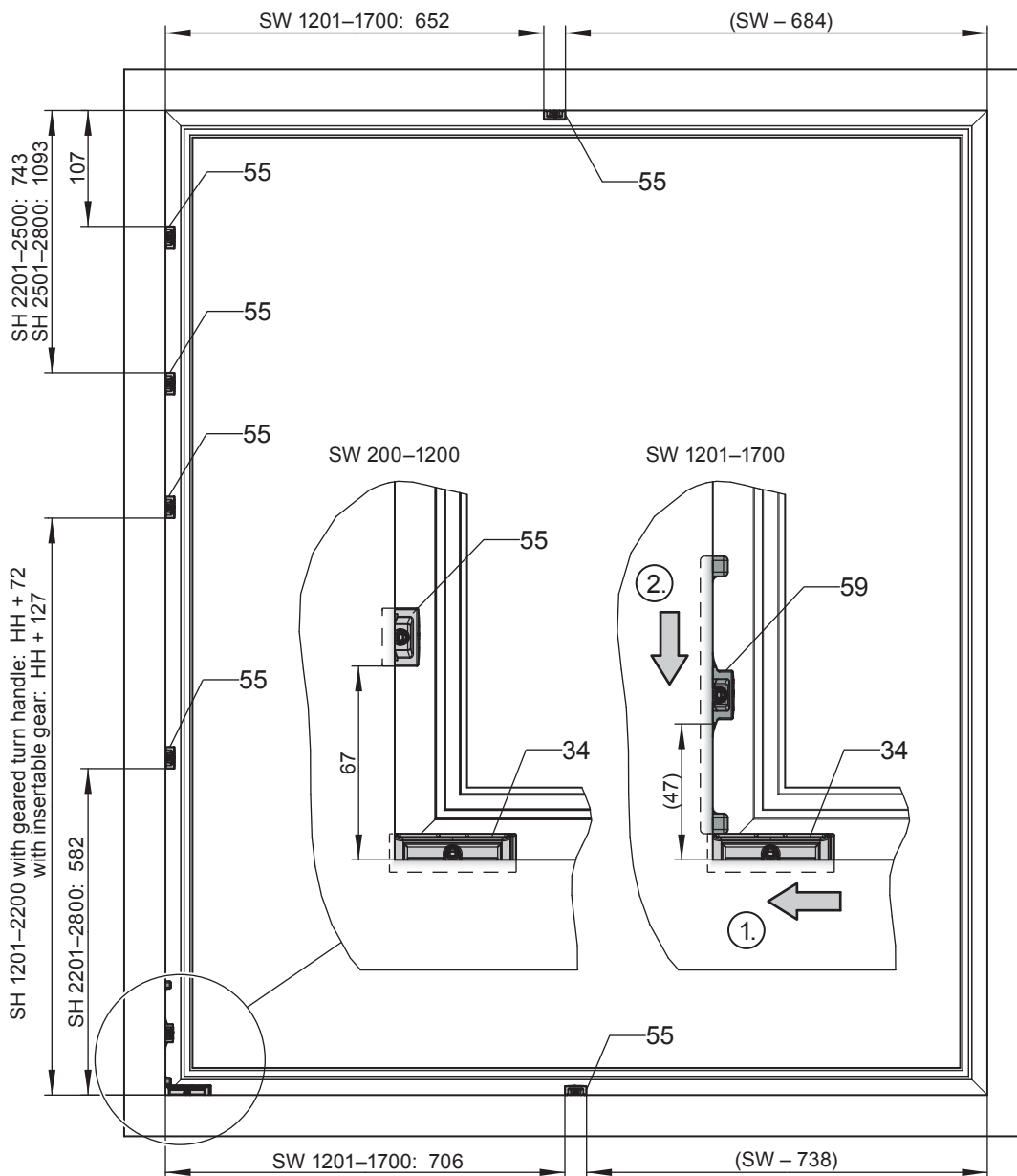
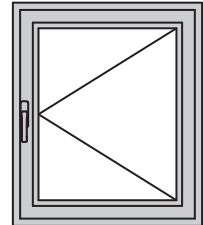
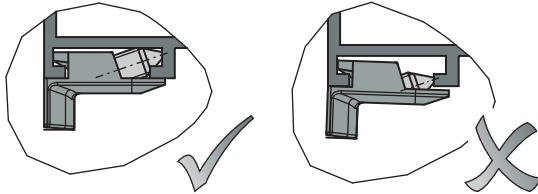

After hinging the sash:

Move the turn handle from the closed position to the Turn-Only position and make sure that the distance between striker (item 55) and locking cam (item 45) is 2 ± 1 mm.

Adjust the position of the striker, if necessary.

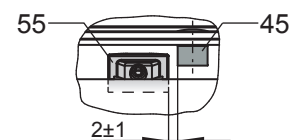

ALU-JET 10

Turn-Only windows central locking system



14. Installation on frame – shoot-bolt version (only frame groove 14/18)

Locking screws:

- ⊕ Size 2.5
- 2 Nm

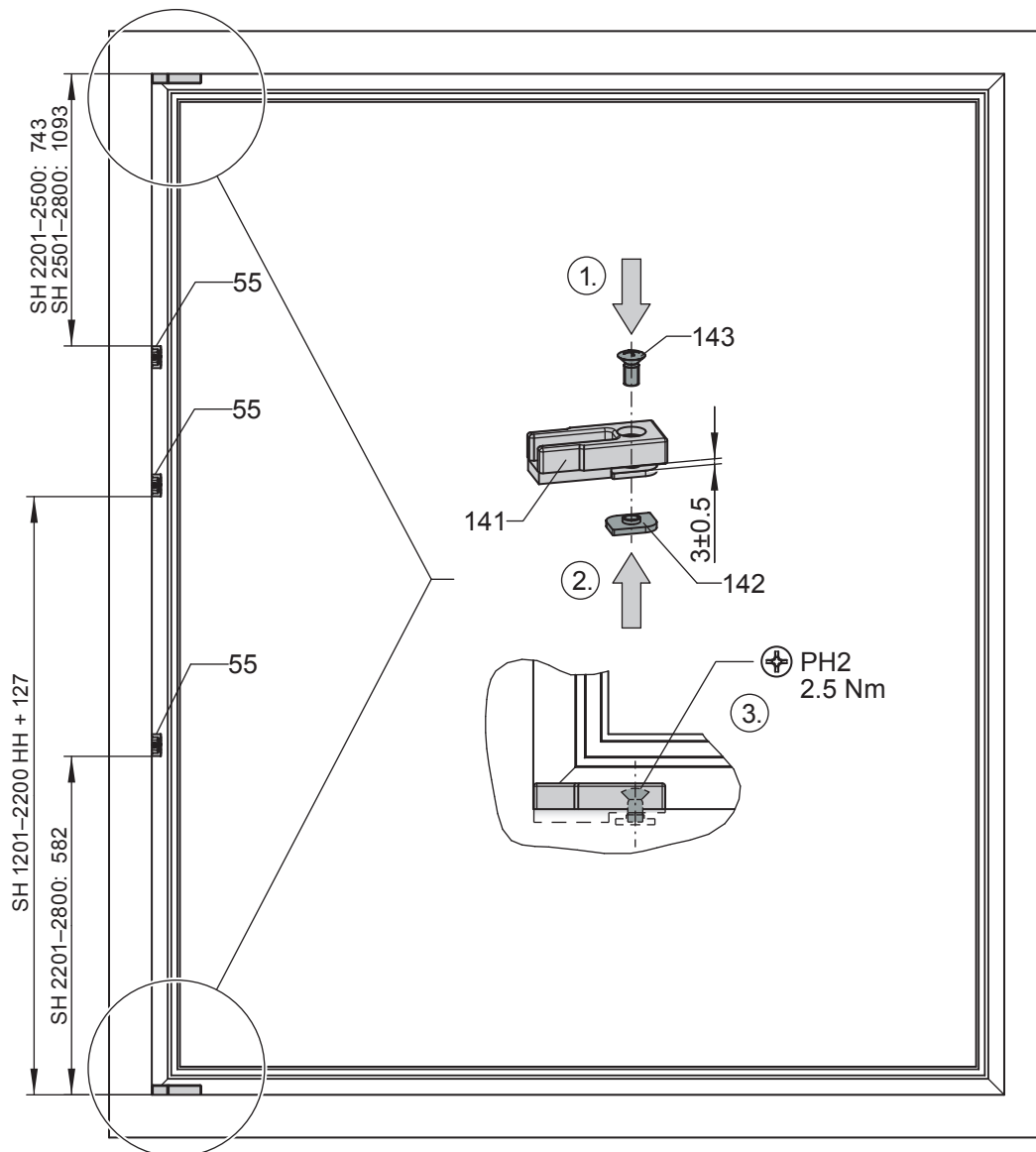
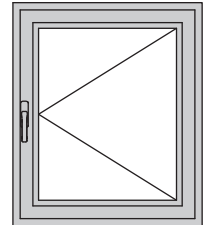
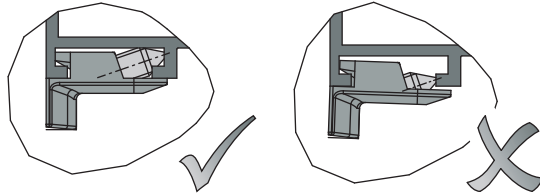

After hinging the sash:

Move the turn handle from the closed position to the Turn-Only position and make sure that the distance between striker (item 55) and locking cam (item 45) is 2 ± 1 mm.

Adjust the position of the striker, if necessary.

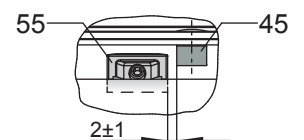

15. Adjustments

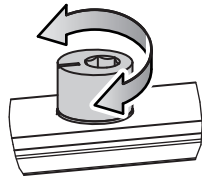

Gasket pressure adjustment ± 1 mm
 Ⓞ Size 4
 at corner-drive, T&T tilter and locking cam

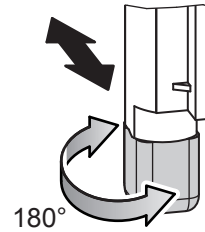

Gasket pressure adjustment by 0.5 mm at the connecting-rod shoot-bolt

NOTE

Grease the locking points and sliding points with an acid-free lubricant which is not prone to gumming.

16. Disassembly and disposal

Disassembly

To disassemble the hardware, follow the assembly sequence in reverse order, except for item 29.

Disassemble item 29 as follows:

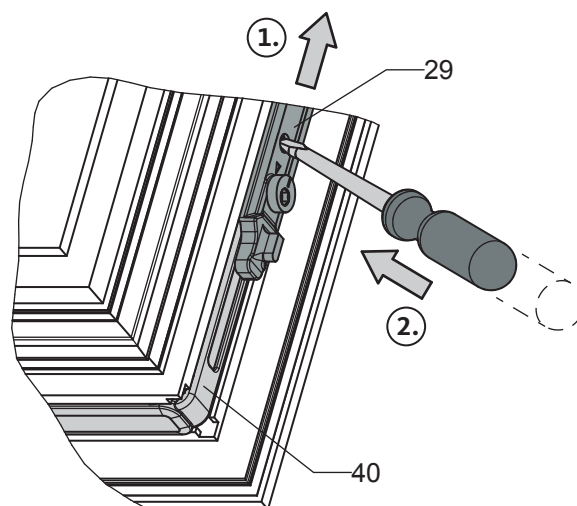
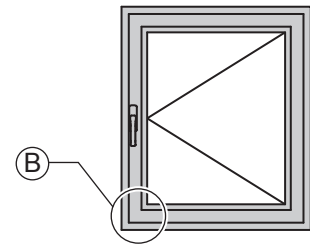

Disposal

Dispose of the product according to statutory rules and regulations.

Editor:
 Gretsch-Unitas GmbH
 Baubeschlage
 Johann-Maus-Str. 3
 71254 Ditzingen, Germany
 Tel. +49 7156 301-0
 Fax +49 7156 301-293
 www.g-u.com