





03.5

SECURY Automatic Smart Access Controlled Wire & Connection Diagrams

Quick Start Guide	03.5.3
Wire Diagrams - Option 1	
Cable Duct	03.5.4
Wire Diagrams - Option 2	
SECUREconnect 200	03.5.5
Wire Diagrams - Option 3 – DOOR LEAF MOUNTED	
SECUREconnect 200 & Code Keypad/Fingerprint Scanner	03.5.6
Wire Diagrams - Option 4 – WALL MOUNTED	
SECUREconnect 200 & Code Keypad/Fingerprint Scanner	03.5.7
Wire Diagrams - Option 5	
SECUREconnect 200 & Universal Module	03.5.8
Wire Diagrams - Option 6 – DOOR FRAME MOUNTED	
SECUREconnect 200 & Code Keypad/Fingerprint Scanner	03.5.9
Wire Diagrams - Option 7	
Cable Duct & Universal Module	03.5.10
Assembly and Operating Instructions	03.5.11
Trouble Shooting	03.5.16



Door manufacturer

1. Make sure you can manually open and close the door from the interior using either the profile cylinder knob, or interior operating handle before installing the access control system
2. Follow the correct wire diagram from this document
3. After installing the access control system, **make sure to test the system before shipping** it to site:
 - Connect a 24V DC power supply to the system 
 - Press the buttons 0 + OK on the remote or 0 +  on the keypad
 - If using a Secure Connect, try activating the lock by bridging V4/93 on Secure Connect 200R
 - Check that the three LED (green/blue/red) are lit up on the keypad/fingerprint scanner
4. Identify all the outside wiring before shipping it to site
(Wiring that will be connected to power supply or any 3rd party access control on site)
5. If a third party is doing the installation of the door or the access control system, make sure to send this document

Door installer

6. After the installation of the door, the outside wiring needs to be accessible for the access control installer to complete the job
7. The insulation foam must not cover the Secure Connect 200R

Access control installer

8. Follow the correct installation diagram from this document
9. Power supply used must be stabilized 24V DC with minimum 1,3A



Any difference in voltage may cause malfunction and damage the system!

* Do not install the SECUREconnect if conditions require a higher protection class than IP 40

Wire Diagrams – Option 1

SECURY Automatic, A-opener, Cable Duct, 24V DC

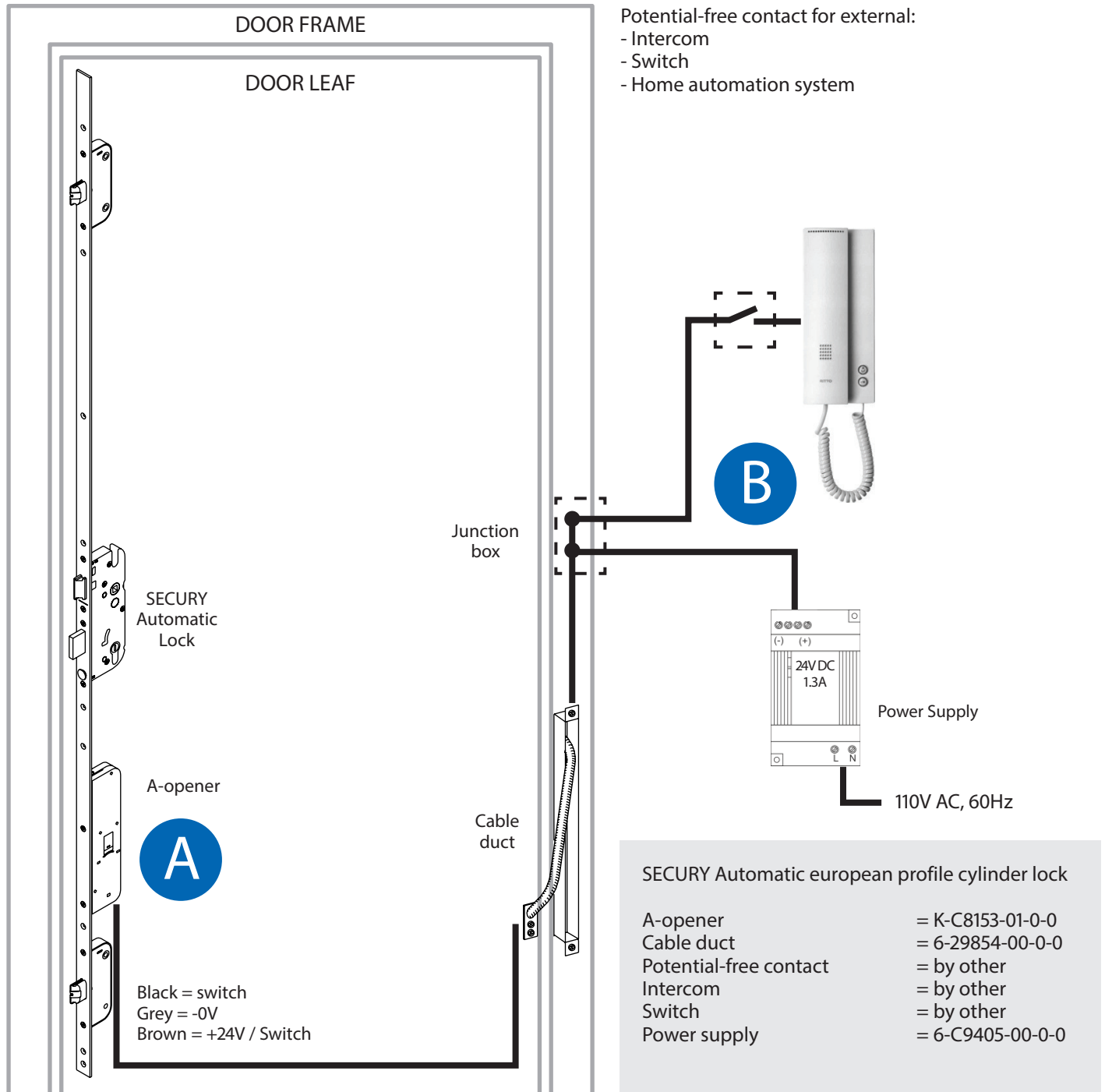

Wire Diagrams – Option 2

SECURY Automatic, A-opener, SECUREconnect 200, 24V DC

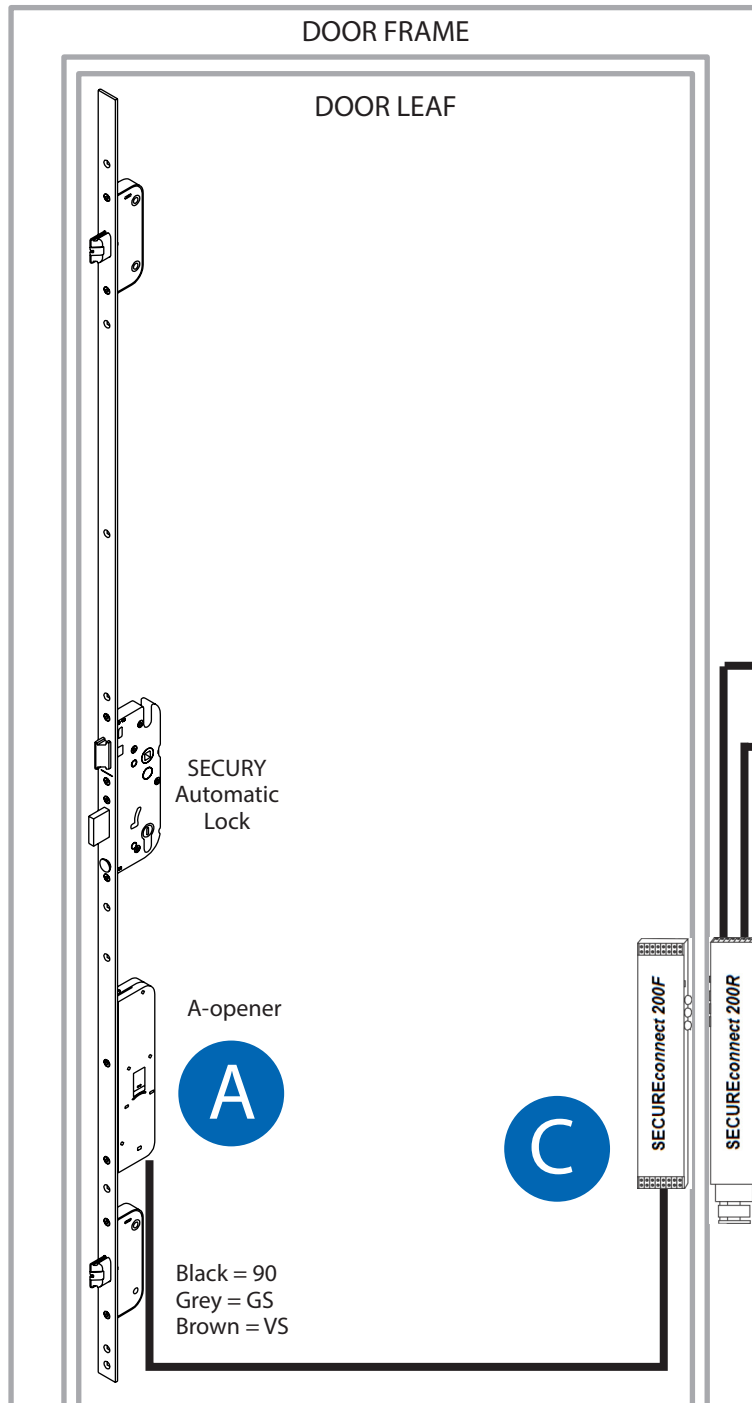

Potential-free contact for external:

- Intercom
- Switch
- Access control

Term.: V4 / 93
(short term open)

Term.: V42(+) / G42(-)

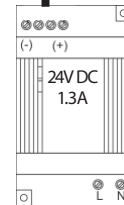

Power Supply

110V AC, 60Hz

SECURY Automatic european profile cylinder lock

A-opener	= K-C8153-01-0-0
SECUREconnect 200	= K-C5560-20-4-6
Faceplate for SECUREconnect (2 required)	= 9-C4793-XX-0-8B
Potential-free contact	= by other
Intercom	= by other
Switch	= by other
Access control	= by other
Power supply	= 6-C9405-00-0-0

* Do not install the SECUREconnect if conditions require a higher protection class than IP 40

Wire Diagrams – Option 3

SECURY Automatic, A-opener, SECUREconnect 200, Code Keypad/Fingerprint Scanner, 24V DC



DOOR LEAF MOUNTED

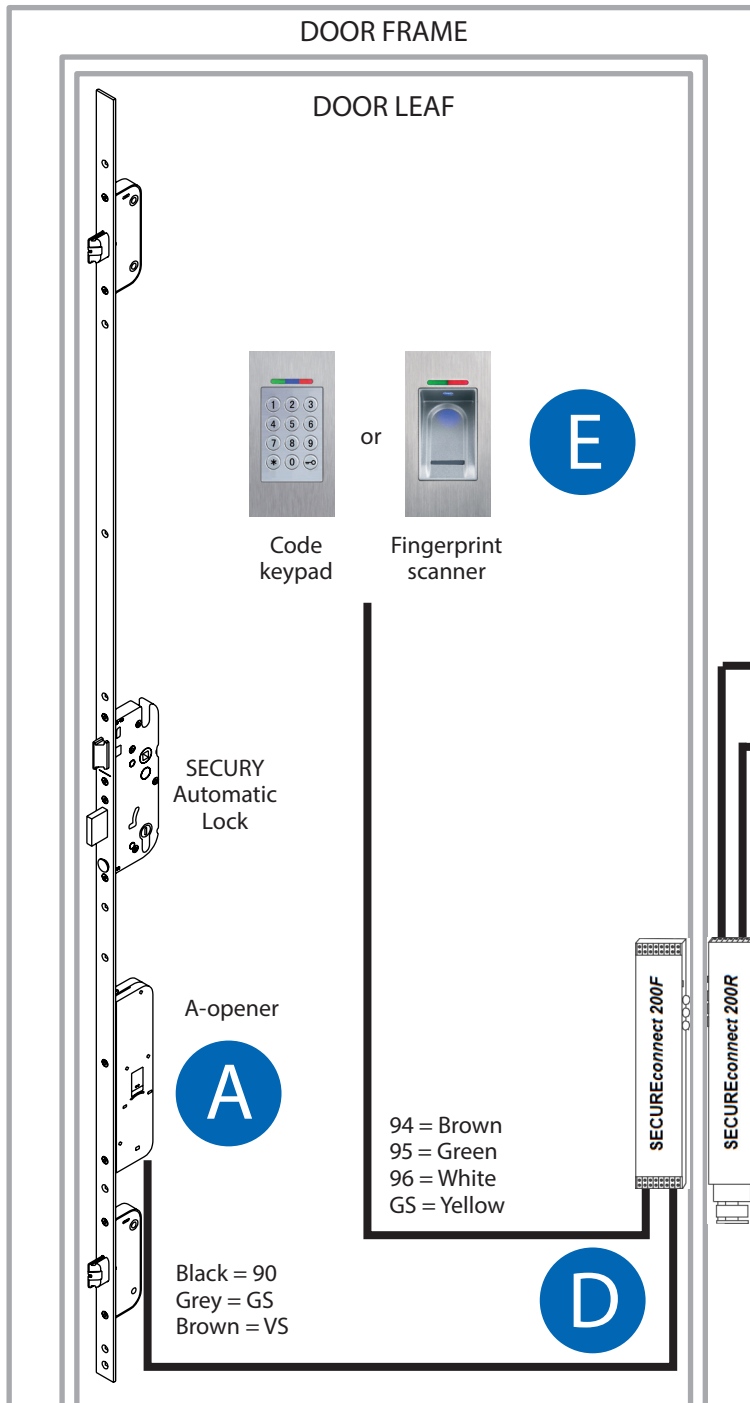

Potential-free contact for external:
- Intercom
- Switch

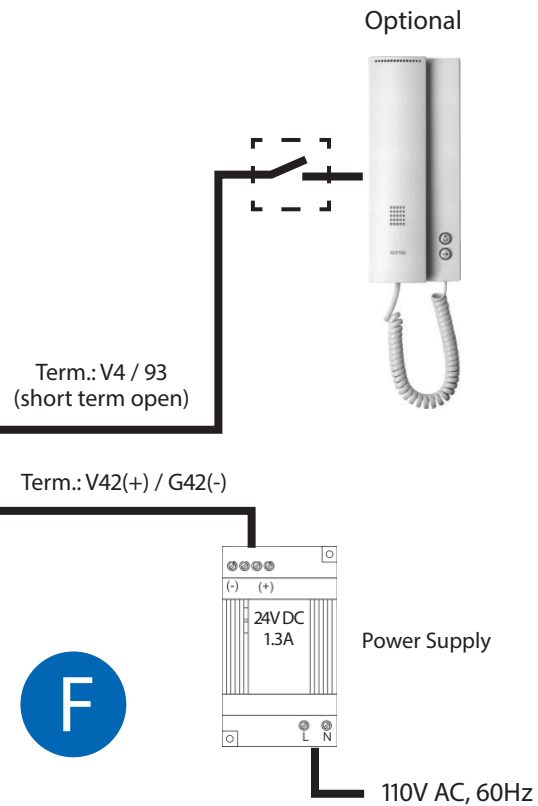

Code keypad kit	= K-C1440-51-0-0
Fingerprint scanner kit	= K-C1440-01-0-0
SECURY Automatic european profile cylinder lock	
Faceplate for SECUREconnect (2 required)	= 9-C4793-XX-0-8B
Potential-free contact	= by other
Intercom	= by other
Switch	= by other
Power supply	= 6-C9405-00-0-0

* Do not install the SECUREconnect if conditions require a higher protection class than IP 40

Wire Diagrams – Option 4

SECURY Automatic, A-opener, SECUREconnect 200, Code Keypad or Fingerprint Scanner, 24V DC



WALL MOUNTED

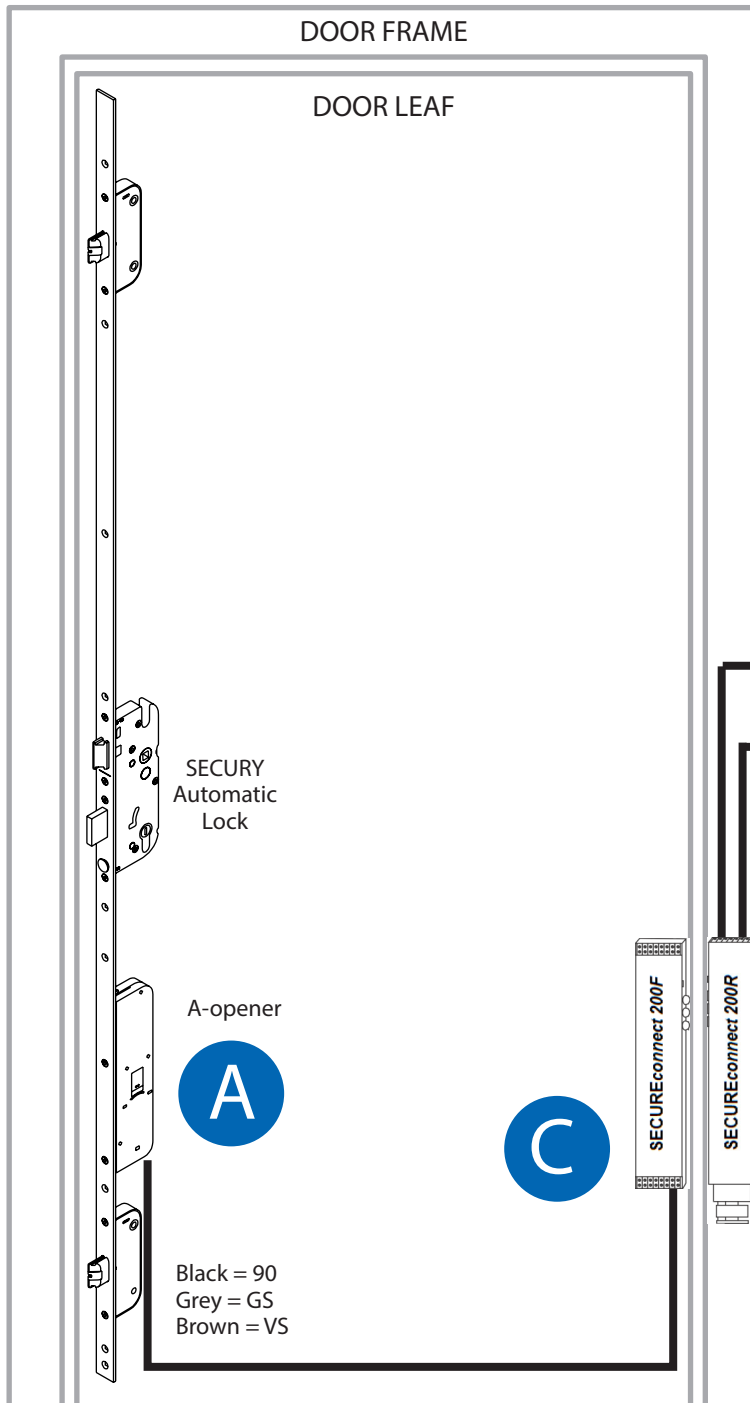

Potential-free contact for external:

- Intercom
- Switch

Optional

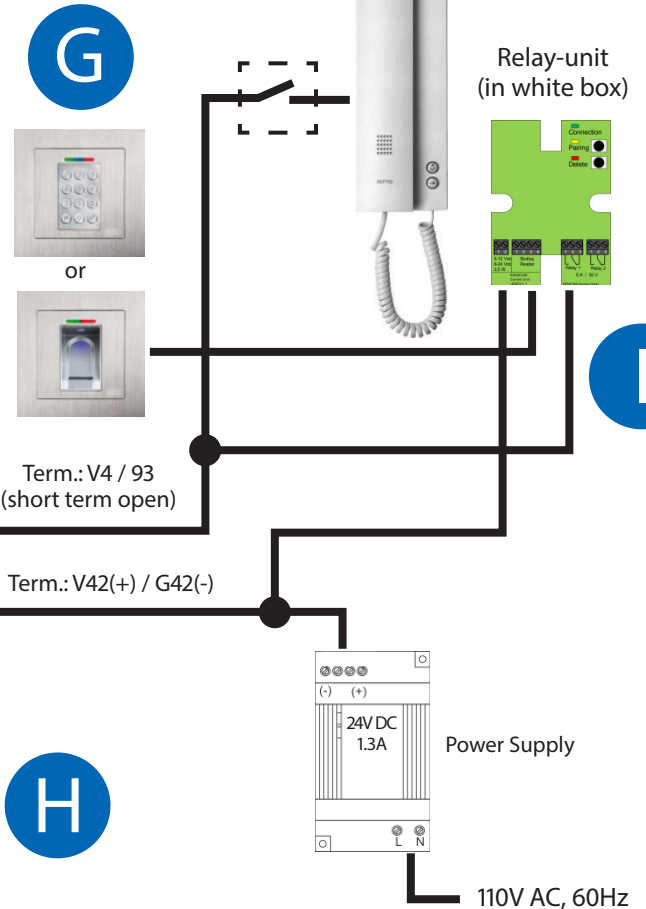

03
5

Code keypad kit	= K-C1440-73-0-0
Fingerprint scanner kit	= K-C1440-61-0-0
SECURY Automatic european profile cylinder lock	
Faceplate for SECUREconnect	= 9-C4793-XX-0-8B (2 required)
Potential-free contact	= by other
Intercom	= by other
Switch	= by other
Power supply	= 6-C9405-00-0-0

* Do not install the SECUREconnect if conditions require a higher protection class than IP 40

Wire Diagrams – Option 5

SECURY Automatic, A-opener, SECUREconnect 200, Universal Module, 24V DC



Smartphone with Danalock app.

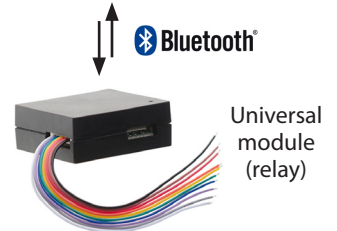

Module	SC 200R
Green	V4
Blue	93

Module	Power Supply
Grey	+24V
White	Ground

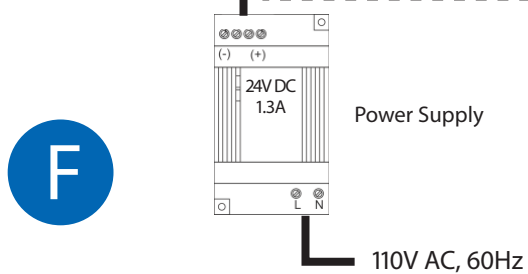
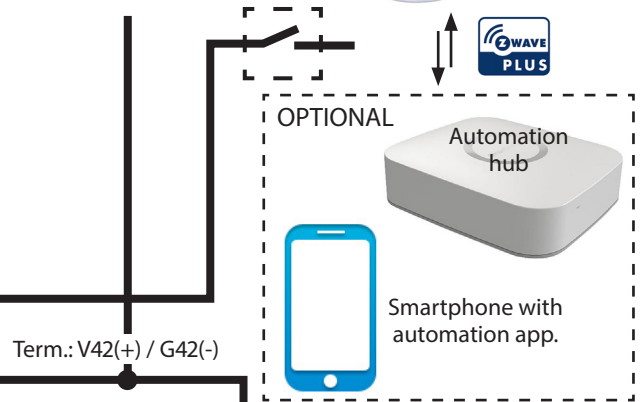
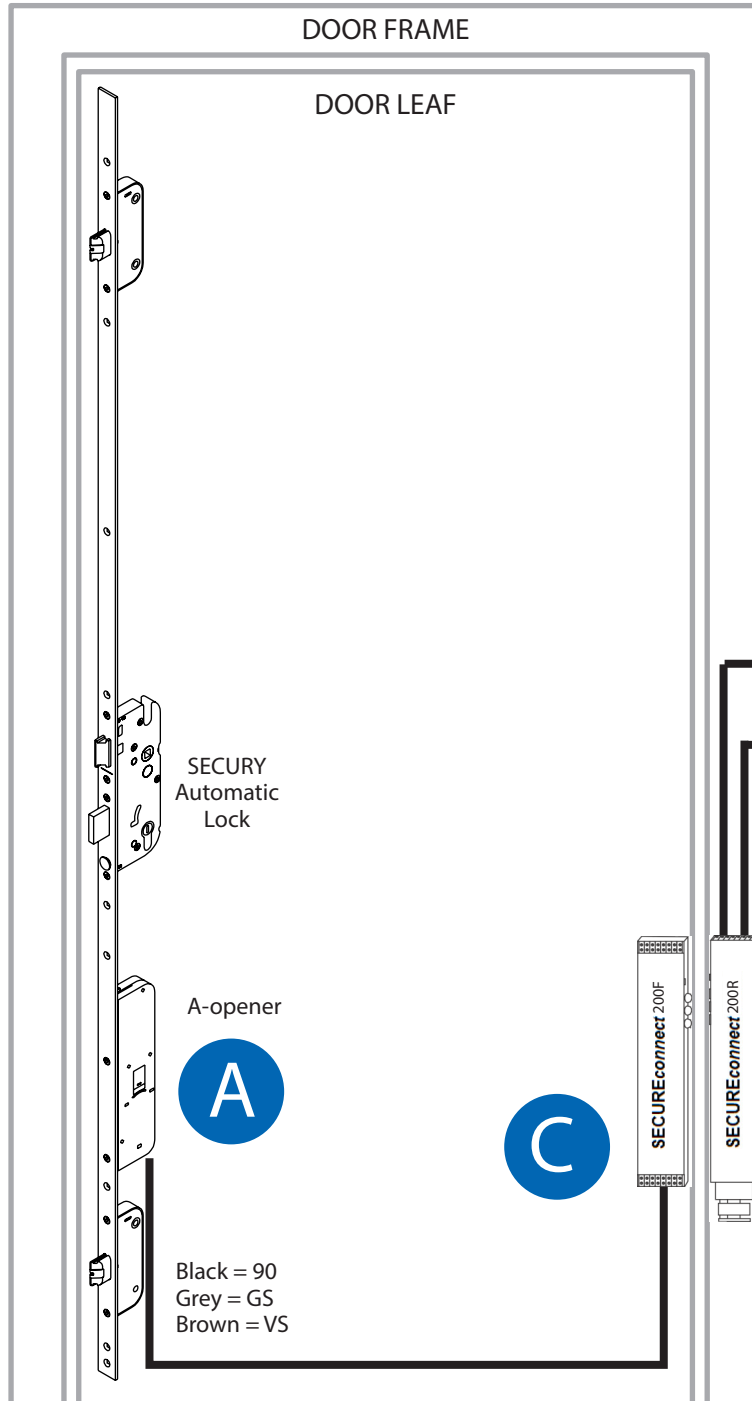

SECURY Automatic european profile cylinder lock	
Universal module	= 6-C9403-00-0-0
A-opener	= K-C8153-01-0-0
SECUREconnect 200	= K-C5560-20-4-6
Faceplate for SECUREconnect (2 required)	= 9-C4793-XX-0-8B
Automation system	= by other
Potential-free contact	= by other
Intercom	= by other
Switch	= by other
Access control	= by other
Power supply	= 6-C9405-00-0-0

* Do not install the SECUREconnect if conditions require a higher protection class than IP 40

Wire Diagrams – Option 6

SECURY Automatic, A-opener, SECUREconnect 200, Code Keypad or Fingerprint Scanner, Cable Relay -6, 24V DC



DOOR FRAME MOUNTED

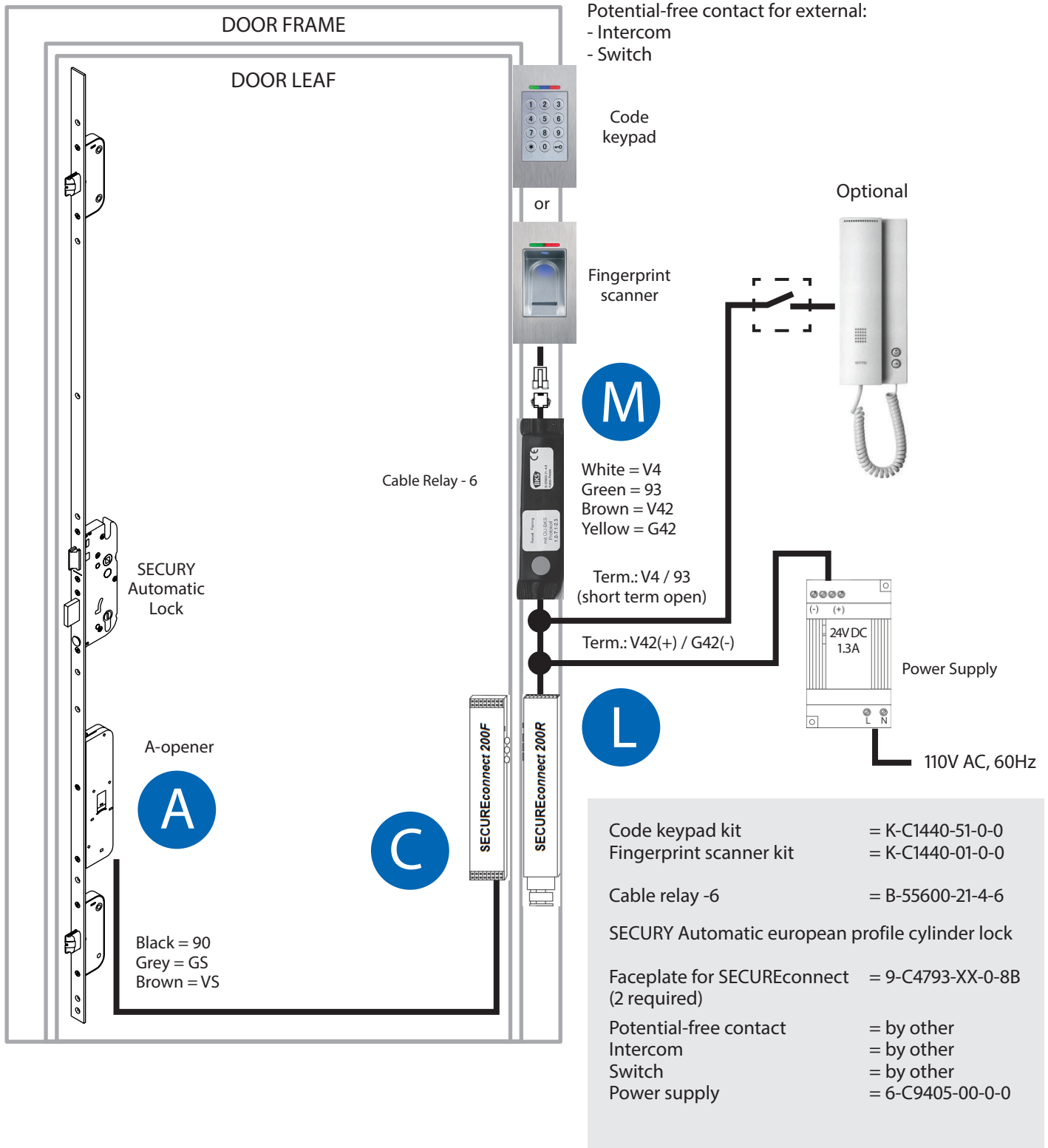

03
5

* Do not install the SECUREconnect if conditions require a higher protection class than IP 40

Wire Diagrams – Option 7

SECURY Automatic, A-opener, Cable Duct, Universal Module, 24V DC



Smartphone with Danalock app.

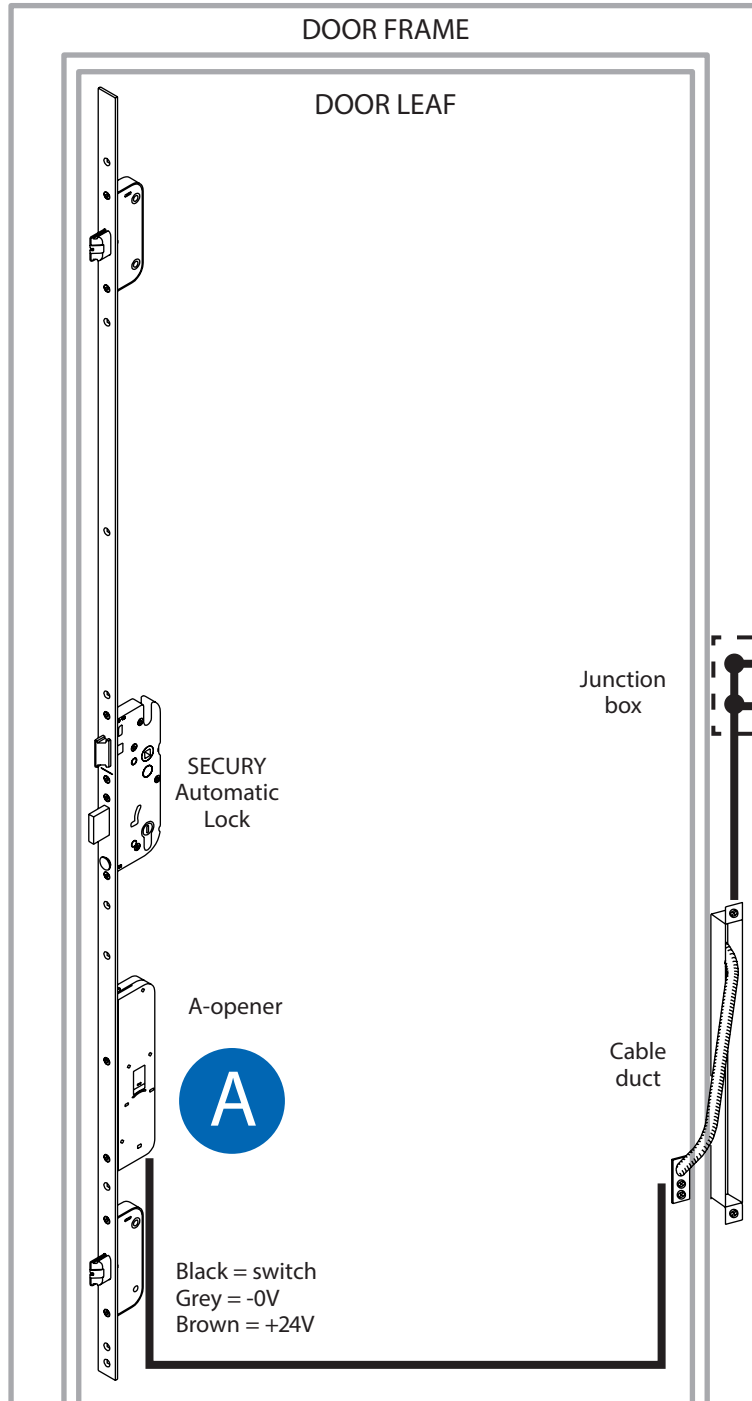

Module	A-opener
Green	Brown
Blue	Black

Module	Power Supply
Grey	+24V
White	Ground

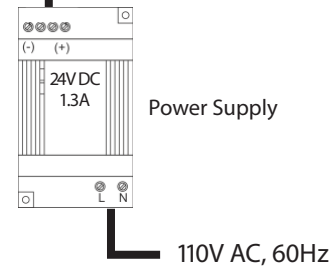
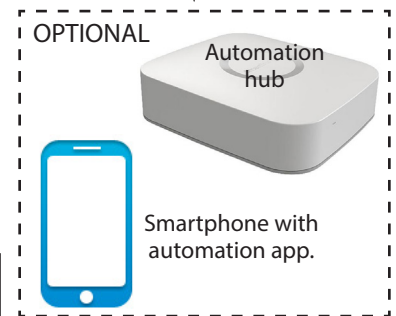
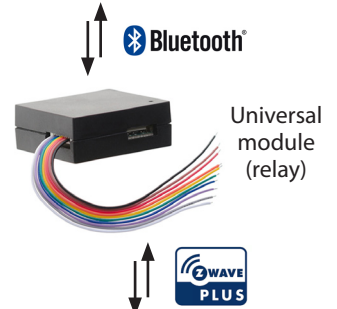

SECURY Automatic european profile cylinder lock

- Universal module = 6-C9403-00-0-0
- A-opener = K-C8153-01-0-0
- Cable duct = 6-29854-00-0-0
- Potential-free contact = by other
- Intercom = by other
- Switch = by other
- Power supply = 6-C9405-00-0-0

Assembly and Operating Instructions

GU-SECURY Automatic with A-opener – Technical Data Sheet



Function

- The locked door can be released by a pulse given to the door release input (potential-free contact).
- The motor retracts the automatic latchbolts, which is acknowledged by two audible signals, and after approx. 2 seconds releases them again. Thus, the lock is prepared again for automatic locking after the door has been pulled or pushed shut.
- With continuous contacting on the door release input, the automatic latchbolts of the lock remain retracted until the contact is open again. This functioning principle allows for release over a longer time period by means of a switch or a timer switch.



Attention:

The operating mode "PERMANENT OPEN" is not permitted on fire or smoke protection doors!

If a motor-driven lock is used on a fire or smoke door, it is necessary to ensure (e.g. by means of UPS = uninterruptible power supply) that there is always sufficient energy to extend the latchbolts into locking position even in the event of a power failure. With the use of SECUREconnect, this requirement is fulfilled.

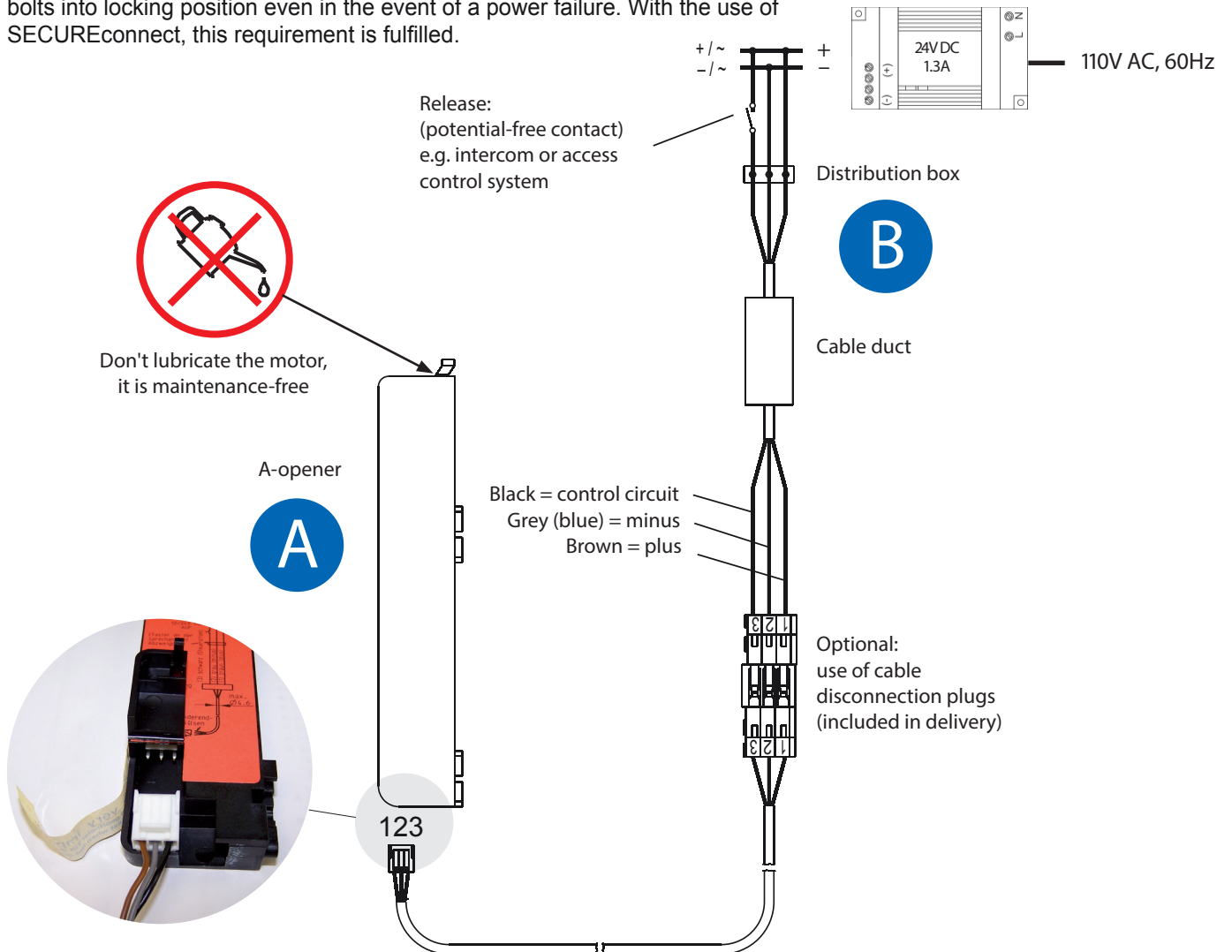

Assembly and Operating Instructions

A-opener, SECUREconnect 200 – Connection Diagram



Connection diagram SECURY Automatic with A-opener (leaf-side)
 Impulse-controlled door opening time approx. 2s (cannot be adjusted).
 Permanent door opening time corresponds to duration of control signal.

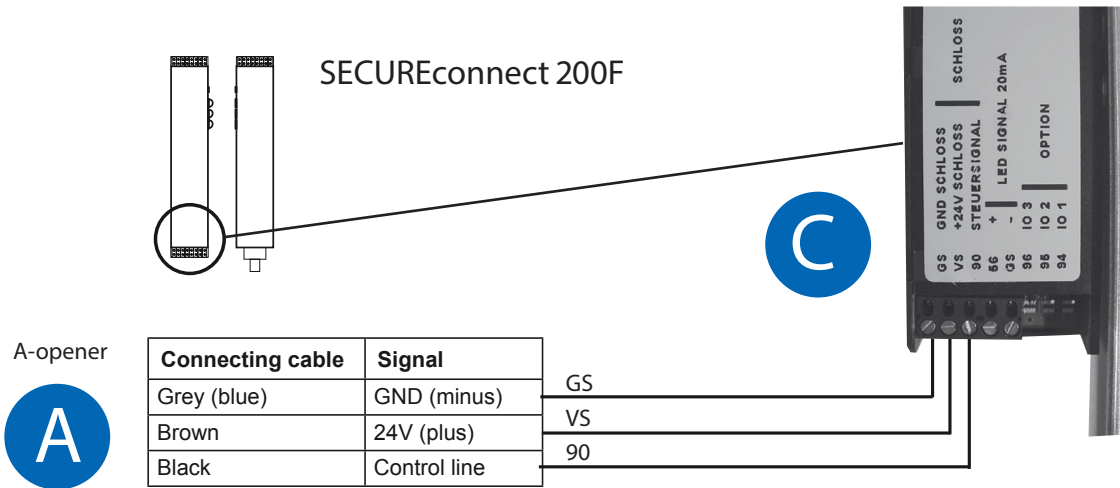

Connection terminals of SECUREconnect 200R (frame-side)
 The terminals V42 and G42 are provided for the connection of an external
 24V DC voltage supply to operate SECUREconnect 200.

Attention:
 Only 24V DC voltage sources in accordance
 with EN 60950 may be used.

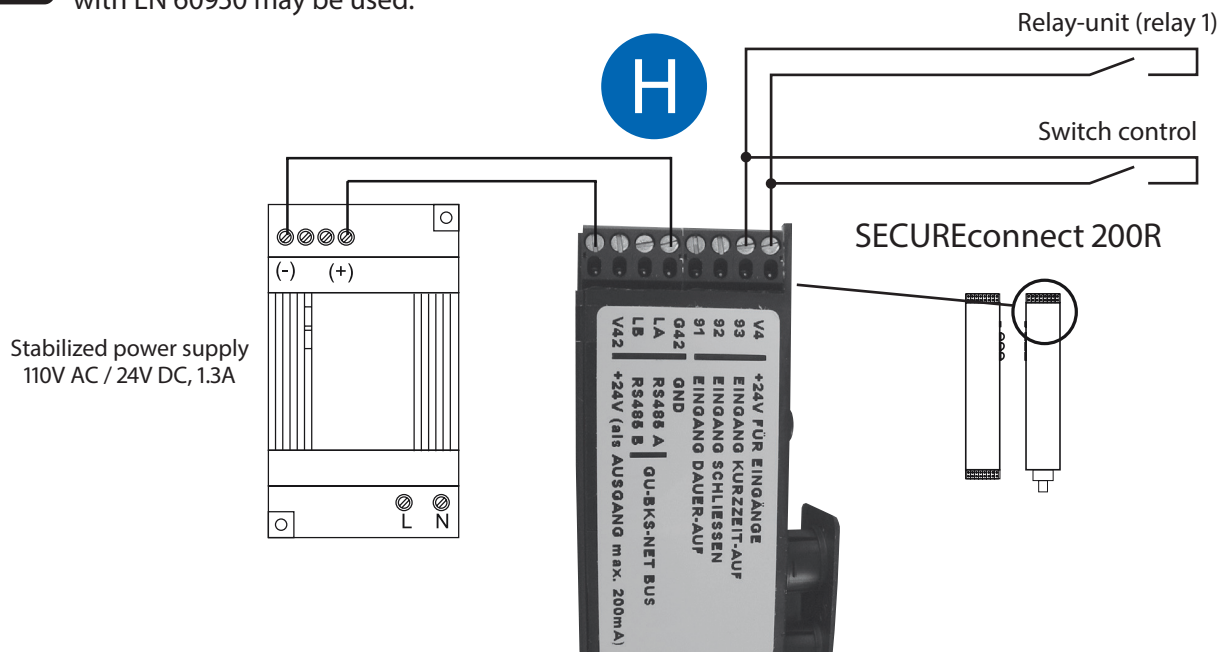

Assembly and Operating Instructions



A-opener, SECUREconnect 200, Fingerprint Scanner or Code Keypad
 – Door Leaf Mounted Connection Diagram



Cable routing of module (leaf-side)

Please use the enclosed system cable to connect the module.
 The SECUREconnect and the access control module communicate via an encoded bus.

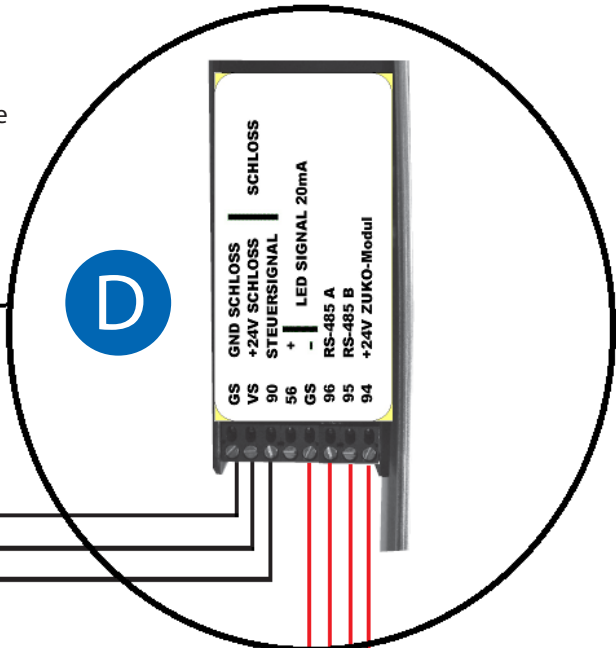
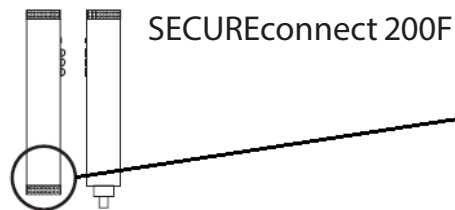

A-opener



Connecting cable	Signal	
Grey (blue)	GND (minus)	GS
Brown	24 V (plus)	VS
Black	Control line	90



Fingerprint scanner or code keypad

Connecting cable	Signal	
Yellow	GND (minus)	GS
White	RS-485 A	96
Green	RS-485 B	95
Brown	24 V (plus)	94

Connection terminals of SECUREconnect 200R (frame-side)

The terminals V42 and G42 are provided for the connection of an external 24V DC voltage supply to operate SECUREconnect 200.



Attention:
 Only 24V DC voltage sources in accordance with EN 60950 may be used.

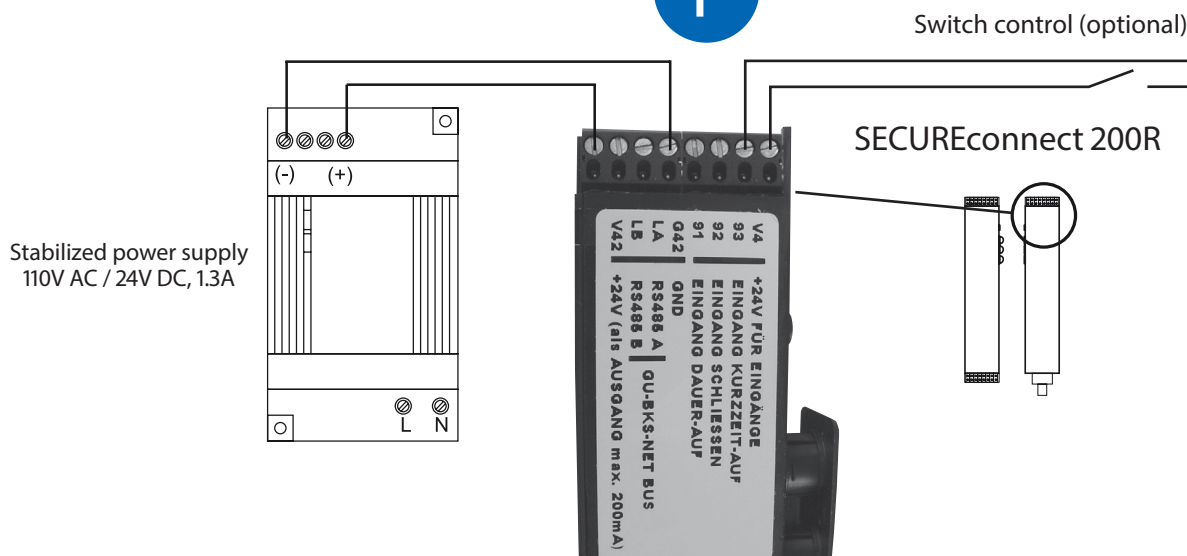

Assembly and Operating Instructions

A-opener, SECUREconnect 200R, Fingerprint Scanner or Code Keypad, Cable Relay -6 – Door Frame Mounted Connection Diagram



With the cable relay, the access control module can be mounted in the door frame. The connection is established on the SECUREconnect frame part.

On the other side of the cable relay is the system cable for connection to the access control module.

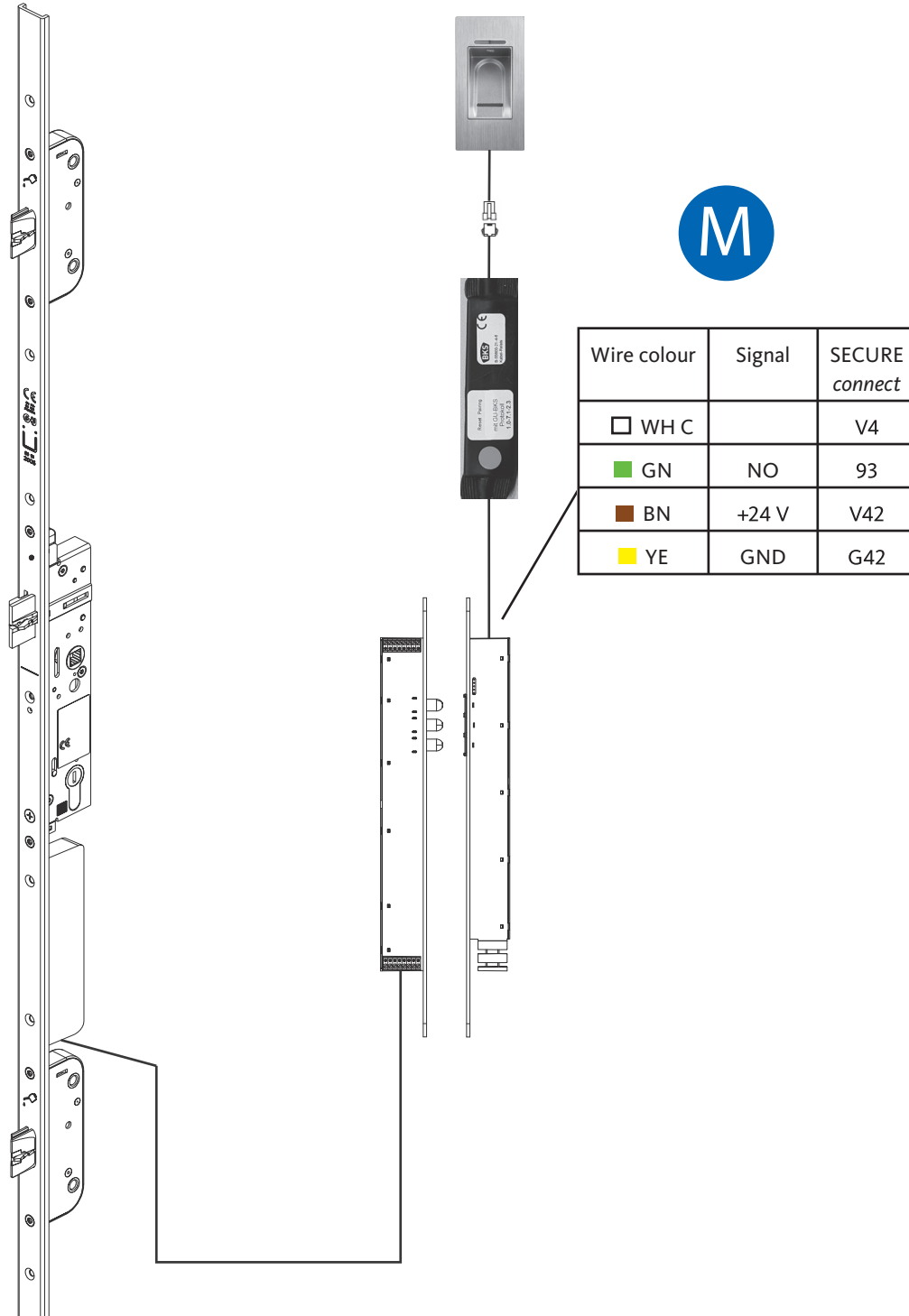

Assembly and Operating Instructions



A-opener, SECUREconnect 200, Fingerprint Scanner or Code Keypad, Relay-unit (white box) – Wall Mounted Connection Diagram



Electrical connection

The inside and outside units communicate via an encoded bus. We recommend you use the telecommunications line J-Y(ST)Y 2x2x0.8 to connect the inside and outside unit

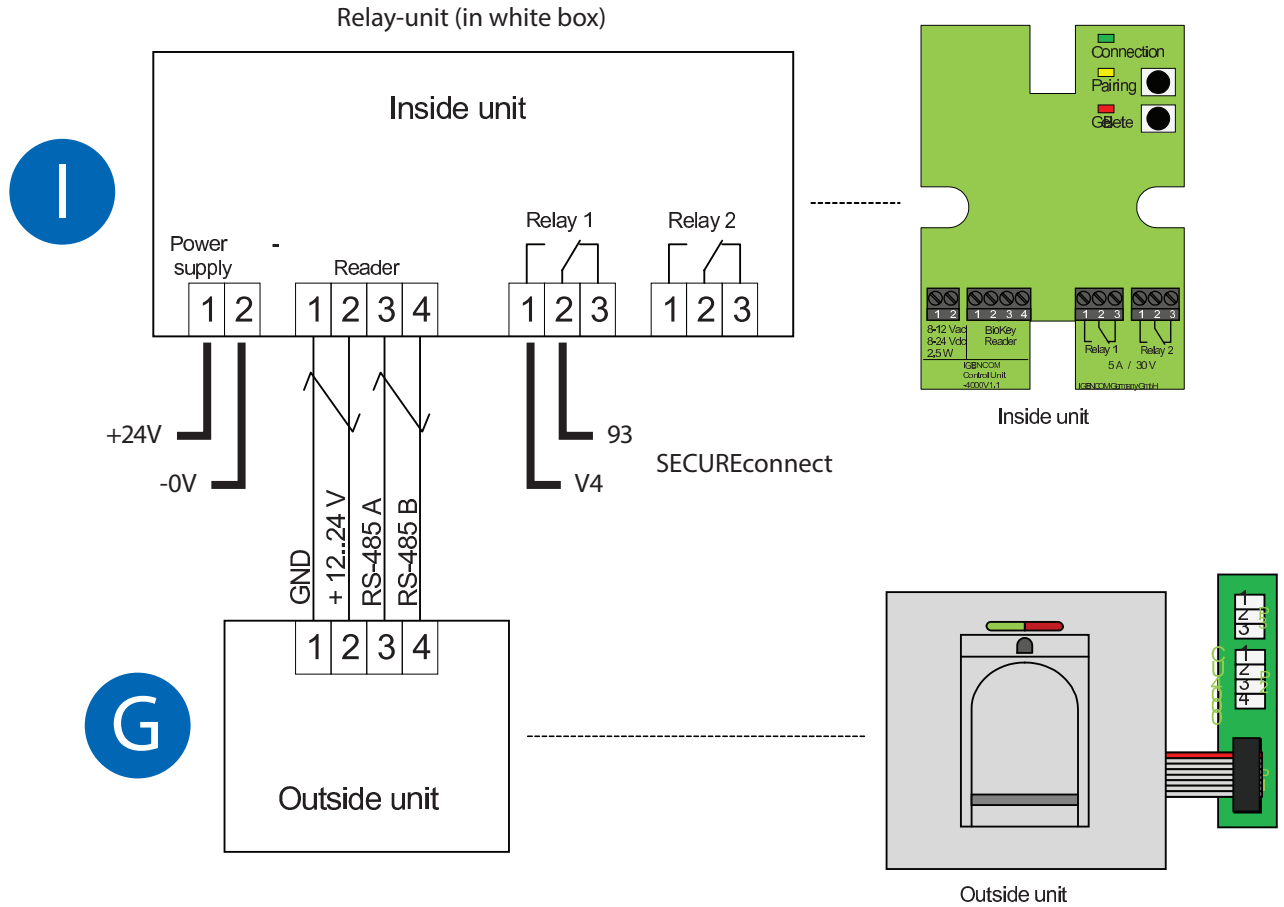

Note: when installing on the wall the flat ribbon cable must be correctly inserted (for orientation: red line, see drawing).



1

Make sure you are using the right power supply: output 24V DC and min. 1.3A

Any difference in voltage may cause malfunction and damage the system!

2

Check wiring according to the correct option of wire diagram. Make sure no component is missing.

3

1. If using a cable relay or a relay unit, try to reset the system by pushing on the pairing button. If still not working go to step 2
2. Press the delete/reset button for 5 seconds. You will need to reprogram the keypad/fingerprint (see operating instructions)

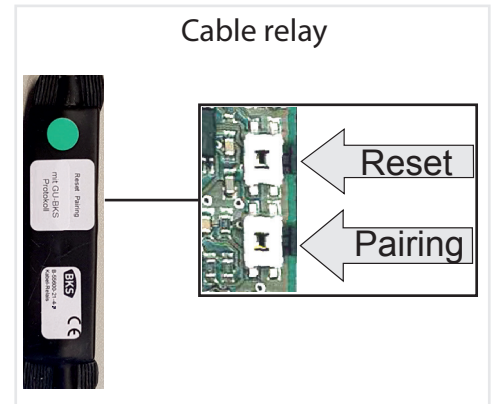

White box (relay unit)

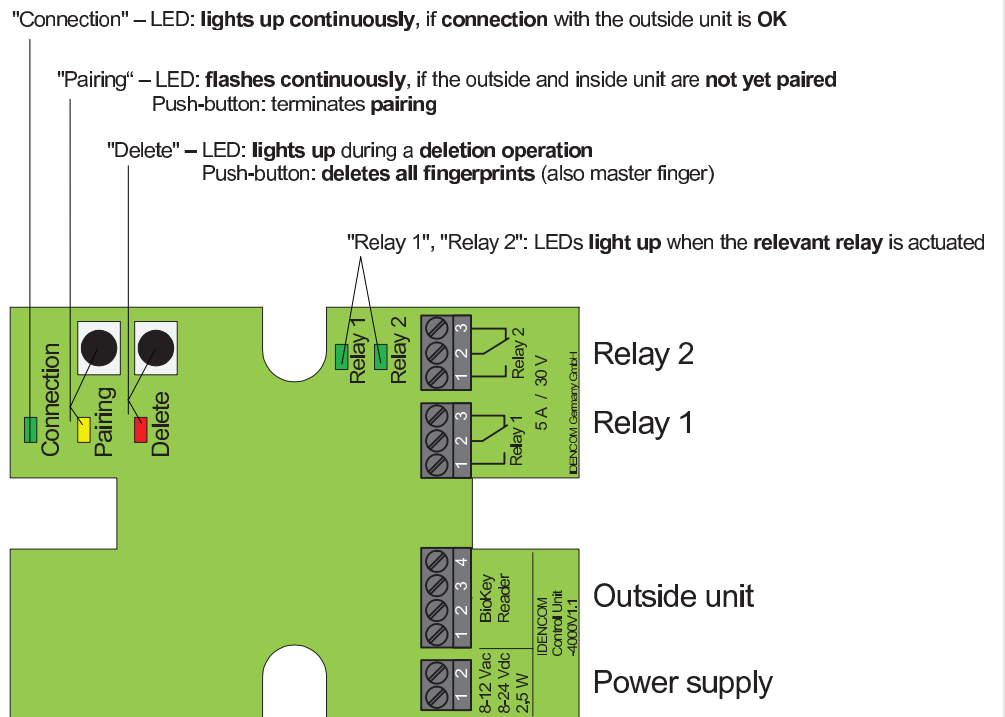



4

If using a SECURE connect 200, follow the steps below to perform a reset of the system:

1. Remove the plastic terminal block next to V4/93/92/91 on SC200R to reveal reset terminals
2. Bridge reset terminals with an alligator clip
3. Turn the power supply off and on again, and leave the alligator clip for 3 seconds before removing it



If still not working, go to step 4

4. Remove the plastic terminal block next to V4/I2/V4/I1 on SC200F to reveal reset terminals
5. Bridge reset terminals with an alligator clip
6. Put the SC200F tappet contacts in connexion with the SC200R
7. Turn the power supply off and on again, and leave the alligator clip for 3 seconds before removing it



* SECURE connect components will flash green/red to indicate a repairing process

