

SIDEWAYS ADJUSTMENT (WIDTH)

FACING LEFT HINGE SIDE SHOWN

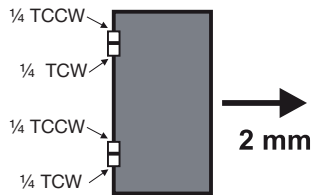

For max adjustment (2 mm) away from hinge :
Loosen set screw A of top knuckle, turn cap (Allen 4 mm) **counter clockwise** 1/4 turn and tighten set screw then loosen set screws B & C of bottom knuckle (2 set screws) turn inner hinge pin (Allen 4 mm) **clockwise** 1/4 turn. Tighten set screws.

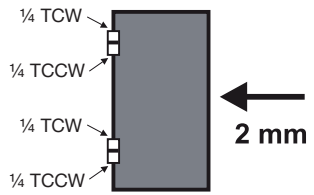

For max adjustment (2 mm) towards hinge :
Loosen set screw A of top knuckle, turn cap (Allen 4 mm) **clockwise** 1/4 turn and tighten set screw then loosen set screws B & C of bottom knuckle (2 set screws) turn inner hinge pin (Allen 4 mm) **counter clockwise** 1/4 turn. Tighten set screws.

Clockwise rotation

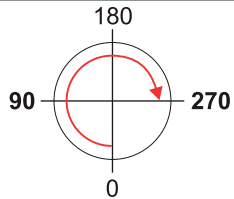

REMARK: For right hung hinges adjustments are opposite of above instructions. Use same setups as shown.

NOTA: clockwise (CW) and counter clockwise (CCW) turns viewed from top

STEPS TO FOLLOW



* Top & bottom knuckles should be aligned before starting



1 Loosen the set screw of top knuckle with 2,5 mm Allen key.



2 Make adjustment on top with 4 mm Allen key.



3 Tighten the set screw with 2,5 mm Allen key.

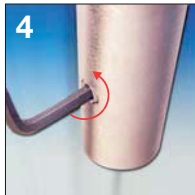

4 Loosen both set screws of bottom knuckle with 2,5 mm Allen key.



5 Make adjustment at bottom with 4 mm Allen key through bottom screw.



6 Tighten both set screws with 2,5 mm Allen key.

Adjustable 3-Way Hinge

> FACING LEFT HINGE SIDE SHOWN

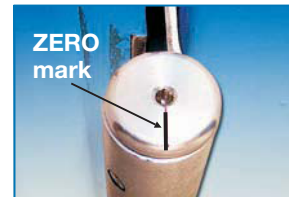
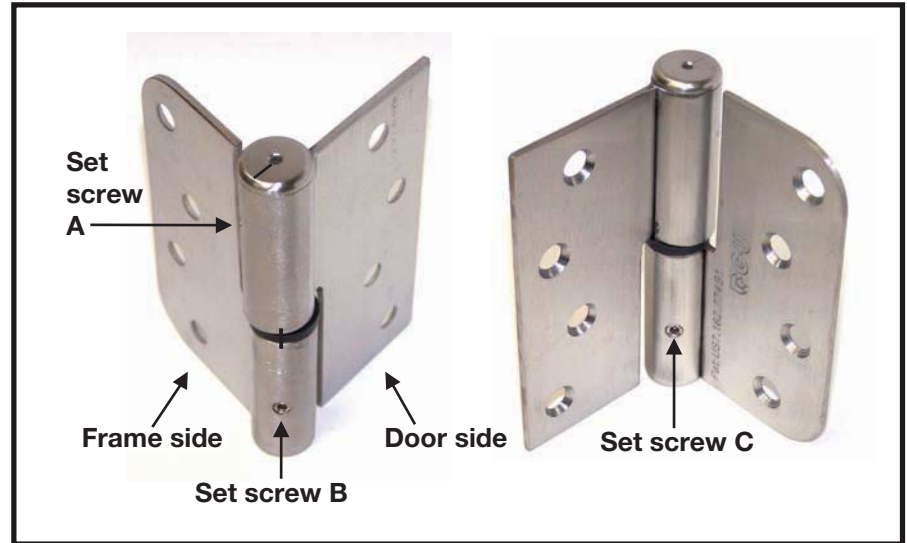

Top view

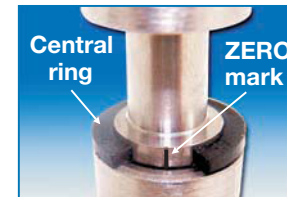

Center view



Bottom view

> UP & DOWN ADJUSTMENT (HEIGHT)

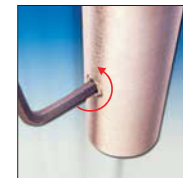
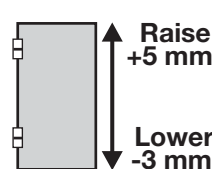

Loosen the set screws on both sides of bottom knuckle with 2,5 mm Allen Key

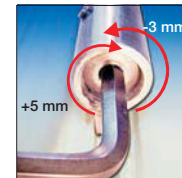

Make adjustment up & down with 5 mm Allen key.
*Clockwise +5 mm
*Counter clockwise -3 mm



Tighten both set screws with 2,5 mm Allen key.

* Change central ring if needed, they are supplied in different thicknesses!