

# Gripset Handle Installation Instructions

for K-C2060/K-C2070

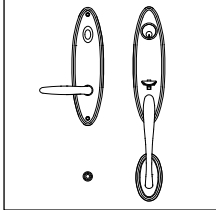

## SALEM (K-C2060)



## BERKELEY (K-C2070)

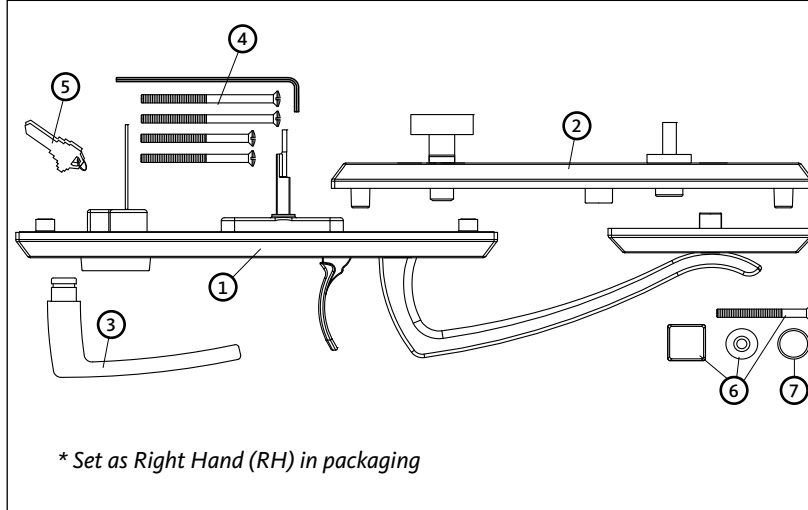
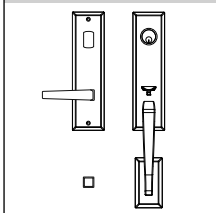

\* Set as Right Hand (RH) in packaging

### Inside the Box

Pos	Description
①	Exterior handle set with gasket and cylinder
②	Interior plate with knob
③	Interior handle
④	Two M5 x 65mm screws (1 3/4" doors), two M5 x 75mm screws (2 1/4" doors), one Allen key
⑤	Set of two keys
⑥	Bottom screw, screw washer, screw cover
⑦	Handle nylon washer ( <b>only supplied with Salem handle</b> )

### HANDLE HANDING (VIEWED FROM OUTSIDE)

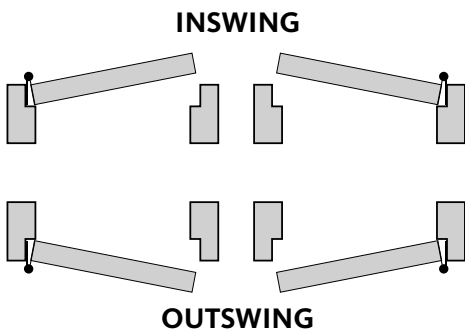
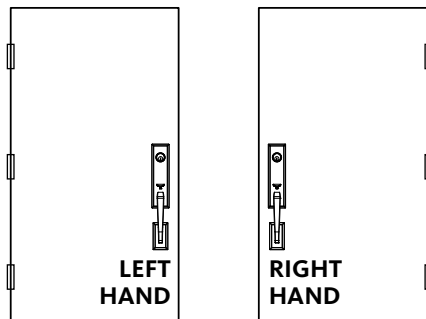

### REVERSING THE UNIVERSAL ACTUATOR (ON THE EXTERIOR PLATE, UNDER THE GASKET)

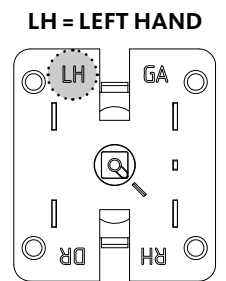
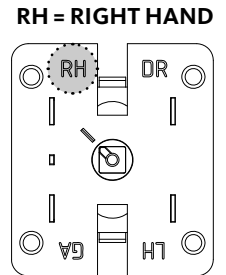
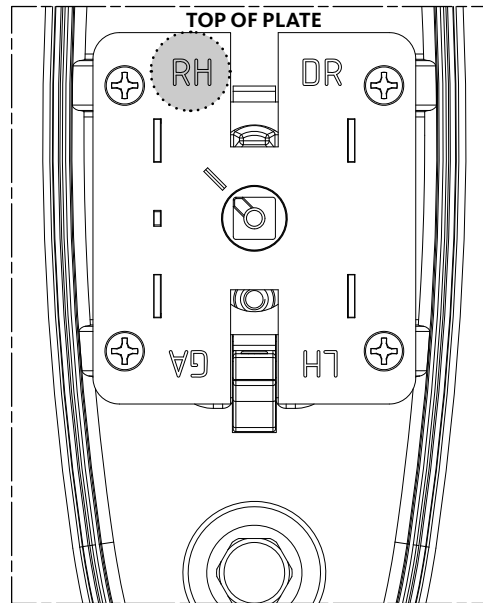

The actuator is set Right Hand (RH) in the box.  
To change handing to Left Hand (LH), take out gasket, remove four screws from actuator and turn actuator 180 degrees to show LH on top. Insert four screws and retighten. Reposition the gasket.

Ferco Architectural Hardware Inc.  
2000, Rue Berlier  
Laval QC H7L 4S4  
T 450.973.1437  
F 450.973.7661  
1.800.355.8810  
www.ferco.ca

Securing technology for you



# Gripset Handle Installation Instructions

for K-C2060/K-C2070

